

PROLINE G2 PLINTH BASE



APPLICATION

PROLINE G2 Plinth Bases install under an enclosure to provide space for cables to enter from below.

FEATURES

- Four access panels for cable management options at the base of the enclosure
- Sturdy cast aluminum corner supports for superior performance under load

SPECIFICATIONS

- Stackable up to 400mm in height using Plinth Base Stacking Kit (not included)
- 100 mm or 200 mm options
- 16-gauge (1.5 mm) steel
- Drill points for locating casters (not included)

- To maintain a NEMA Type 12 environmental rating, gland plate must also be used in the base of the enclosure
- Installation hardware included
- Optional Vented Plinth Base Covers (not included) to allow air to circulate into the enclosure

FINISH

- Polyester powder paint; RAL 9005 textured black standard
- Custom colors available

ACCESSORIES

- Solid Duro-Stand gland plates
- Plinth base stacking kit

BULLETIN: P40

Standard Product 100-mm, For Frame Width Less Than 1200 mm

Catalog Number	Fits Frame W x D	W (mm)	W (in.)	D (mm)	D (in.)
P2BP145	400 x 500	399	15.71	464	18.27
P2BP146	400 x 600	399	15.71	564	22.21
P2BP164	600 x 400	599	23.58	364	14.33
P2BP165	600 x 500	599	23.58	464	18.27
P2BP166	600 x 600	599	23.58	564	22.21
P2BP168	600 x 800	599	23.58	764	30.08
P2BP184	800 x 400	799	31.46	364	14.33
P2BP185	800 x 500	799	31.46	464	18.27
P2BP186	800 x 600	799	31.46	564	22.21
P2BP188	800 x 800	799	31.46	764	30.08
P2BP1104	1000 x 400	999	39.33	364	14.33
P2BP1105	1000 x 500	999	39.33	464	18.27
P2BP1106	1000 x 600	999	39.33	564	22.21
P2BP1108	1000 x 800	999	39.33	764	30.08

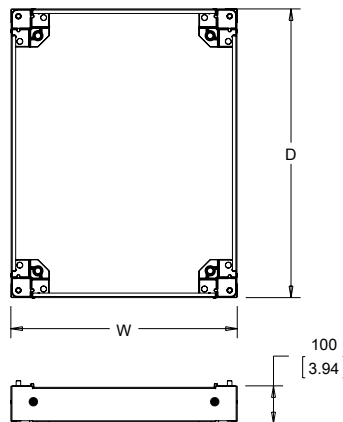

Standard Product 100-mm, For Frame Width 1200 mm and Greater

Catalog Number	Fits Frame W x D	W (mm)	W (in.)	D (mm)	D (in.)
P2BP1124	1200 x 400	1199	47.21	364	14.33
P2BP1125	1200 x 500	1199	47.21	464	18.27

Catalog Number	Fits Frame W x D	W (mm)	W (in.)	D (mm)	D (in.)
P2BP1126	1200 x 600	1199	47.21	564	22.21
P2BP1128	1200 x 800	1199	47.21	764	30.07
P2BP1164	1600 x 400	1599	62.95	364	14.33
P2BP1165	1600 x 500	1599	62.95	464	18.27
P2BP1166	1600 x 600	1599	62.95	564	22.21
P2BP1168	1600 x 800	1599	62.95	764	30.07
P2BP1185	1800 x 500	1799	70.83	464	18.27
P2BP1184	1800 x 400	1799	70.83	364	14.33
P2BP1186	1800 x 600	1799	70.83	564	22.21
P2BP1188	1800 x 800	1799	70.83	764	30.07
P2BP1810	1800 x 1000	1799	70.83	964	37.95

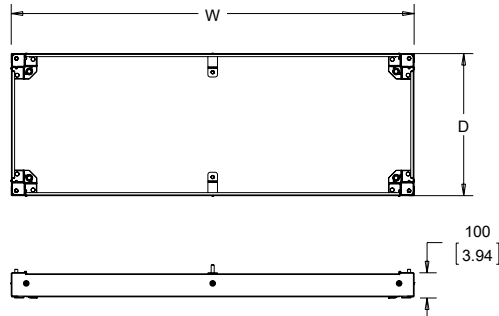

89131514

Standard Product 200-mm, For Frame Width Less Than 1200 mm

Catalog Number	Fits Frame W x D	W (mm)	W (in.)	D (mm)	D (in.)
P2BP245	400 x 500	399	15.71	464	18.27
P2BP246	400 x 600	399	15.71	564	22.21
P2BP264	600 x 400	599	23.58	364	14.33
P2BP265	600 x 500	599	23.58	464	18.27
P2BP266	600 x 600	599	23.58	564	22.21
P2BP284	800 x 400	799	31.46	364	14.33
P2BP268	600x800	599	23.58	764	30.07
P2BP285	800 x 500	799	31.46	464	18.27
P2BP286	800 x 600	799	31.46	564	22.21
P2BP288	800 x 800	799	31.46	764	30.07
P2BP2810	800 x 1000	999	39.33	964	37.95
P2BP2104	1000 x 400	999	39.33	364	14.33
P2BP2105	1000 x 500	999	39.33	464	18.27
P2BP2106	1000 x 600	999	39.33	564	22.21
P2BP2108	1000 x 800	999	39.33	764	30.07

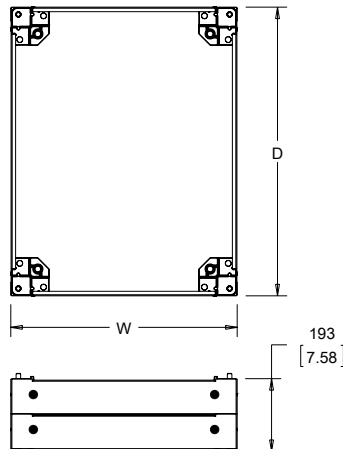

89129494

Standard Product 200-mm, For Frame Width 1200 mm and Greater

Catalog Number	Fits Frame W x D	W (mm)	W (in.)	D (mm)	D (in.)
P2BP2124	1200 x 400	1199	47.21	364	14.33
P2BP2125	1200 x 500	1199	47.21	464	18.27
P2BP2126	1200 x 600	1199	47.21	564	22.21
P2BP2128	1200 x 800	1199	47.21	764	31.08
P2BP2164	1600 x 400	1599	62.95	364	14.33
P2BP2165	1600 x 500	1599	62.95	464	18.27
P2BP2166	1600 x 600	1599	62.95	564	22.21
P2BP2168	1600 x 800	1599	62.95	764	31.08
P2BP2185	1800 x 500	1799	70.83	464	18.27
P2BP2184	1800 x 400	1799	70.83	364	14.33
P2BP2186	1800 x 600	1799	70.83	564	22.21
P2BP2188	1800 x 800	1799	70.83	764	31.08

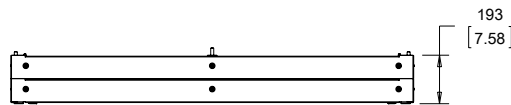
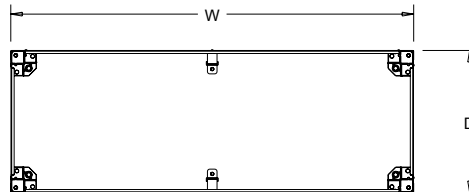

89131515

Model	Component	Type	Width	Depth	Specialty	Catalog Number
P2	B	P1	8	6	Blank	= P2BP186
PROLINE G2	Base	0 = solid base 0mm 1 = fully-sealed plinth P1 = plinth base 100mm P2 = plinth base 200mm GP = gland plate T = transportation base M = mobile base	mm 18 = 1800 16 = 1600 14 = 1400 12 = 1200 10 = 1000 8 = 800 6 = 600 4 = 400	mm 10 = 1000 8 = 800 6 = 600 5 = 500 4 = 400	Blank = standard HF = EMC protected G = Galvanized steel (gland plate only)	

PROLINE G2 PLINTH BASE STACKING KIT



The Plinth Base Stacking Kit is used to stack plinth bases up to 400 mm high. Kit consists of eight bolts and nuts and eight each of two types of washers.

BULLETIN: P40

Standard Product

Catalog Number
P2ABPSK

Notes