

REPLACEMENT OF MECHANICAL PHOTOCONTROLS

“Competitively Priced Twist-lock Photocontrols”

DESCRIPTION

ST7700 Series photocontrols are constructed with cost effective materials and are designed specifically to replace mechanical photocontrols. The **ST7700 Series** can be expected to have better On to Off ratios, a higher level of reliability, and longer life than mechanical designs. **ST7700 Series** photocontrols are not recommended for present users of Sun-Tech **S Series** or **P Series** designs.

FEATURES

- Meets or exceeds ANSI C136.10.
- Heavy Duty Relay.
- Average 3:1 On to Off ratio.
- Non-chatter load break.

BENEFITS

- Industry Standard Operating Levels.
- Extended relay life from non-chatter load break.
- Extended photocell life from low voltage DC.
- Reduced maintenance costs.

MECHANICAL SPECIFICATIONS

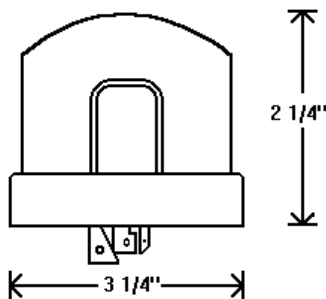

Housing:	UV stabilized, impact resistant polypropylene.
Base:	High temperature ABS.
Contact Blades:	Solid brass, three prong, locking type.
Gasket:	Cross linked polyethylene.
Packaging:	Individual units are sealed in water resistant plastic.
Weight:	3.0 oz. each, 20 lbs. per 100 unit carton.
Size:	16" x 16" x 12" per 100 unit carton.

Warranty: 4 Year 1 for 1 replacement warranty.