

PGH Portable Garage/Shop Heater

FEATURES

- 240 Volt—4000W Utility Heater.
- Built-in thermostat (60-170°) and On/Off rocker switch.
- Power Indicator Light.
- Auto Reset Fan Delay—Increases efficiency.
- Auto Reset Thermal Cutout—Ensures heater shut-off in an unsafe condition.
- 6' Power cord with 20 Amp plug.
- Convenient handle w/built-in cord storage.
- Durable scratch and rust resistant finish.
- Stainless Steel Tubular Heating Element.
- Mounting bracket for wall or ceiling installation included.
- 1-year warranty against manufacturing defects.



The PGH is a high wattage portable heater designed to provide a back-up heating source at an affordable price. Perfectly suited for the workshop, garage or construction sites, the rotation capability. The convenient 6 foot cord allows greater mobility to areas needing heating, while the handle serves as a reel for the cord when not in use. Easily set the desired temperature with the built-in thermostat. Sure stop high-limit temperature control with manual reset provides overheat protection. 1 year warranty.

MODEL	UPC# 093319 PART #	DESCRIPTION
PGH2440TB	20998	4000W, 240V, 1-Phase with Thermostat

Easy Installation

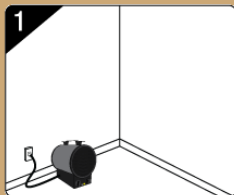

Portable Application

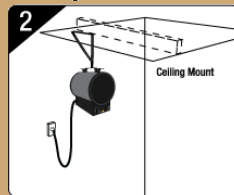

Mount bracket to ceiling joist and attach heater

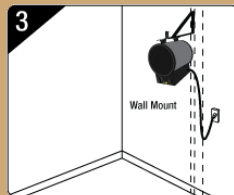

Mount bracket to wall stud and attach heater

SPECIFICATIONS

BTU	13,650
Watts	4000 W
Heating Area (ft2)	450 ft2
Power (Volts)	240V~60Hz
Amps	17A
Heat Settings 1	On/Off
Heat Settings 2	Thermostat

Minimum Clearance From Combustibles

Front	3 ft.
Top	1 ft.
Sides	1 ft.
Rear	1 ft.

