

Terminal Accessories

Table 7.117: Terminal Nuts for Bus Bar Connection of B-, H- and J-Frame Circuit Breakers

Description	Frame	Tap	Cat. No.	Qty Per Kit
B-Frame Terminal Nut Insert-Metric	BD/BG/BJ (2P)	M6	LV426962	2
B-Frame Terminal Nut Insert-Metric	BD/BG/BJ (3P)	M6	LV426963	3
H-Frame Terminal Nut Insert-English	HD/HG/HJ/HL	1/4-20	S37425	2
H-Frame Terminal Nut Insert-English	HD/HG/HJ/HL	1/4-20	S37444	3
H-Frame Terminal Nut Insert-Metric	HD/HG/HJ/HL	M6	S37426	2
J-Frame Terminal Nut Insert-English	JD/JG/JJ/JL	1/4-20	S37427	2
J-Frame Terminal Nut Insert-English	JD/JG/JJ/JL	1/4-20	S37445	3
J-Frame Terminal Nut Insert-Metric	JD/JG/JJ/JL	M8	S37428	2
Control Wire Terminal for H-Frame Terminal Nut	HD/HG/HJ/HL		S37429	2
Control Wire Terminal for J-Frame Terminal Nut	JD/JG/JJ/JL		S37430	2



H-Frame Lug with Terminal Nut Insert

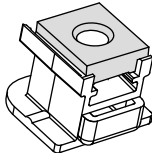

Terminal Nut Insert

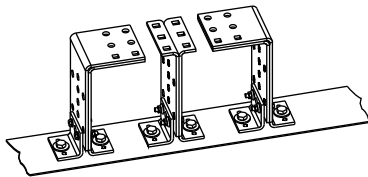

RLTB Terminal Pad Kit

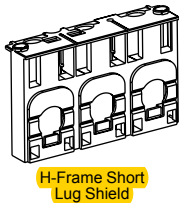

H-Frame Short Lug Shield

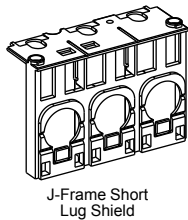

J-Frame Short Lug Shield

Phase barrier or terminal shield extension past end of circuit breaker

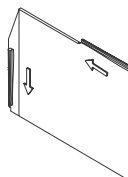

R-Frame Phase Barrier

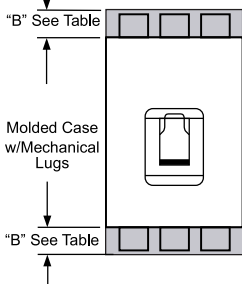

Table 7.118: Bus Bar Connections Hardware for L-, M-, and P-Frame Circuit Breakers

Frame	Description	Term. No.	Poles	Cat. No.
L-Frame	Set of 4 terminal screws and washers for one side	F	4	S36967
M- and P-Frame	Bus Connector Kit for one pole, one end		1	S33928

Table 7.119: Terminal Pad Kits for R-Frame Circuit Breakers

R-Frame Circuit Breaker	Terminal Pad Kit		Field-Installable Kits	
	Usage	Lugs per Phase	3P Kit (One End Only) Cat. No.	4P Kit (One End Only) Cat. No.
3000 A, 100% Rated	Required for cable or bus	9	RL3TB	RL3TB4
3000 A, Standard (80% Rated)	Required for cable or bus	8	RLTB	RLTB4
2500 A, 100% Rated	Required for cable or bus			
2500 A, Standard (80% Rated)	Required for cable, optional for bus			
All Other R-Frame Circuit Breakers	Required for cable, optional for bus			

For cable connection to RLTB, use AL2500RK lug. See page 7-59.

Table 7.120: Terminal Shields and Phase Barriers

Used With	Description			Dimension B (in.)	Cat. No.	Qty Per Kit				
H- and J-Frame Mechanical Lugs	Short Lug Shield ^[31]	Frame	Max. Wire Size	0.50	S37446	1				
		H-Frame 60 A	3 AWG							
		H-Frame 150 A	3/0 AWG							
		J-Frame	350 kcmil							
B-, H- and J-Frame Power Distribution Connectors and Compression Lugs	Compatible with:			1.9	LV426911 (2P) LV426912 (3P) LV426913 (4P)	1				
	PDC	Compression Lugs								
		Aluminum	Copper							
	B-Frame Long Lug Shield	PDC3BD2	LV426988				LV426986			
		PDC6BD6	LV426989				LV426987			
	H-Frame Long Lug Shield	PDC6HD6	YA060HD				CY-A060HD	2.24	S37449	1
		PDC3HD2	YA150HD				CY-A150HD			
	J-Frame Long Lug Shield	PDC6JD4	YA150JD				CYA150JD	1.68	S37450	1
		PDC3JD2	^[32]				CYA250J3			
	L-Frame	3P Short Terminal Shield						LTSS3P	1	
3P Medium Terminal Shield				LTSM3P	1					
3P Long Terminal Shield				LTSL3P	1					
4P Medium Terminal Shield				LTSM4P	1					
4P Long Terminal Shield				LTSL4P	1					
M-, P-Frame	Phase Barriers				S33646	3				
R-Frame	Phase Barriers				S33998					

Table 7.121: Miscellaneous H-, J-, and L-Frame Circuit Breaker Accessories

Accessory	Description	Field-Installable Cat. No.
Spare Parts	Bag of screws for accessory cover, L-frame	S432552
	1 spare toggle extension, L-frame	32595
	Set of 10 identification labels	LV429226

[31] Short lug shields provide IP20 protection for mechanical lugs and are compatible with control wire terminals.

[32] J-frame terminal shield is not compatible with the YA250J35 compression terminal.