



Innovative Lighting Ideas
Energy Efficient Solutions

Series:
ECS Energy Conservation Series

Fixture Type:
ECO EcoLyte

4 Lamp Photometric Data

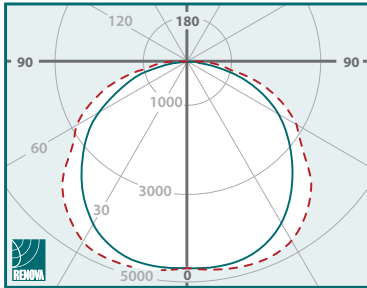

ECS-ECO4-WN-454-UNV-22H-00W

Independent Test Report #: 17540
Total Luminaire Efficiency: 91.3%
Spacing Criterion:

- 0 deg 1.28 - - - 90 deg 1.39
- 180 deg 1.28 - - - 270 deg 1.39

4 Lamp Photometric Data

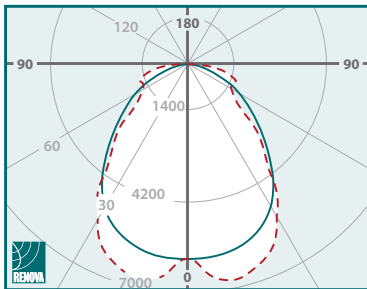

ECS-ECO4-MN-454-UNV-22H-00W

Independent Test Report #: 17539
Total Luminaire Efficiency: 95.0%
Spacing Criterion:

- 0 deg 1.24 - - - 90 deg 1.32
- 180 deg 1.24 - - - 270 deg 1.32

*Please see website for all other photometric data.

4-Lamp T5 HO EcoLyte Cross Section

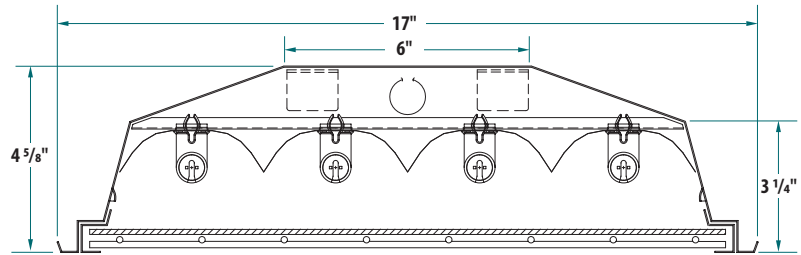

Fixture Housing Dimensions

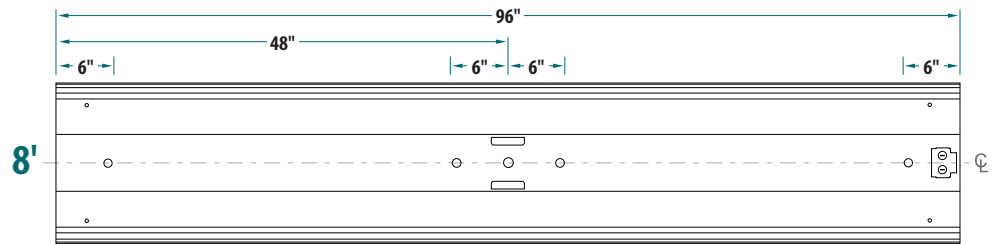
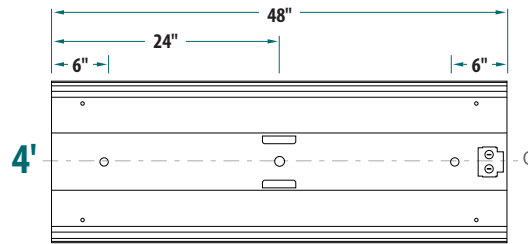

Note: Unless otherwise specified, all EKO's are 7/8" diameter.

Ordering Information

Series	Fixture Type	Size	Reflector Material	Optics (Distribution)	# of Lamps	Lamp Type (Wattage)	Ballast Voltage	# of Ballasts	# Lamps per Ballast	Ballast Factor	Ballast Type	Options
ECS	ECO											
Energy Conservation Series	EcoLyte	4 - 48" 8 - 96"	M - Miro4 (95% TR) W - White (91% TR) C - Custom (Specify)	F - Focused N - Normal S - Spread C - Custom *N - Normal is standard *C - Custom optics are described in "Options" box	2 - 2 Lamp 3 - 3 Lamp 4 - 4 Lamp 5 - 5 Lamp 6 - 6 Lamp 4 - 4 Lamp 6 - 6 Lamp 8 - 8 Lamp 10 - 10 Lamp 12 - 12 Lamp 8" Hsg	32 - (4') 32w T8 54 - (4') 54w T5HO	120 - 120v, 60 Hz 277 - 277v, 60 Hz UNV - 120v-277v, 60 Hz (Multi-Tap) 347 - 347v, 60 Hz 480 - 480v, 60 Hz xxx - Less Ballast *UNV - Universal voltage is standard	1 - 1 2 - 2 3 - 3 4 - 4	1 - 1 2 - 2 3 - 3 4 - 4	L - Low N - Normal H - High	IST - Instant Start RST - Rapid Start LVD - Low Voltage Dimming DIM - Line Voltage Dimming SDM - Step-Dimming	ADDITIONAL OPTIONS <i>(Please see separate "Options Sheet" for all available options)</i>



Fluorescent lamps contain small amounts of mercury. Such lamps are labeled "Contains Mercury" and / or with the symbol "Hg." Lamps that contain mercury must be disposed of in accordance with local requirements. Information regarding lamp recycling and disposal can be found at www.lamprecycle.org.