



# T5 Circular

22W/840 C-T5 1CT

Philips T5 Circular lamps are ultra-slim with improved color rendering, higher efficacy, and longer life. T5 HO circular lamps offer extraordinary light output.

## Product data

### • General Characteristics

Base	2GX13
Bulb	C-T5 [C-T 16 mm]
Rated Avg. Life	12000 hr
Life to 10% fail	8000 hr
Preheat EL,3h	
LSF HF Preheat	1 %
20000h Rated,3h	
LSF HF Preheat	10 %
16000h Rated,3h	
LSF HF Preheat	50 %
12000h Rated,3h	
LSF HF Preheat	89 %
8000h Rated,3h	
LSF HF Preheat	96 %
6000h Rated,3h	
LSF HF Preheat	99 %
4000h Rated,3h	
LSF HF Preheat	99 %
2000h Rated,3h	

### • Light Technical Characteristics

Color Code	841 [CCT of 4100K]
Color Rendering Index	85 Ra8
Color Designation	Cool White
Color Temperature	4100 K
Chromaticity Coordinate X	380 -
Chromaticity Coordinate Y	380 -
Lum Efficacy Rated	82 Lm/W
HF 25°C	
LLMF HF 20000h Rated	72 %

LLMF HF 16000h Rated	74 %
LLMF HF 12000h Rated	77 %
LLMF HF 8000h Rated	81 %
LLMF HF 6000h Rated	84 %
LLMF HF 4000h Rated	87 %
LLMF HF 2000h Rated	91 %
Luminous Flux EL 25°C, Rated	1800 Lm
Luminous Flux EL 25°C, Nominal	1800 Lm
Design Temperature	35 C

### • Electrical Characteristics

Watts	22 W
Lamp Voltage EL 25°C	75 V
Lamp Current EL 25°C	0.300 A
Dimmable	Yes
Lamp Wattage EL 25°C, Rated	22.3 W
Lamp Wattage EL 25°C, Nominal	22 W

### • Environmental Characteristics

Energy Efficiency Label (EEL)	A
Mercury (Hg) Content	2.5 mg

# T5 Circular

## • Measuring Conditions

Calibration Current	0.300 A
HF Generator Rated Voltage	150 V
Resistor	250 ohm

## • Product Dimensions

Diameter D	14 (min), 18 (max) mm
Overall Width E	220 (min), 230 (max) mm
Inner Width I	187 (min), 197 (max) mm

## • Product Data

Product number	166009
Full product name	MASTER TL5 Circular 22W/840 1CT
Short product name	MASTER TL5 Circular 22W/840 1CT/10
Pieces per Sku	1
eop_pck_cfg	10
Skus/Case	10
Bar code on pack	8711500642219
Bar code on case	8711500642226
Logistics code(s)	927965084013
tpd_ilcos_cd	FSCH-22/40/1B-L/P-2GX13-16
eop_net_weight_pp	74.000 gr

## Dimensional drawing

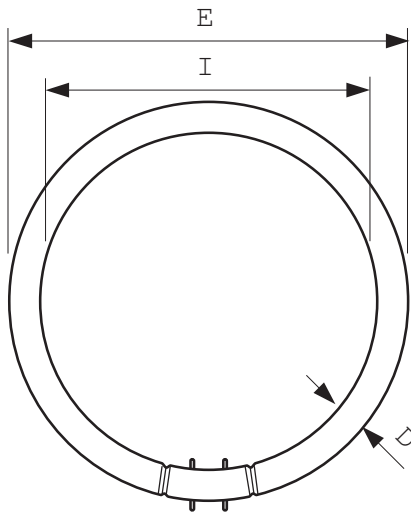

## C-T5, 2GX13

Product	D (Min)	D (Max)	E (Min)	E (Max)	I (Min)	I (Max)
TL5-C 22W/840	14	18	220	230	187	197

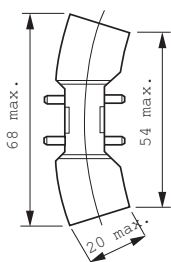

2GX13

## Photometric data

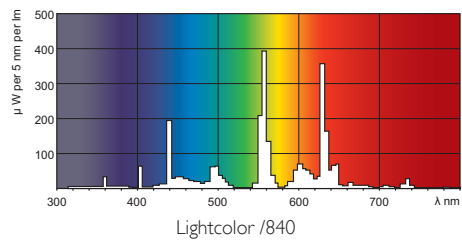
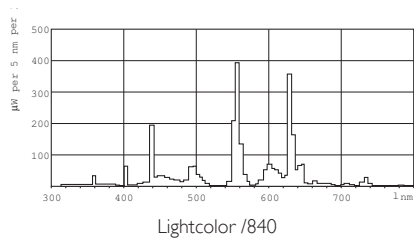

© 2012 Koninklijke Philips Electronics N.V.  
All rights reserved.

Specifications are subject to change without notice. Trademarks are the property of Koninklijke Philips Electronics N.V. or their respective owners.

[www.philips.com/lighting](http://www.philips.com/lighting)

2012, August 4  
data subject to change