

Concrete Slab Electroform Inserts

For Threaded Rigid Conduit & IMC

Type EF & Type EFL

Use:

For conduit installed in poured concrete slabs.

Nail, screw or tack-weld insert to concrete deck form.

Features:

- Inserts available in straight or 90°

Material/Finish:

Malleable Iron/Zinc Plated

Third Party Certification:



UL Listed: E-11853



CSA Certified: 9795

Applicable Third Party Standards:

UL Standard: 514B

CSA Standard: C22.2 No. 18

Fed. Spec: W-F-408E

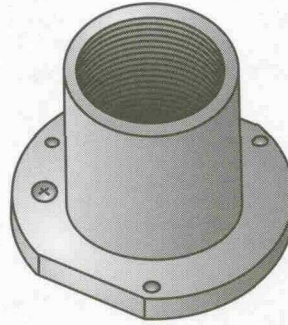

Type EF-50 — Type EF-100
For concrete slab 4" thick and up.

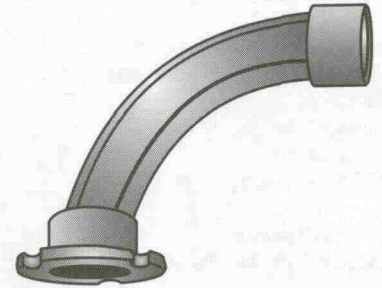

Type EFL-50 — Type EFL-100
For slabs 6" thick and up require
bend conduit sweep.

STRAIGHT CONDUIT INSERTS

Trade Size (inches)	Catalog Number	Dimensions in Inches		
		Base Dia.	Base Across Flats	Height
1/2	EF-50	1 15/16	1 1/4	1 1/16
3/4	EF-75	2 3/16	2	1 1/16
1	EF-100	2 1/2	3 5/16	1 5/8

90° CONDUIT INSERTS

Trade Size (inches)	Catalog Number	Dimensions in Inches			
		Base Dia.	Turning Radius	Base to Conduit Center	Height
1/2	EFL-50	1 15/16	3 3/4	3 3/8	3 3/8
3/4	EFL-75	2 3/16	3 13/16	3 3/8	3 11/16
1	EFL-100	2 1/2	3 13/16	2 15/16	3 11/16

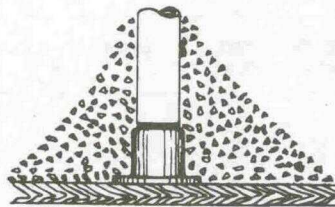

(Wood form shown)

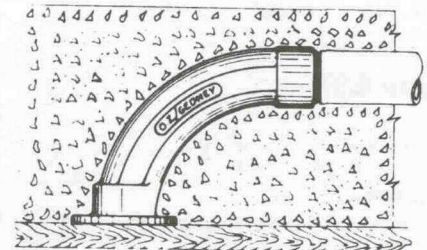

(Wood form shown)

Shown in poured concrete slabs before wood or steel forms are removed.

A UNIT OF GENERAL SIGNAL

O-Z / GEDNEY