

Octagonal Boxes*

Octagonal Boxes are shipped complete with cover, gasket, 4 reducing bushings (3/4" x 1/2") and 4 sealing caps to be installed from inside box to seal off unused entry hubs.



Size (in)	Part Number	Hub Size (in)	Product Code
4 x 1-1/2	OB15/10	1/2 - 3/4	077983*
4 x 2-1/8	OB20	1	077984*

Octagonal Box Extension Rings

Size (in)	Part Number	Product Code
4 x 1 deep	XR20	077989*
4 x 2 deep	XR35	077990*



* Octagonal Boxes are not designed for supporting luminaires.

PVC Molding Junction Boxes

Junction boxes are supplied with threaded brass inserts, brass screws, PVC gasketing and mounting feet. Nylon and stainless steel screws, as well as larger sizes of fabricated junction boxes, are available upon request.



(F = Threaded brass insert size.)

Scepter PVC junction boxes are:

NEMA 1, 2, 3, 4, 4x, 6P, 12, 13
UL listed for wet locations

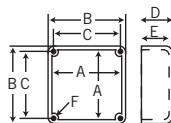

Part Number	Product Code	A (in)	B (in)	C (in)	E (in)	E (in)	F (in)
JB442	077659	3.675	4.000	3.450	2.125	2.000	8-32
JB444	077696	3.675	4.000	3.450	4.188	3.750	8-32
JB446	077669	3.675	4.000	3.450	6.225	6.000	8-32
JB552	077670	4.680	5.000	4.485	2.000	1.845	8-32
JB664	077697	6.000	6.375	5.813	4.188	4.000	10-32
JB666	077698	6.000	6.375	5.813	6.188	6.000	10-32
JB884	077664	8.075	8.625	7.966	4.230	4.005	1/4-20
JB887	077671	8.100	8.625	7.966	7.250	7.035	1/4-20
JB12124	077672	12.085	12.580	11.874	4.256	4.030	1/4-20
JB12126	077666	12.085	12.580	11.874	6.240	6.025	1/4-20
JB12128	077668	12.085	12.580	11.874	8.250	8.025	1/4-20

Flanged Box with Fibre-Reinforced Safety Tread Cover

Scepter's Flanged 'H' Series Junction Boxes provide H10 Highway Loading. The fiber-reinforced safety tread cover secures using recessed Hex Key fastening hardware offering a simple installation while reducing the opportunity for tampering.

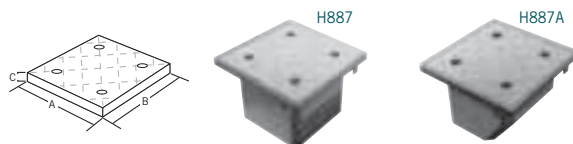

Size (in)	Part Number	Box ID (in)			Lid Dimensions (in)		
		L	W	D	A	B	C
H664	077685	6	6	4-1/4	9.0	9.0	0.60
H666	077686	6	6	6-1/4	9.0	9.0	0.60
H884	077687	8	8	4-1/4	11.5	11.5	0.75
H886	077688	8	8	6-1/4	11.5	11.5	0.75
H887	077689	8	8	7-1/4	11.5	11.5	0.75
H887-A	077692	8	8	7-1/4	11.5	11.5	0.75

Fabricated Boxes

Unflanged PVC fabricated boxes of any size may be made to customers' specifications and come complete with lids, gaskets and screws. These boxes are not CSA Certified and are not returnable.

Junction Box Adapters

Size (in)	Part Number	Product Code
1/2	JBA10	077721
3/4	JBA15	077722
1	JBA20	077723
1-1/4	JBA25	077724
1-1/2	JBA30	077725
2	JBA35	077726
2-1/2	JBA40	077727
3	JBA45	077728
3-1/2	JBA50	077729
4	JBA55	077730

