

Copper Compression Sleeves - Long Barrel

Conductor Range: 1000kcmil-350kcmil



TYPE CTL

Features

- Manufactured from high strength seamless copper tubing
- Electro-tin plated
- Center wire stop
- Chamfered barrel
- Longer barrel
- UL Listed and CSA Certified for 600 volts, 90° C
- Color coded
- Clearly marked with wire size and die index for IlSCO tools, proper number and location of crimps

Benefits

- Provides maximum conductivity and excellent crimping characteristics
- Provides low contact resistance
- Ensures maximum cable insertion
- Provides easy conductor insertion
- Permits maximum number of crimps for heavy duty applications
- Ensures reliability for copper conductors
- Provides visual tooling recommendation for IlSCO or standard industry tools
- Provides easy identification and tooling recommendation

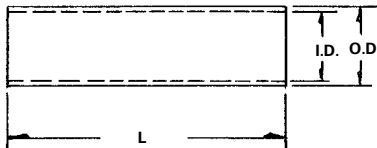

Catalog Number	Wire Size	Wire Range When Installed With IDT-12-N Tool	Welding Cable Size	L	Die Color Code	Die Index	O. D.	I. D.
CTL-350	350kcmil	350kcmil-3/0	-	4-1/8	Red	13	57/64	45/64
CTL-400	400kcmil	400kcmil-4/0	-	4-3/8	Blue	14	15/16	3/4
CTL-500	500kcmil	500kcmil-250kcmil	-	4-5/8	Brown	15	1-1/16	53/64
CTL-600	600kcmil	600kcmil-350kcmil	-	4-5/8	Green	16	1-3/16	59/64
CTL-750	750kcmil	750kcmil-500kcmil	-	5-7/8	Black	17	1-5/16	1-1/32
CTL-1000	1000kcmil	1000kcmil-750kcmil	-	6-1/8	White	18	1-1/2	1-11/64

Tooling Information

Catalog Number	ILSCO						Burdry						Thomas & Betts			Anderson	Color Code
	ILC-12-N ILC-12H-N Die No. No. of Crimps	ILCB-12-N Die No. No. of Crimps	ILC-15H Die No. No. of Crimps	IDT-12-N Dieless No. of Crimps	IDTB-6 Dieless No. of Crimps	IDT-6, IDT-6H 6.2 Ton Dieless No. of Crimps	Y-35 Y-39 Die Index No. of Crimps	Y-45 Die Index No. of Crimps	Y-46 Die Index No. of Crimps	Y-48B Die Index No. of Crimps	MY29-3 Hand Dieless No. of Crimps	Y644M Dieless No. of Crimps	Y642 1 Ton Die Index No. of Crimps	TBM 15 15 Ton Die Index No. of Crimps	21940 40 Ton Die Index No. of Crimps	TBM-8 Hand Tool No. of Crimps	
CTL-350	ILD-13 (1)	ILD-13 (1)	ILD-13 (1)	- (1)	- (2)	- (2)	18/324 (2)	18/324 (2)	18/324 (2)	18/324 (2)	- (2)	71H (4)	71H (4)	71 (2)	- (5)	- (2)	Red
CTL-400	ILD-14 (1)	ILD-14 (1)	ILD-14 (1)	- (1)	- (2)	- (2)	19/470 (2)	19/470 (2)	19/470 (2)	19/470 (2)	- (2)	76H (4)	76 (2)	76 (2)	- (5)	- (2)	Blue
CTL-500*	ILD-15 (1)	ILD-15 (1)	ILD-15 (1)	- (1)	- (2)	- (2)	20/299 (3)	20/299 (3)	20/299 (3)	20/299 (2)	- (2)	87H (4)	87H (4)	87 (2)	- (5)	- (2)	Brown
CTL-600*	ILD-16 (1)	ILD-16 (1)	ILD-16 (1)	- (1)	- (3)	- (3)	22/472 (3)	22/472 (3)	22/472 (3)	22/472 (3)	- (2)	94H (6)	94H (6)	94 (3)	- (2)	- (2)	Green
CTL-750*	ILD-17 (3)	ILD-17 (3)	ILD-17 (3)	- (1)	- (3)	- (3)	24/473 (4)	24/473 (4)	24/473 (4)	24/473 (4)	- (2)	106H (6)	106 (3)	106 (3)	- (2)	- (2)	Black
CTL-1000*	-	-	(2)	(1)	-	-	-	-	27 (3)	-	(2)	-	125H (6)	125 (3)	-	-	White

UL Listed and CSA Certified 600 volts maximum when installed with tools and dies shown above. If proper high voltage spacings and insulation techniques are used, these compression connectors can be used for high voltage applications up to 35KV.

* ILC-12H, ILC-12H-N and ILCB-12-N for use through 400kcmil only.

See stuffer sheet for complete information on tooling.

Tested to UL 486A-486B, UL File E6207

