

**A**

### TYPE CTL

#### Features

- Manufactured from high strength seamless copper tubing
- Electro-tin plated
- Center wire stop
- Chamfered barrel
- Longer barrel
- UL Listed and CSA Certified for 600 volts, 90° C
- Color coded
- Clearly marked with wire size and die index for IlSCO tools, proper number and location of crimps

#### Benefits

- Provides maximum conductivity and excellent crimping characteristics
- Provides low contact resistance
- Ensures maximum cable insertion
- Provides easy conductor insertion
- Permits maximum number of crimps for heavy duty applications
- Ensures reliability for copper conductors
- Provides visual tooling recommendation for IlSCO or standard industry tools
- Provides easy identification and tooling recommendation

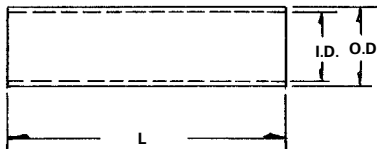

Catalog Number	Wire Size	Wire Range When Installed With IDT-12-N Tool	Welding Cable Size	L	Die Color Code	Die Index	O. D.	I. D.
CTL-1/0	1/0	1/0-6	No. 1 Weld	2-7/8	Pink	5	33/64	25/64
CTL-2/0	2/0	2/0-4	1/0 Weld	3-1/8	Black	6	9/16	7/16
CTL-3/0	3/0	3/0-2	2/0 Weld	3-1/8	Orange	9	39/64	31/64
CTL-4/0	4/0	4/0-1	3/0 Weld	3-3/8	Purple	10	11/16	35/64
CTL-250	250kcmil	250kcmil-1/0	4/0 Weld	3-3/8	Yellow	11	3/4	19/32
CTL-300	300kcmil	300kcmil-2/0	-	4-1/8	White	12	13/16	21/32

CONTINUED ON NEXT PAGE.

## Tooling Information

Catalog Number	ILSCO										Burdly				Thomas & Betts				Anderson	Color Code
	ILC-12-N Die No. No. of Crimps	ILCB-12-N Die No. No. of Crimps	ILC-15H Die No. No. of Crimps	MT-25 Hand No. of Crimps	94285 Left Die No. of Crimps	IDT-12-N Dieless No. of Crimps	ILC-10-N Die No. No. of Crimps	IDTB-6 Dieless No. of Crimps	IDT-6, IDT-6H 6.2 Ton Dieless No. of Crimps	-35 -39 Die Index No. of Crimps	Y-45 Die Index No. of Crimps	Y-46 Die Index No. of Crimps	Y-48B Die Index No. of Crimps	MY29-3 Hand No. of Crimps	Y644M Dieless No. of Crimps	1642 1 Ton Die Index No. of Crimps	TBM 15 15 Ton Die Index No. of Crimps	21940 40 Ton Die Index No. of Crimps	TBM-8 Hand No. of Crimps	
CTL-1/0	ILD-5 (2)	ILD-5 (2)	ILD-5 (2)	- (2)	E/A (3)	- (1)	Pink (4)	- (1)	- (1)	2/348 (2)	12/348 (2)	12/348 (2)	- (3)	- (2)	4 (3)	42-H (6)	42 (3)	- (4)	- (2)	Pink
CTL-2/0	ILD-6 (2)	ILD-6 (2)	ILD-6 (2)	- (2)	E/A (3)	- (1)	- (2)	- (2)	- (2)	3 (2)	13 (2)	13 (2)	- (3)	- (2)	4 (3)	45 (3)	45 (3)	- (4)	- (2)	Black
CTL-3/0	ILD-9 (2)	ILD-9 (2)	ILD-9 (2)	- (2)	A/C (3)	- (1)	- (2)	- (2)	- (2)	14/101 (2)	14/101 (2)	14/101 (2)	- (3)	- (2)	50 (3)	50 (3)	50 (3)	- (4)	- (2)	Orange
CTL-4/0	ILD-10 (1)	ILD-10 (1)	ILD-10 (1)	- (2)	A/B (3)	- (1)	- (2)	- (2)	- (2)	5 (2)	15 (2)	15 (2)	- (3)	- (2)	54 (3)	54-H (6)	54 (3)	- (5)	- (2)	Purple
CTL-250	ILD-11 (2)	ILD-11 (2)	ILD-11 (2)	- (2)	A/A (3)	- (1)	- (2)	- (2)	- (2)	6 (2)	16 (2)	16 (2)	- (3)	- (2)	62 (3)	62 (3)	62 (3)	- (5)	- (2)	Yellow
CTL-300	ILD-12 (1)	ILD-12 (1)	ILD-12 (1)	- (1)	- (1)	- (1)	- (2)	- (2)	- (2)	7/298 (2)	17/298 (2)	17/298 (2)	17/298 (2)	- (2)	66-H (4)	66 (2)	66 (2)	- (5)	- (2)	White

UL Listed and CSA Certified 600 volts maximum when installed with tools and dies shown above. If proper high voltage spacings and insulation techniques are used, these compression connectors can be used for high voltage applications up to 35KV.

See stuffer sheet for complete information on tooling.

Tested to UL 486A-486B, UL File E6207