



# Wallplates

## Weatherproof Covers for Receptacles and Switches

Vertical, for FS/FD box mounting

**IP44**  
SUITABILITY

### For Receptacles with Face Diameters of 1.36–1.39 in. (34.5–35.3)

Description	Catalog Number
Thermoplastic, WET LOCATIONS with cover "open," gray.	HBL7423WO
Thermoplastic, WET LOCATIONS with cover "open," yellow.	HBL74CM23WO
Cast aluminum, WET LOCATIONS with cover "closed."	HBL7420
Cast aluminum, no lift cover, NOT weatherproof.	HBL7320



HBL7423WO

### For Switches & Receptacles with Face Diameters of 1.55–1.58 in. (39.4–40.1)

Description	Catalog Number
Thermoplastic, WET LOCATIONS with cover "open," gray.	HBL7425WOA
Thermoplastic, WET LOCATIONS with cover "open," yellow.	HBL74CM25WOA
Thermoplastic, WET LOCATIONS with cover "open," white.	HBL74CM25WOAW
Cast aluminum, WET LOCATIONS with cover "closed."	HBL7420*
Cast aluminum, no lift cover, NOT weatherproof.	HBL7320
Thermoplastic, WET LOCATIONS with cover "open," gray.	HBL7428WOG†
Thermoplastic, WET LOCATIONS with cover "open," yellow.	HBL7428WOY†
Thermoplastic, WET LOCATIONS with cover "open," red.	HBL7428WOR†



HBL7425WOA

### For Receptacles with Face Diameters of 1.68–1.72 in. (42.7–43.7)

Description	Catalog Number
Thermoplastic, WET LOCATIONS with cover "open," gray.	HBL7424WO
Thermoplastic, WET LOCATIONS with cover "open," yellow.	HBL74CM24WO
Cast aluminum, WET LOCATIONS with cover "closed."	HBL3393
Cast aluminum, no lift cover, NOT weatherproof.	HBL3394



HBL7420

Note: \* Cast aluminum lift cover with fibershield for standard toggle and PresSwitch® Switches.  
 † Features two #6-32 threaded inserts to back mount device to cover.  
 All weatherproof lift cover plates on this page are listed by Underwriters Laboratories, Inc. as "WDL Closed" for use in wet locations with cover closed and in damp locations.

### Weatherproof Covers for Single Receptacles on FS/FD Boxes

Note: All weatherproof plates are UL Listed for WET LOCATIONS WITH COVER CLOSED for intermittent use in wet locations or use in damp locations. Those with suffix "WO" are listed for WET LOCATIONS with cover open in continuous use. All plates are gasketed and self-closing.



HBL7320

### 2011 National Electrical Code (NEC®)

#### 406.9 Receptacles in Damp or Wet Locations.

**(A) Damp Locations.** A receptacle installed outdoors in a location protected from the weather or in other damp locations shall have an enclosure for the receptacle that is weatherproof when the receptacle is covered (attachment plug cap not inserted and receptacle covers closed). An installation suitable for wet locations shall also be considered suitable for damp locations. A receptacle shall be considered to be in a location protected from the weather where located under roofed open porches, canopies, marquees, and the like, and will not be subjected to a beating rain or water runoff. All 15- and 20-ampere, 125- and 250-volt nonlocking receptacles shall be listed weather-resistant type. FPN: The types of receptacles covered by this requirement are identified as 5-15, 5-20, 6-15 and 6-20 in ANSI/NEMA WD 6-2002, National Electrical Manufacturers Association Standard for Dimensions of Attachment Plugs and Receptacles.

**(B) Wet Locations.** 15- and 20-ampere, 125- and 250-volt receptacles installed in a wet location shall have an enclosure that is weatherproof whether or not the attachment plug cap is inserted. For other one- or two-family dwellings, an outlet box hood installed for this purpose shall be listed, and where installed on an enclosure supported from grade as described in 314.23(B) or as described in 314.23(F) shall be identified as "extra-duty." All 15- and 20-ampere, 125- and 250-volt nonlocking-type receptacles shall be listed weather-resistant type.

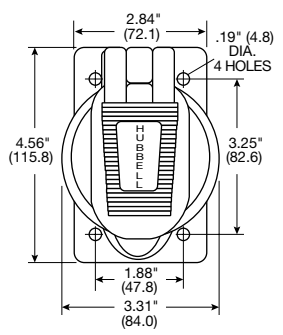

Typical Plate, 1-Gang



HBL7424WO



HBL3393

NEC® is a registered trademark of the The National Electrical Code.

