

MISCELLANEOUS FITTINGS

DIE CAST ZINC - OFFSET NIPPLES



Application

- For use when connecting two boxes or panels when the knock-outs are not in line.

Product Feature

- Rugged metallic construction provides mechanical protection for the conductors.

Compliance

-  – Standard 514B
-  – C22.2 #18



3/4" Offset Nipples
Die Cast Zinc

RACO COMMERCIAL
FITTINGS

ORDERING INFORMATION - DIMENSIONS

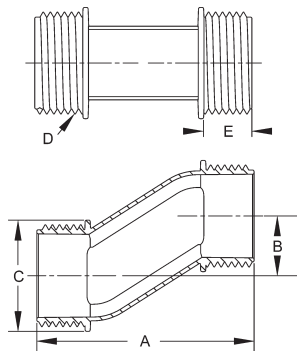

- A = Overall length
- B = Offset
- C = Hub dia.
- D = Thread spec
- E = Thread length

3/4" OFFSET NIPPLES - DIE CAST ZINC

CATALOG NUMBER	TRADE SIZE	UNIT CTN. QTY.	SHIP CTN. QTY.	UPC BAR CODE
1452	1/2"	—	50	—
1453	3/4"	—	20	—
1454	1"	—	15	—
1455	1-1/4"	—	10	—
1456	1-1/2"	—	10	—
1458	2"	—	6	—

DIMENSIONS

CATALOG NUMBER	A	B	C	D	E
1452	2-27/64"	3/4"	15/16"	1/2" - 14 NPSM	7/16"
1453	2-13/32"	3/4"	1-3/16"	3/4" - 14 NPSM	7/16"
1454	2-23/32"	3/4"	1-25/64"	1" - 11/12 NPSM	39/64"
1455	2-13/16"	3/4"	1-13/16"	1-1/4" - 11-1/2 NPSM	19/32"
1456	3-1/32"	3/4"	2-1/16"	1-1/2" - 11-1/2 NPSM	11/16"
1458	3-5/32"	3/4"	2-9/16"	2" - 11-1/2 NPSM	3/4"