

XP
SERIES

GENERAC[®]

XP SERIES PORTABLE GENERATORS



Professional-grade for demanding job sites

XP SERIES GENERATORS 4000 – 10000 WATTS

The undisputed workhorse of the portable market, Generac's professional grade XP Series portable generators are engineered specifically with contractors in mind. All models are powered by the Generac OHVI® engine, built to withstand extended job site use.



Fold-down, Locking Handles
Provide sturdy portability, fold down for compact storage, factory installed

Integrated Lifting Eye
For easier transportation and added security on jobsites

Large Steel Fuel Tank with Integrated Fuel Gauge
For extended run time and easy fuel tracking

Hardened 1.25" Steel Tube Cradle and Cast Metal Corners
For rugged durability

Easy-to-access Maintenance Points
Makes routine maintenance easier and quicker

Never-flat Wheels
For mobility on any terrain

TRUEPOWER™ TECHNOLOGY

Delivers best-in-class power quality for confident operation of power tools, computers and more. With less than 5% total harmonic distortion, you're assured of quality and performance as smooth and consistent as utility power.



GENERAC OHVI® ENGINE

Power for Extended Performance

All models feature Generac's OHVI engine, which utilizes the same type of pressurized oil lubrication used to give automobile engines long

and trouble free lives and has a significantly longer life than many competitive engines – an unprecedented three to four times longer.



WHAT'S INCLUDED

- **3 year limited warranty**
- Wheel Kit & Handles
(Sold Separately on XP4000)
- Engine Oil Supply
- Owner's Manual
- Maintenance Kit

Easy access all-in-one control panel

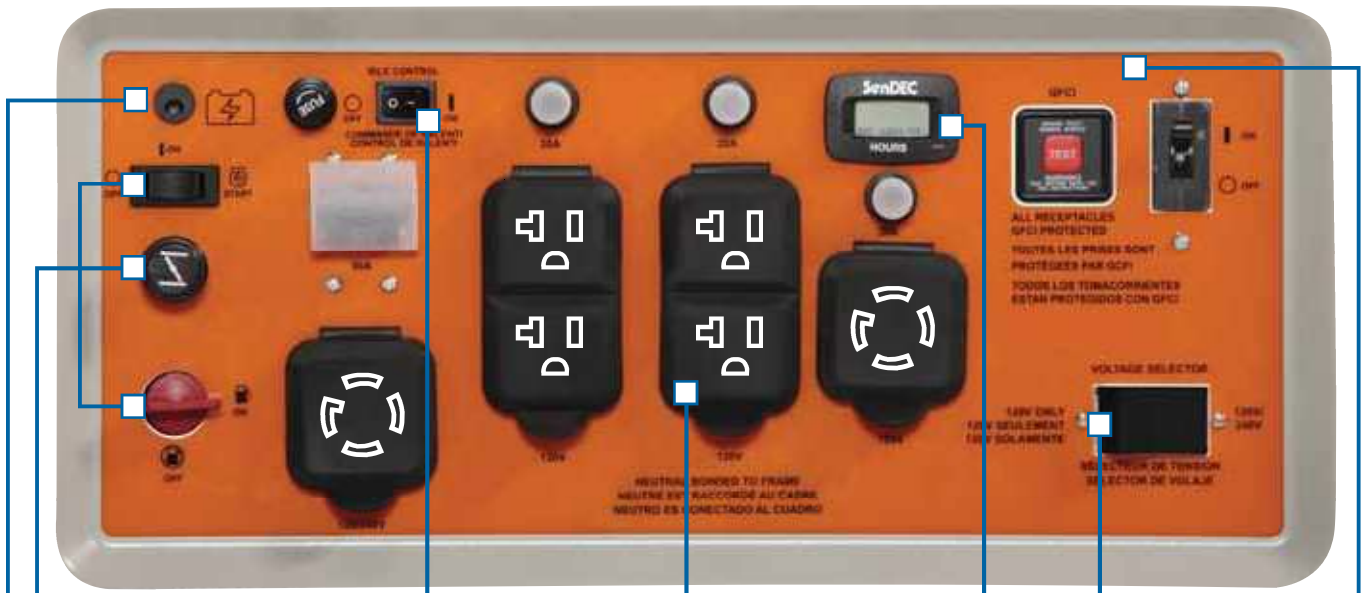

On/Off Switch, Choke, Fuel Shut Off

Battery Charging Jack
To keep the battery charged and ready

Idle Control
Conserves fuel and reduces noise

GFCI Protected Covered Outlets

Hour Meter
With maintenance resets

120/240 Voltage Selector
Allows full 120V power or 120/240V power output (XP4000 & XP6500E models)

Full Panel GFCI Protection
OSHA compliant

What will it power?

How do you determine what size generator you need?

Sizing a portable generator is relatively easy. Check out this example:

- 1** Choose which devices you want to power at the same time.
- 2** Record and add the running watts listed for each device that you need to power.
- 3** Record the additional starting watt requirements for each device.
- 4** Add the starting watts for the highest starting watt device plus the total running watts to determine the total wattage requirement.

Consult the specifications on the back page to find the correct generator for your needs.

Device	Running Watts	Additional Starting Watts
Paint Sprayer	600	1200
Halogen Light	1000	0
Belt Sander	1200	2400
Air Compressor - 1/2 HP	1000	2000
Total	3800	+ 2400 =

To power all chosen devices at once, a minimum of **6200 watts** are needed

In this example you would need at least an XP6500E to power and start all of these devices at one time because an XP6500 provides 6500 running watts and 8125 starting watts.

	Device	Running Watts	Additional Starting Watts
Jobsite	Air Compressor - 1 HP	1600	4500
	Air Compressor - 1/2 HP	1000	2000
	Airless Paint Sprayer- 1/3 HP	600	1200
	Belt Sander - 3"	1200	2400
	Bench Grinder - 8"	1400	1100
	Circular Saw - 7-1/4"	1400	2300
	Hand Drill - 1/2"	600	900
	Hand Drill - 3/8"	400	600
	Miter Saw - 10"	1800	1800
	Quartz Halogen Work Light	1000	0
	Reciprocating Saw	960	0
	Table Saw, 10"	2000	2000
	Electric Hedge Trimmer	400	0
	Electric Line Trimmer - 9"	350	0
Household	Electric Chain Saw - 12" (1/2HP)	900	0
	Computer with a 17" Monitor	800	0
	Microwave - 1000 Watts	1000	0
	Refrigerator/Freezer	700	2200
	Sump Pump 1/2 HP	1050	2150
	Television - 27"	500	0
	Well Pump - 1/2 HP	1000	2100
	Central AC - 24,000 BTU	3800	4950
	Furnace Fan Blower - 1/2 HP	875	2300
	Heat Pump	4700	4500
Recreation	Space Heater	1800	0
	Window AC - 12,000 BTU	3250	3950
	AM/FM Radio	100	0
	CD / DVD Player	100	0
	Cell Phone Battery Charger	25	0
	Inflator Pump	50	150
RV Air Conditioner (13,500 BTU)	1500	700	

*Watts listed are approximate. Check your appliance for actual requirements. Total wattage requirements assumes intermittent starting of devices.

Portable Generator Specifications

Series	XP4000	XP6500E	XP8000E	XP10000E
49-State / CSA Model #	5929	5930	5931	5932
CARB Model #	5933	5934	5935	N/A
Running Watts	3600	6500	8000	10000
Starting Watts	4500	8125	10000	12000
Engine Displacement	220cc	410cc	410cc	530cc
Engine Type	Generac OHVI	Generac OHVI	Generac OHVI	Generac OHVI
Starting Method	Manual	Electric/Manual	Electric/Manual	Electric
Battery Included	NA	Yes	Yes	Yes
Pressure Lube with Filter	Yes	Yes	Yes	Yes
Low Oil Pressure Shutdown	Yes	Yes	Yes	Yes
Fuel Tank	Steel, 4.7 Gal.	Steel, 9.0 Gal.	Steel, 9.0 Gal.	Steel, 9.2 Gal.
Run Time at 50% Load	9.5 Hours	11 Hours	10 Hours	9 Hours
Full-Panel GFCI Protection - OSHA Compliant	Yes	Yes	Yes	Yes
Idle Control	Yes	Yes	Yes	Yes
Total Harmonic Distortion	< 5%	< 5%	< 5%	< 5%
120/240V Selector Switch	Yes	Yes	N/A	N/A
GFCI Protected Outlets	(4) 5-20R 120V (1) L5-30R 120V Twist-Lock (1) L14-30R 120/240V Twist-Lock	(4) 5-20R 120V (1) L5-30R 120V Twist-Lock (1) L14-30R 120/240V Twist-Lock	(4) 5-20R 120V (1) L5-30R 120V Twist-Lock (1) L14-30R 120/240V Twist-Lock	(4) 5-20R 120V (1) L5-30R 120V Twist-Lock (1) L14-30R 120/240V Twist-Lock (1) 14-50R 120/240V
Single-Point Lifting Eye	Included	Included	Included	Included
Handle Style	Folding/Locking (Accessory)	Folding/Locking	Folding/Locking	Folding/Locking
Wheel type	10" Semi-Solid Wheels (Accessory)	10" Semi-Solid Wheels	10" Semi-Solid Wheels	10" Solid Wheels
Maintenance Kit	Included	Included	Included	Included
Dimensions (L" x W" x H")	30.5 x 18.5 x 23.5 (Without wheel or handle kit)	34.5 x 29 x 27.5	34.5 x 29 x 27.5	34.5 x 29 x 34
Product Weight (Pounds)	139	241	251	281
Warranty - Residential/Commercial	3 Year Ltd.	3 Year Ltd.	3 Year Ltd.	3 Year Ltd.
Availability	Q1 2011	Q1 2011	Q1 2011	Q1 2011

All portable specifications and models subject to change. Please consult factory for availability.

HOME STANDBY GENERATORS

The Safe, Automatic Solution for Home Backup.

The power goes out and the generator goes on – whether you are home or away. It's that's simple. Install the #1 selling home standby generator from Generac and never again deal with extension cords or refuelling in a storm. Instead, enjoy safe, automatic home protection from the inconveniences and potentially dangerous effects of power outages. There's nothing like the peace of mind a Generac automatic home standby generator can give to you and your family.



AUTOMATIC 24/7 POWER PROTECTION

Portable power since 1959

Since the original portable that started it all in 1959, Generac has continued to engineer advances in standby power for more than fifty years. Generac's product range now includes power solutions from RV, portable, and automatic home standby generators to backup systems for commercial and industrial applications, all backed by an extensive nationwide service network of certified dealers. Because of our ongoing commitment to quality and innovation, Generac is the name home and business owners have come to trust.

Portable Parts and Service

Generac portable generators are supported through an extensive nationwide service network that provides parts and technical support to homeowners and contractors. For a portable generator dealer near you, visit generac.com.

GENERAC®

Generac Power Systems, Inc.
S45 W29290 Hwy. 59
Waukesha, WI 53189
1-888-GENERAC (1-888-436-3722)

generac.com