

## Tetra miniMAX

### Specification Features

- OptiLens maximizes the area of light coverage to produce outstanding uniformity
- Mounting tape and pre-drilled holes make mounting easy
- Overmolded design protects components from moisture
- Full range of color offering, including white, warm white, red, blue and green



### Applications

Logo letter series:

- Miniature channel letter lighting

Commercial building decoration including:

- Cove lighting
- Accent lighting
- Border lighting, etc

### Dimensions

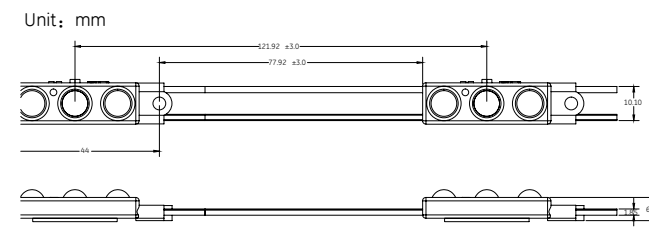

### Ordering Description

SKU	SKU Description	Pack Qty
GEWHMMS8	miniMAX,7100K,8 LEDs/ft(-25 LEDs/m)	30.48m/Box(250 modules)
GEWWMMS8	miniMAX,3200K,8 LEDs/ft(-25 LEDs/m)	30.48m/Box(250 modules)
GEWHMMS8-50K	miniMAX,5000K,8 LEDs/ft(-25 LEDs/m)	30.48m/Box(250 modules)
GEWWMMS8-41K	miniMAX,4100K,8 LEDs/ft(-25 LEDs/m)	30.48m/Box(250 modules)
GEWHMMS8WD	miniMAX,7100K,3 Module Sample	1 sample
GEWWMMS8WD	miniMAX,3200K,3 Module Sample	1 sample
GERDMMSS5	Red,5 LEDs/ft(-16 LEDs/m)	30.48m/Box(250 modules)
GEGLMMSS5	Green,5 LEDs/ft(-16 LEDs/m)	30.48m/Box(250 modules)
GEBLMMSS5	Blue,5 LEDs/ft(-16 LEDs/m)	30.48m/Box(250 modules)
GEPSS12-20	Power Supply(12V DC/20W)	10/Box
GEPSS12-60	Power Supply(12V DC/60W)	10/Box
GEPSS12W-60	Power Supply(12V DC/60W), IP66	10/Box
GEPSS12D-60U	Power Supply(12V DC/60W),Dimmable 0-10V	10/Box
GEPSS12-180U	Power Supply(12V DC/180W)	8/Box
9409	18 AWG Supply Wire(0.82 mm <sup>2</sup> )	152.40m/spool
191600041	22-14 AWG Twist-on Wire Connector(0.33-2.08 mm <sup>2</sup> )	500/PK
192160004	22-18 AWG In-Line Splice Connector(0.33-0.82 mm <sup>2</sup> )	500/PK

### Technical Specifications

SKU	Color	Beam Angle(°)	CCT	lm/Module	Strip Watt/Module (W)	LPW (lm/W)	Power Supply Loading 60W
GEWHMMS8	White	145	7100K	31	0.38	82	60 ft(150 modules)
GEWWMMS8	Warm White	145	3200K	22	0.38	58	60 ft(150 modules)
GEWWMMS8-50K	Warm White	145	5000K	31	0.38	82	60 ft(150 modules)
GEWWMMS8-41K	Warm White	145	4100K	22	0.38	58	60 ft(150 modules)
GERDMMSS5	Red	155	625nm	10	0.62	16	36 ft(90 modules)
GEGLMMSS5	Green	155	530nm	24	0.62	39	36 ft(90 modules)
GEBLMMSS5	Blue	155	467nm	7	0.62	11	36 ft(90 modules)

## Tetra MAX

### Specification Features

- OptiLens maximizes the area of light coverage to produce outstanding uniformity
- Mounting tape and pre-drilled hole make mounting easy
- Overmolded design protects components from moisture
- Full range of color offering including white, warm white, red, blue, green, amber and red-orange

### Applications

Logo letter series:

- Miniature channel letter lighting

Commercial building decoration including:

- Cove lighting
- Accent lighting
- Border lighting, etc

### Ordering Description

SKU	SKU Description	Pack Qty
GERDMMWA5	MAX Red 2 LED module	30.48m/Box(250 modules)
GERDMMWL6	MAX Red 3 LED module	30.48m/Box(200 modules)
GERCMMWA6	MAX Red-Orange 2 LED module	30.48m/Box(300 modules)
GERCMMWL6	MAX Red-Orange 3 LED module	30.48m/Box(200 modules)
GEVGMXS6	MAX Amber 2 LED module	30.48m/Box(300 modules)
GEGLMMWA5	MAX Green 2 LED module	30.48m/Box(250 modules)
GEBLMMWA5	MAX Blue 2 LED module	30.48m/Box(250 modules)
9409	18 AWG Supply Wire(0.82 mm <sup>2</sup> )	152.40m/spool
191600041	22-14 AWG Twist-on Wire Connector(0.33-2.08 mm <sup>2</sup> )	500/PK
192160004	22-18 AWG In-Line Splice Connector(0.82-2.08 mm <sup>2</sup> )	500/PK
GEWHMMS6	MAX,7100K,6 LEDs/ft(-19 LEDs/m)	30.48m/Box(200 modules)
GEWWMMS6	MAX,3200K,6 LEDs/ft(-19 LEDs/m)	30.48m/Box(200 modules)
GEGLMMMS6	MAX,5000K,6 LEDs/ft(-19 LEDs/m)	30.48m/Box(200 modules)
GEBLMMMS6	MAX,4100K,6 LEDs/ft(-19 LEDs/m)	30.48m/Box(200 modules)
GEWHMMS6	MAX High Output,7100K,6 LEDs/ft(-19 LEDs/m)	30.48m/Box(200 modules)
GEWWMMS6	MAX High Output,3200K,6 LEDs/ft(-19 LEDs/m)	30.48m/Box(200 modules)
GEWHMMS6-50K	MAX High Output,5000K,6 LEDs/ft(-19 LEDs/m)	30.48m/Box(200 modules)
GEWWMMS6-41K	MAX High Output,4100K,6 LEDs/ft(-19 LEDs/m)	30.48m/Box(200 modules)
GEWHMMS6WD	MAX,7100K,2 module sample	1 sample
GEWWMMS6WD	MAX,3200K,2 module sample	1 sample
GEWHMMS6WD	MAX High Output,7100K,2 module sample	1 sample
GEWWMMS6WD	MAX High Output,3200K,2 module sample	1 sample
9409	18 AWG Supply Wire(0.82 mm <sup>2</sup> )	152.40m/spool
191600041	22-14 AWG Twist-on Wire Connector(0.33-2.08 mm <sup>2</sup> )	500/PK
192160004	22-18 AWG In-Line Splice Connector(0.33-0.82 mm <sup>2</sup> )	500/PK
GEPSS12-20	Power Supply(12V DC/20W)	10/Box
GEPSS12-60	Power Supply(12V DC/60W)	10/Box
GEPSS12W-60	Power Supply(12V DC/60W), IP66	10/Box
GEPSS12D-60U	Power Supply(12V DC/60W),Dimmable 0-10V	10/Box
GEPSS12-180U	Power Supply(12V DC/180W)	8/Box

### Technical Specifications

SKU	Color	CCT	lm/Module	Beam Angle (°)	Strip Watt/Module (W)	Power Supply Loading 60W
GERDMMWA5	Red	625nm	9	150	0.41	60ft(120 modules)
GERDMMWL6	Red	625nm	14	150	0.41	60ft(120 modules)
GERCMMWA6	Red-Orange	618nm	6	150	0.33	40ft(80 modules)
GERCMMWL6	Red-Orange	618nm	9	150	0.33	40ft(80 modules)
GEVGMXS6	Amber	592nm	7	100	0.33	54ft(113 modules)
GEGLMMWA5	Green	530nm	19	150	0.41	70ft(140 modules)
GEBLMMWA5	Blue	467nm	7	150	0.41	54ft(116 modules)
GEWHMMS6	White	7100K	38	150	0.48	80ft(160 modules)
GEWWMMS6	Warm White	3200K	27	150	0.48	54ft(116 modules)
GEWWMMS6-50K	Warm White	7100K	58	150	0.72	54ft(113 modules)
GEWWMMS6-41K	Warm White	5000K	58	150	0.72	54ft(113 modules)
GEWWMMS6WD	Warm White	4100K	46	150	0.72	54ft(113 modules)
GEWWMMS6WD	Warm White	3200K	46	150	0.72	54ft(113 modules)



### Dimensions

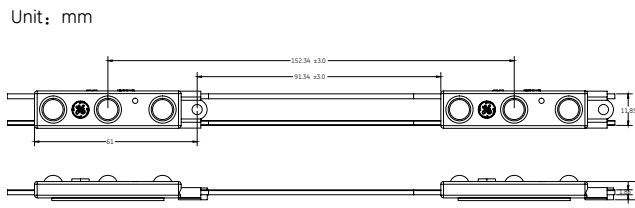

## Tetra PowerMax

### Specification Features

- OptiLens maximizes the area of light coverage to produce outstanding uniformity
- Mounting tape and pre-drilled hole make mounting easy
- Overmolded design protects components from moisture

### Applications

Logo letter series:

- Large channel letter Lighting

Commercial building decoration including:

- Cove lighting
- Accent lighting
- Border lighting, etc

### Dimensions

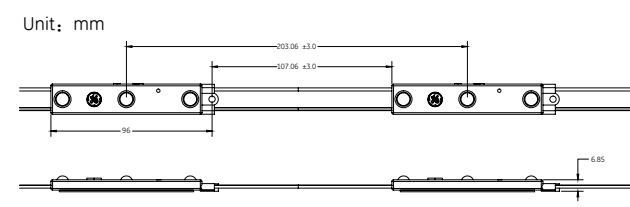

### Ordering Description

SKU	SKU Description	Pack Qty
GEWHPMTL5	PowerMAX,7100K,5 LEDs/ft(-16 LEDs/m)	30.48m/Box(150 modules)
GEWWMPTL5	PowerMAX,3200K,5 LEDs/ft(-16 LEDs/m)	30.48m/Box(150 modules)
GEWHPMTL5-50K	PowerMAX,5000K,5 LEDs/ft(-16 LEDs/m)	30.48m/Box(150 modules)
GEWWMPTL5-41K	PowerMAX,4100K,5 LEDs/ft(-16 LEDs/m)	30.48m/Box(150 modules)
GEWHPMTL5WD	PowerMAX,7100K,2 Module Sample	1 sample
GEWWMPTL5WD	PowerMAX,7100K,2 Module Sample	1 sample
GEPSS12-20	Power Supply(12V DC/20W)	10/Box
GEPSS12-60	Power Supply(12V DC/60W)	10/Box
GEPSS12W-60	Power Supply(12V DC/60W), IP66	10/Box
GEPSS12D-60U	Power Supply(12V DC/60W),Dimmable 0-10V	10/Box
GEPSS12-180U	Power Supply(12V DC/180W)	8/Box
9409	18 AWG Supply Wire(0.82 mm <sup>2</sup> )	152.40m/spool
191600041	22-14 AWG Twist-on Wire Connector(0.33-2.08 mm <sup>2</sup> )	500/PK
192160004	22-18 AWG In-Line Splice Connector(0.33-0.82 mm <sup>2</sup> )	500/PK

### Technical Specifications

SKU	Color	CCT	Modules/ft	Beam Angle(°)	lm/Module	Strip Watt/Module (W)	LPW (lm/W)	Power Supply
GEWHPMTL5	White	7100K	1.5	150	121	1.56	78	12V AC
GEWWMPTL5-50K	Warm White	5000K	1.5	150	121	1.56	78	12V AC
GEWWMPTL5-41K	Warm White	4100K	1.5	150	95	1.56	61	12V AC
GEWWMPTL5	Warm White	3200K	1.5	150	95	1.56	61	12V AC



## Tetra PowerStrip

### Specification Features

- Up to 79% energy savings vs. T12 HO fluorescent
- OptiLens maximizes the area of light coverage to produce outstanding uniformity
- Mounting tape and pre-drilled holes make mounting easy
- Overmolded design protects components from moisture
- Available in single-sided and double-sided system
- Environmental friendly, no mercury

### OptiLens provides better looking sign



Tetra PowerStrip without OptiLens

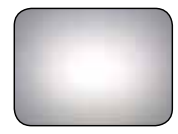

Tetra PowerStrip with OptiLens

### Ordering Description

SKU	SKU Description	Pack Qty
GEWHSSPS3	PowerStrip,7100K	48 modules
GEWWSPPS3-50K	PowerStrip,5000K	48 modules
GEWWSPPS3-41K	PowerStrip,4100K	48 modules
GEWWSPPS3	PowerStrip,3200K	48 modules
GEPSS12-20	Power Supply(12V DC/20W)	10/Box
GEPSS12-60	Power Supply(12V DC/60W)	10/Box
GEPSS12W-60U	Power Supply(12V DC/60W),Dimmable 0-10V	10/Box
GEPSS12W-60	Power Supply(12V DC/60W), IP66	10/Box
GEPSS12-180U	Power Supply(12V DC/180W)	8/Box
GEWHDSPS6	PowerStrip DS,7100K	32 modules
GEWWDSPS6-50K	PowerStrip DS,5000K	32 modules
GEWWDSPS6-41K	PowerStrip DS,4100K	32 modules
GEWWDSPS6	PowerStrip DS,3200K	32 modules
GEPSS24-20	Power Supply(24V DC/20W)	10/Box
GEPSS24-80	Power Supply(24V DC/80W)	10/Box
GEPSS24D-80U	Power Supply(24V DC/80W),Dimmable 0-10V	10/Box
GEPSS24W-80	Power Supply(24V DC/80W), IP66	10/Box
GEPSS24-180U	Power Supply(24V DC/180W)	8/Box
9409	18 AWG Supply Wire(0.82 mm <sup>2</sup> )	152.40m/spool
191600041	22-14 AWG Twist-on Wire Connector(0.33-2.08 mm <sup>2</sup> )	500/PK
192160004	22-18 AWG In-Line connectors (IDCI)0.82-2.08 mm <sup>2</sup> )	500/PK
GETMEC1	18 AWG Wire End Caps(0.82 mm <sup>2</sup> )	100/PK
GEDSRL08	Mounting Rail	8 rails
GEDSLB1	Mounting Rail Assembly Bracket	20/PK

### PowerStrip (DC12V)

SKU	Color	Viewing Angle(°)	CCT	LED Numbers/Module	lm/Module	System Watt/Module (W)	W x L x H (mm)	Cut Unit	Most Suitable Depth Range (mm)	Waterproofing Property	Using Temperature (°C)	Wire Supply Wire	End Cap	Life
GEWHSSPS3	White	140	7100K	3	267	3.58	15 x 224 x 29	Every 1 module	>127	IP66	-40~+60	AWG 18 (0.82 mm <sup>2</sup> )	GETMEC1	50,000hours
GEWWSPPS3-50K	Warm White	140	5000K	3	267	3.58	15 x 224 x 29	Every 1 module	>127	IP66	-40~+60	AWG 18 (0.82 mm <sup>2</sup> )	GETMEC1	50,000hours
GEWWSPPS3-41K	Warm White	140	4100K	3	200	3.58	15 x 224 x 29	Every 1 module	>127	IP66	-40~+60	AWG 18 (0.82 mm <sup>2</sup> )	GETMEC1	50,000hours
GEWWSPPS3	Warm White	140	3200K	3	200	3.58	15 x 224 x 29	Every 1 module	>127	IP66	-40~+60	AWG 18 (0.82 mm <sup>2</sup> )	GETMEC1	50,000hours

### PowerStrip DS (DC24V)

SKU	Color	Viewing Angle(°)	CCT	LED Numbers/Module	lm/Module	System Watt/Module (W)	W x L x H (mm)	Cut Unit	Most Suitable Depth Range (mm)	Waterproofing Property	Using Temperature (°C)	Wire Supply Wire	End Cap	Life
GEWHDSPS6	White	140	7100K	6	534	7.14	16 x 224 x 34	Every 1 module	>254	IP66	-40~+60	AWG 18 (0.82 mm <sup>2</sup> )	GETMEC1	50,000hours
GEWWDSPS6-50K	Warm White	140	5000K	6	534	7.14	16 x 224 x 34	Every 1 module	>254	IP66	-40~+60	AWG 18 (0.82 mm <sup>2</sup> )	GETMEC1	50,000hours
GEWWDSPS6-41K	Warm White	140	4100K	6	400	7.14	16 x 224 x 34	Every 1 module	>254	IP66	-40~+60	AWG 18 (0.82 mm <sup>2</sup> )	GETMEC1	50,000hours
GEWWDSPS6	Warm White	140	3200K	6	400	7.14	16 x 224 x 34	Every 1 module	>254	IP66	-40~+60	AWG 18 (0.82 mm <sup>2</sup> )	GETMEC1	50,000hours



### Dimensions

Unit: mm

### PowerStrip

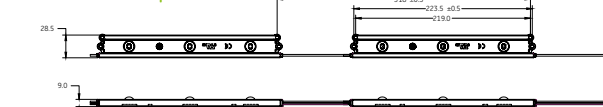

### PowerStrip DS

