

# CADDY SPEED LINK Quad-Toggle with Eyelet Extension – SLD15QT250

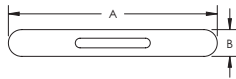

- Secure hanging solution for use on control access points, projectors, etc.

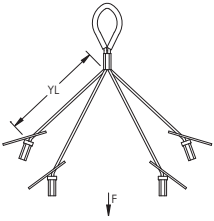

Part Number	SLD15QT250
Material	Steel
Finish	Electrogalvanized
Static Load Safety Factor	5:1
Wire Rope Diameter	1.5 mm
Wire Rope "Y" Length (YL)	9.8"
A	1 1/2"
B	0.2"
Static Load (F)	44 lb
Certifications	cULus
Standard Packaging Quantity	20 pc
UPC	78285661519
EAN-13	8711893129168

CADDY SPEED LINK locking device not included.

UL, UR, cUL, cUR, cULus and cURus are registered certification marks of UL LLC.

#### WARNING

Pentair products shall be installed and used only as indicated in Pentair's product instruction sheets and training materials. Instruction sheets are available at [erico.pentair.com](http://erico.pentair.com) and from your Pentair customer service representative. Improper installation, misuse, misapplication or other failure to completely follow Pentair's instructions and warnings may cause product malfunction, property damage, serious bodily injury and death and/or void your warranty.

© 2016 Pentair All rights reserved

Pentair, CADDY, CADWELD, CRITEC, ERICO, ERIFLEX, ERITECH and LENTON are owned by Pentair or its global affiliates.

All other trademarks are the property of their respective owners. Pentair reserves the right to change specifications without prior notice.

