

Base Mounting Adapters

Base Mounting Plate

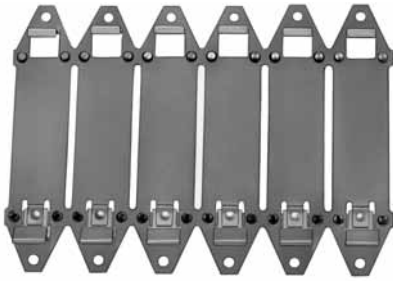

Base Mounting Plate

Suitable for mounting (6) single-pole circuit breakers.

**Table 12-523. Base Mounting Plate
G-Frame GD/GHC**

Number Units in Package	Catalog Number	Price U.S. \$
1	207B513G01	

DIN Rail Adapter



DIN Rail Adapter

For use with standard 35 mm DIN Rail such as, 35 x 7.5 or 35 x 15 mm per DIN EN50022.

Adapter mounting screws included are for use with 2- and 3-pole circuit breakers. Adapters for 1-pole circuit breakers (pictured above) clip into the base molding.

**Table 12-524. DIN Rail Adapter
G-Frame GD/GHC**

Poles	Number Units in Package	Catalog Number	Price U.S. \$
1, 2-Pole	10	1225C79G01	
3-Pole	10	1225C79G02 ①	

① For use on 3-pole breakers only.

Key Operated Attachment

**Table 12-525. Key Operated Attachment
G-Frame GD/GHC**

Number Units in Package	Catalog Number	Price U.S. \$
10	GK0A	

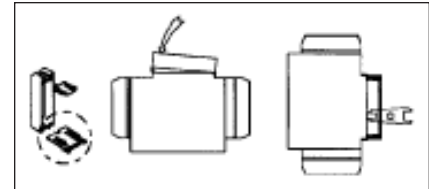

Figure 12-55. Key Operated Attachment

Lock Dog (Non-Padlockable)



Lock Dog (Non-Padlockable)

Table 12-526. Lock Dog (Non-Padlockable) G-Frame GD/GHC/GHB/GMCP

Number Units in Package	Catalog Number	Price U.S. \$
1	1294C01H01	

Non-Padlockable Handle Block

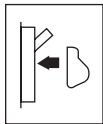

Non-Padlockable Handle Block

Product Description

The Non-Padlockable Handle Block secures the circuit breaker handle in either the ON or OFF position. (Trip-free operation allows the circuit breaker to trip when the handle block holds the circuit breaker handle in the ON position.) The device is positioned over the circuit breaker handle and secured by a setscrew to deter accidental operation of the circuit breaker handle. Listed per UL File E7819. (Field installation only.)

Table 12-527. Non-Padlockable Handle Block

Frame	Catalog Number	Price U.S. \$
F J, K L, M, N	LKD1 LKD3 LKD4	

Padlockable Handle



Padlockable Handle

Table 12-528. Padlockable G-Frame GD/GHC/GHB

Number Units in Package	Catalog Number ①	Price U.S. \$
10	1223C77G03	
10	1223C77G05 ②	
100	1223C77G06 ②	

- ① Accepts .285 Lock Shank.
- ② Padlockable in the OFF position only.

Padlockable Handle Lock



Padlockable Handle Lock

The device is positioned in the cover opening to prevent handle movement. Will accommodate one 5/16-inch (8 mm) padlock.

Table 12-529. Padlockable Handle Lock

Frame	Catalog Number	Price U.S. \$
G J, K	GPHBOFF PHB3	

Snap-on Padlockable Handle Lock Hasp



Snap-on Padlockable Handle Lock Hasp

Product Description

The Snap-on Padlockable Handle Lock allows the handle to be locked in the OFF or ON position. (Trip-free operation allows the circuit breaker to trip when the handle lock holds the circuit breaker handle in the ON position.) This device was designed for use on the 1-pole circuit breaker, but may be used on 1-, 2-, 3- and 4-pole styles. The handle lock snaps onto the escutcheon area of the handle with an optional retaining screw for added secureness. The handle lock will accommodate one padlock with a 1/4-inch (6.4 mm) shackle. Listed per UL File E7819. (Field installation only.)

Table 12-530. Snap-on Padlockable Handle Lock Hasp

Frame	Catalog Number	Price U.S. \$
F	PHL1	

Handle Locking and Blocking Devices

Padlockable
Handle Lock Hasp

Padlockable Handle Lock Hasp

Product Description

The Padlockable Handle Lock Hasp allows the handle to be locked in the ON or OFF position. (Trip-free operation allows the circuit breaker to trip when the handle lock holds the circuit breaker handle in the ON position.) The hasp mounts on the circuit breaker cover within the trimline. The cover is predrilled on both sides of the operating handle so that the hasp can be mounted on either side of the handle. The hasp will accommodate up to three padlocks with 1/4-inch (6.4 mm) shackles, one per circuit breaker. Listed per UL File E7819. (Field installation only.)

Table 12-531. Padlockable Handle Lock Hasp

Description	Catalog Number	Price U.S. \$
-------------	----------------	---------------

F-Frame

1-Pole Breakers	PHL1	
2-, 3-, 4-Pole Breakers	PLK1	
For Left Side Mounting	PLK1LOFF	
For Right Side Mounting	PLK1ROFF	

J, K-Frames

2-, 3-, 4-Pole Breakers	PLK3	
For Left Side Mounting	PLK3LOFF ①	
For Right Side Mounting	PLK3ROFF ①	

L-Frame (Side Mounted)

Side Mounted		
Lock ON or OFF	HLK4	
Lock OFF Only (Left-Hand Mount)	HLK4LOFF ①	

L-Frame (Top Mounted)

Lock ON or OFF	HLK4S	
Lock OFF Only	HLK4SOFF ①	

M-Frame

Lock ON or OFF	HLK4	
Lock OFF Only (Left-Hand Mount)	HLK4LOFF ①	

M-Frame (Vertical Mounting)

Lock ON/OFF	HLK4S	
Lock OFF Only	HLK4SOFF	

N-Frame

Side Mounted	PLK5	
Top Mounted (ON/OFF)	PLK5S	
Top Mounted (OFF Only)	PLK5SOFF ①	

R-Frame

Lock ON/OFF	HLK6	
Lock OFF Only	HLK6OFF ①	

① For padlockable handle lock hasp to padlock handle in OFF position only order either catalog number.

Cylinder Lock

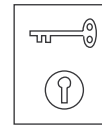

Cylinder Lock

Product Description

The Cylinder Lock internally blocks the trip bar in the tripped position to prevent the circuit breaker from being switched to ON. The cylinder lock is factory installed in the left pole only of the circuit breaker cover. Other internally mounted accessories cannot be installed in the same pole as the cylinder lock. (Factory installation only.)

Table 12-532. Cylinder Lock

Frame	Catalog Number	Price U.S. \$
F, J, K	Order by Description	

**Key Interlock Kit
(Lock Not Included)**



Key Interlock Kit

Product Description

The Key Interlock is used to externally lock the circuit breaker handle in the OFF position. When the key interlock is locked, an extended deadbolt blocks movement of the circuit breaker handle. Uniquely coded keys are removable only with the deadbolt extended. Each coded key controls a group of circuit breakers for a given specific customer installation.

The key interlock assembly is Underwriters Laboratories listed for field installation under UL File E7819 and consists of a mounting kit and a purchaser supplied deadbolt lock. The mounting kit comprises a mounting plate, which is secured to the circuit breaker cover in either the left- or right-pole position, key interlock mounting screws, and a wire seal. Specific mounting kits are required for individual key interlock types.

Ordering Information

Key interlock mounting kits are for field installation only. Select mounting kit catalog numbers to match type of lock used. Key interlocks are supplied by customer.

Table 12-533. Key Interlock Kit

Lock Manufacturer	Lock Type	Bolt Projection in Withdrawn Position in Inches (mm)	Kit Catalog Number	Price U.S. \$
F-Frame				
Superior Kirk® Square D®	B-4003-1 F SF	.38 (9.5) .38 (9.5) None	KYK1	
Castell ①	K or QK	.38 (9.5)	CTK1	
J, K-Frames				
Superior Kirk Square D	B-4003-1 F SF	.38 (9.5) .38 (9.5) None	KYK3	
Castell ①	K or QK	.38 (9.5)	CTK3	
L-, M-, N-Frames				
Superior Kirk Square D	B-4003-1 F SF	.38 (9.5) .38 (9.5) None	KYK4	
Castell ①	K or QK	.38 (9.5)	CTK4	
R-Frame				
Superior Kirk Square D	B-4003-1 F SF	1.0 (25.4) 1.0 (25.4) 1.0 (25.4)	KYK6	
Castell ①	K or QK	1.0 (25.4)	CTK6	
JG-Frame				
Superior Kirk Square D	B-4003-1 F SF	.38 (9.5) .38 (9.5) None	KYKJG	
Castell ①	K or QK	.38 (9.5)	CTKJG	
LG-Frame				
Superior Kirk Square D	B-4003-1 F SF	.38 (9.5) .38 (9.5) None	KYKLG	
Castell ①	K or QK	.38 (9.5)	CTKLG	

① When ordering Castell Interlock, it is necessary for customer to specify that the mounting bolt holes must be 10 mm in diameter.

Mechanical Interlocking Devices

Sliding Bar Interlock



Sliding Bar Interlock

Product Description

The Sliding Bar Interlock provides mechanical interlocking between two adjacent 3-pole circuit breakers. It is installed on the enclosure cover between the circuit breakers. When the sliding bar interlock handle is moved from one side to the other, a bar extends to alternately block movement of the circuit breaker handles and prevents both circuit breakers from being switched to ON at the same time. Sliding bar interlocks are not UL listed. (Field installation only.)

Ordering Information

The sliding bar interlock is available for mounting between two adjacent 3-pole circuit breakers with circuit breakers centerline spacing as indicated in table and enclosure front panel thickness of 1/8 or 3/16 inch (3.2 or 4.8 mm). (For field installation only.)

Table 12-534. Sliding Bar Interlock

Frame	Centerline Spacing in Inches (mm)	Catalog Number	Price U.S. \$
F	4.19 (106.4)	SBK1	
J	4.38 (111.3)	SBK2	
K	5.75 (146.0)	SBK3	
L, M	8.50 (215.9)	SBK4	
N	8.50 (215.9)	SBK5	

Walking Beam Interlock

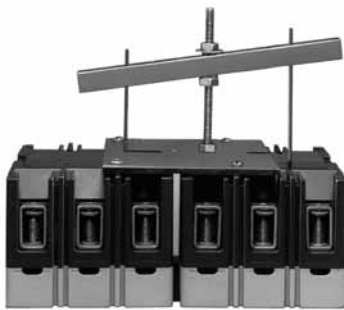

Walking Beam Interlock

Product Description

The Walking Beam Interlock provides mechanical interlocking between two adjacent circuit breakers of the same pole configuration. The walking beam interlock mounts on a bracket behind and between the circuit breakers. A plunger on each end of the beam is inserted through an access hole in the back plate and base of each circuit breaker. The walking beam interlock prevents both circuit breakers from being switched ON at the same time. If a walking beam interlock is installed, the wiring troughs in the back of the circuit breaker case are blocked by the plungers and cannot be used for cross wiring. Factory modified circuit breakers are required for this application. UL File E3816.

Ordering Information

The walking beam interlock is available for mounting between two adjacent circuit breakers spaced 1/4-inch (6.4 mm) apart and having the same pole configuration. The two circuit breakers must be factory modified to accept the walking beam interlock assembly (suitable for use with either 2-, 3- or 4-pole circuit breakers).

With properly modified circuit breakers, the walking beam interlock is suitable for field installation. Order circuit breakers specifying modification for walking beam (20% price adder) and select walking beam interlock from table below. Circuit breakers and walking beam interlock are boxed and shipped separately.

Table 12-535. Walking Beam Interlock

Frame	Catalog Number	Price U.S. \$
F	WBL1	
K	WBL3	
L, M	WBL4A	
N	WBL5	
R ①	WBL6	

① 3-pole only.