

# Cable Connectors

## For Armored Cable & Flexible Metal Conduit

### Type AC

#### 45° Angle Squeeze Connectors

**Use:**  
To ground and secure Armored Cable and Flexible Metal Conduit to boxes and enclosures.

- Features:**
- Male hubs - NPS.
  - Provided with center stop.
  - Available with insulated throats.
  - Furnished with locknuts
  - Also suitable for NM and SE cable

**Material/Finish:**  
Malleable Iron/Zinc Electroplated

**Third Party Certification:**

 UL Listed: E-11852  
UL Listed for armored cable and flexible steel conduit.  
UL Listed flexible metal conduit fittings are suitable for use in Hazardous Location under NEC 501-4(b) Class I Div. II, and suitable as a grounding means under NEC 350-5.

 CSA Certified: 009795.  
CSA Certified for armored cable.

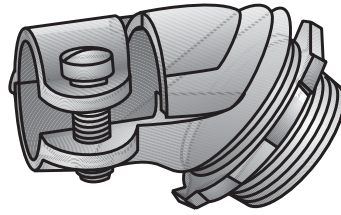

Type AC-38

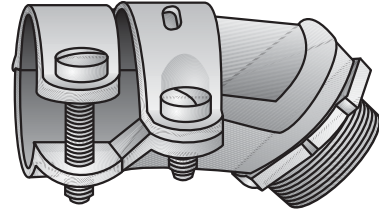

Type AC-50

Trade Size Flt (Inches)	Catalog Number	Insulated Throat Catalog Number	Body Length	Dimensions in Inches		
				Thread Length	Max. Width	Opening
3/8 (1/2 KO)	AC-38	AC-38T	1 3/8	7/16	1 1/4	39/64 - 17/32
1/2	AC-50	AC-50T	1 15/16	7/16	1 11/16	15/16 - 25/32
3/4	AC-75	AC-75T	2 1/8	1/2	1 3/4	1 1/16 - 29/32

**Applicable Third Party Standards:**  
UL Standard: 514B (1203)  
CSA Standard C22.2 No. 18  
NEMA: FB-1

### Type 25-38C

#### Duplex Connector

**Use:**  
To ground and secure two Armored Cables to boxes and enclosures.

- Features:**
- For armored cable 1 1/2 to 10/2 or combination of sizes
  - Furnished with locknuts.
  - Male hubs-NPS

**Material/Finish:**  
Malleable Iron/Zinc Plated

**Third Party Certification:**

 UL Listed: E-11852  
UL Listed flexible metal conduit fittings are suitable for use in Hazardous Locations under NEC 501-4(b) Class I Div. II, and suitable as a grounding means under NEC 350-5.

Trade Size Flt (Inches)	Catalog Number	Body Length	Dimensions in Inches		
			Thread Length	Max. Width	Opening
3/8 (1/2 KO)	25-38C	1 1/16	7/16	1 9/16	7/32 - 17/32

 CSA Certified: 9795

**Applicable Third Party Standards:**  
UL Standard: 514B (1203)  
CSA Standard C22.2 No. 18  
NEMA: FB-1

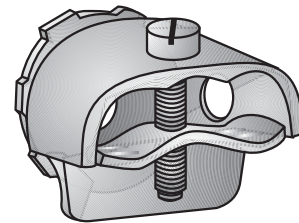

Type 25-38C

# Cable Connectors

## For Armored Cable & Flexible Metal Conduit

### Type AC & Type ACV 90° 2-Screw Clamp Connectors 90° Angle Squeeze Connectors

**Use:**

To ground and secure Armored Cable and Flexible Metal Conduit to boxes and enclosures.

**Features:**

- Male hub threads - NPS.
- All center stopped.
- Furnished with locknuts.
- Available with insulated throat
- Also suitable for NM and SE cable

**Material/Finish:**

Malleable Iron/Zinc Electroplated

**Third Party Certification:**



UL Listed: E-11852  
ACV-938 through ACV-75: UL Listed for armored cable and flexible metal conduit.  
UL Listed: E-11853/ E-14814  
AC-100 through AC-400: UL Listed for flexible metal conduit.  
UL Listed flexible metal conduit fittings are suitable for use in Hazardous Locations under NEC 501-4(b) Class I Div. II, and suitable as a grounding means under NEC 350-5.



CSA Certified: 9795, 11584 and 065178.  
Armored cable and Flexible Metal Conduit

**Applicable Third Party Standards:**

UL Standard: 514B  
CSA Standard C22.2 No. 18  
NEMA: FB-1

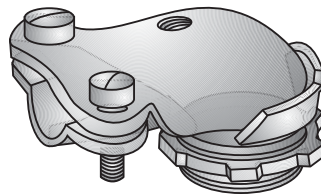

Type ACV-938

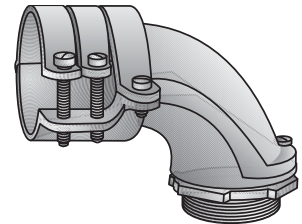

Type AC-150 – Type AC-200

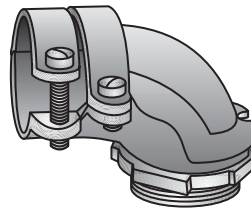

Type ACV-50 – Type AC-125

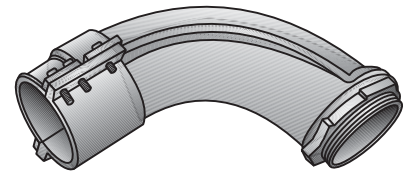

Type AC-250 – Type AC-400

Trade Size (inches)	Catalog Number	Insulated Throat Catalog Number	Dimensions in Inches			
			A	B	C	Flex Opening
3/8 (1/2 KO)	ACV-938	ACV-938T	1 <sup>5</sup> / <sub>16</sub>	1 <sup>3</sup> / <sub>16</sub>	7/16	2 <sup>3</sup> / <sub>64</sub> - 2 <sup>1</sup> / <sub>32</sub>
1/2	ACV-50	ACV-50T	1 <sup>3</sup> / <sub>4</sub>	1 <sup>1</sup> / <sub>16</sub>	7/16	2 <sup>5</sup> / <sub>32</sub> - 6 <sup>1</sup> / <sub>64</sub>
3/4	ACV-75	ACV-75T	1 <sup>13</sup> / <sub>16</sub>	1 <sup>1</sup> / <sub>8</sub>	7/16	2 <sup>9</sup> / <sub>32</sub> - 1 <sup>1</sup> / <sub>64</sub>
1	AC-100	AC-100T	2 <sup>5</sup> / <sub>16</sub>	2 <sup>10</sup> / <sub>77</sub>	1/2	1 <sup>3</sup> / <sub>16</sub> - 1 <sup>3</sup> / <sub>8</sub>
1 1/4	AC-125	AC-125T	2 <sup>4</sup> / <sub>5</sub>	2 <sup>3</sup> / <sub>4</sub>	5/8	1 <sup>1</sup> / <sub>2</sub> - 1 <sup>3</sup> / <sub>4</sub>
1 1/2	AC-150	AC-150T	3	3 <sup>1</sup> / <sub>2</sub>	5/8	1 <sup>12</sup> / <sub>16</sub> - 2
2	AC-200	AC-200T	4 <sup>1</sup> / <sub>8</sub>	4 <sup>3</sup> / <sub>4</sub>	3/4	2 <sup>11</sup> / <sub>16</sub> - 3
2 1/2	AC-250	AC-250T	4 <sup>7</sup> / <sub>8</sub>	5 <sup>7</sup> / <sub>8</sub>	1 <sup>1</sup> / <sub>8</sub>	3 <sup>3</sup> / <sub>16</sub> - 3 <sup>1</sup> / <sub>2</sub>
3	AC-300	AC-300T	5 <sup>1</sup> / <sub>2</sub>	6 <sup>5</sup> / <sub>8</sub>	1 <sup>1</sup> / <sub>8</sub>	3 <sup>1</sup> / <sub>2</sub> - 3 <sup>3</sup> / <sub>8</sub>
3 1/2	AC-350	AC-350T	10 <sup>1</sup> / <sub>4</sub>	7 <sup>3</sup> / <sub>4</sub>	1 <sup>1</sup> / <sub>4</sub>	3 <sup>45</sup> / <sub>64</sub> - 4 <sup>5</sup> / <sub>32</sub>
4	AC-400	AC-400T	13	9 <sup>3</sup> / <sub>4</sub>	1 <sup>1</sup> / <sub>4</sub>	4 <sup>7</sup> / <sub>64</sub> - 4 <sup>9</sup> / <sub>16</sub>

