

TC Cable Connector

Tray Cable

Class I, Division 2, Groups A, B, C, D
 Class II, Division 2, Groups E, F, G
 Class III, Division 2
 NEMA Type 4X

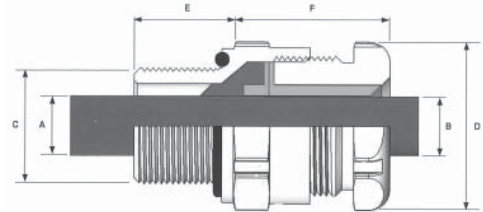

| Across Flats D | Across Corners D | Min. Thread Length E | Nominal Assembly Length F | Approx. Weight Aluminum (Oz/G) |
|-------------------|---------------------|-------------------------|------------------------------|-----------------------------------|
| 1.20/30.5 | 1.30/33.0 | 0.78/19.8 | 0.79/20.1 | 1.94/55.0 |
| | | 0.80/20.3 | | 1.94/55.0 |
| 1.20/30.5 | 1.30/33.0 | 0.78/19.8 | 0.79/20.1 | 1.69/48.0 |
| | | 0.80/20.3 | | 1.69/48.0 |
| 1.48/37.6 | 1.60/40.6 | 0.80/20.3 | 0.98/24.9 | 3.17/90.0 |
| | | 0.98/24.9 | | |
| 1.81/45.9 | 1.95/49.5 | 0.98/24.9 | 0.98/24.9 | 3.88/110.0 |
| | | 1.00/25.4 | | |
| 2.05/52.1 | 2.21/56.1 | 1.00/25.4 | 1.18/29.9 | 4.94/140.0 |
| | | 1.03/26.2 | | |
| 2.36/59.9 | 2.55/64.8 | 1.03/26.2 | 1.26/32.0 | 6.00/170.1 |
| | | 1.06/26.9 | | |
| 2.95/74.9 | 3.19/81.0 | 1.06/26.9 | 1.26/32.0 | 8.64/245.0 |
| | | 1.57/39.9 | | |
| 2.95/74.9 | 3.19/81.0 | 1.06/26.9 | 1.65/41.9 | 8.29/235.0 |
| | | 1.57/39.9 | | |
| 3.54/89.9 | 3.82/97.0 | 1.57/39.9 | 1.65/41.9 | 13.58/385.0 |
| | | 1.63/41.4 | | |
| 3.54/89.9 | 3.82/97.0 | 1.57/39.9 | 1.69/42.9 | 13.58/385.0 |
| | | 1.63/41.4 | | |
| 4.33/109.9 | 4.68/118.9 | 1.63/41.4 | 1.69/42.9 | 26.63/755.0 |
| | | 1.68/42.7 | | |
| 4.84/122.9 | 5.23/132.8 | 1.68/42.7 | 2.28/57.9 | 34.22/970.1 |
| | | 1.73/43.9 | | |
| 5.25/133.4 | 5.67/144.0 | 1.73/43.9 | 2.28/57.9 | 38.80/1100.0 |