

Concrete Slab Electroform Inserts

For Threaded Rigid Conduit & IMC

Type EF & Type EFL

Use:

For conduit installed in poured concrete slabs.

Nail, screw or tack-weld insert to concrete deck form.

Features:

- Inserts available in straight or 90°

Material/Finish:

Malleable Iron/Zinc Plated

Third Party Certification:

 UL Listed: E-11853

 CSA Certified: 009795

Applicable Third Party Standards:

UL Standard: 514B

CSA Standard: C22.2 No. 18

Fed. Spec: W-F-408E

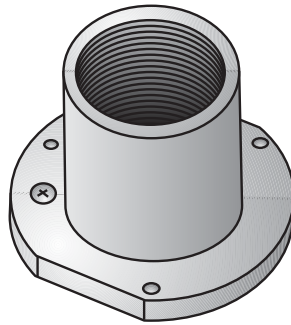

Type EF-50 — Type EF-100
For concrete slab 4" thick and up.

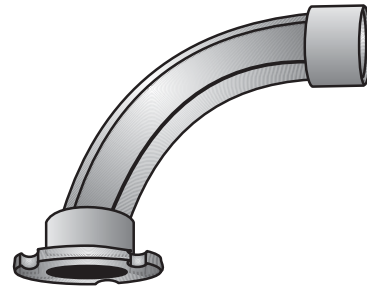

Type EFL-50 — Type EFL-100
For slabs 6" thick and up require
bend conduit sweep.

STRAIGHT CONDUIT INSERTS

| Trade Size (inches) | Catalog Number | Dimensions in Inches | | |
|------------------------|-------------------|----------------------|-------------------------|--------|
| | | Base Dia. | Base Across Flats | Height |
| 1/2 | EF-50 | 1 1/16 | 1 3/4 | 1 1/16 |
| 3/4 | EF-75 | 2 3/16 | 2 | 1 3/8 |
| 1 | EF-100 | 2 1/2 | 3 5/16 | 1 5/8 |

90° CONDUIT INSERTS

| Trade Size (inches) | Catalog Number | Dimensions in Inches | | | |
|------------------------|-------------------|----------------------|-------------------|------------------------------|---------|
| | | Base Dia. | Turning Radius | Base to Conduit Center | Height |
| 1/2 | EFL-50 | 1 1/16 | 3/4 | 3/8 | 3/8 |
| 3/4 | EFL-75 | 2 3/16 | 3 13/16 | 3/16 | 3 11/16 |
| 1 | EFL-100 | 2 1/2 | 3 13/16 | 2 19/16 | 3 11/16 |

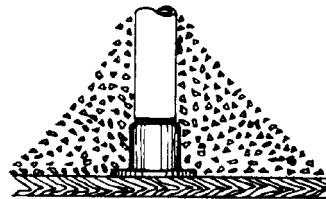

(Wood form shown)

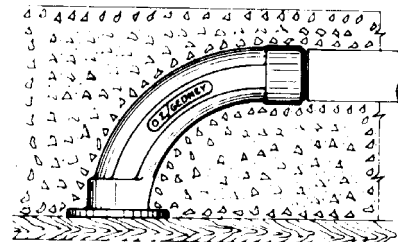

(Wood form shown)

Shown in poured concrete slabs before wood or steel forms are removed.