

## POWER RAIL™

Top-Clamping PV Mounting System Catalog  
P6, P8, P14, LD and MD Rails



 COMMUNICATIONS    ENERGY    SPECIAL INDUSTRIES    SOLAR

 **POWER-FAB®**  
Quality Hardware for the PV Industry





# Table of Contents

<b>POWER RAIL™ Module Mounting System</b>	<b>2</b>	<b>P6 and P8 Tilt Kits</b>	
<b>POWER RAIL™ Extrusions</b>	<b>3</b>	P6 Low-Profile Telescoping Tilt Kits	<b>12</b>
P6 and P8		P8 Low-Profile Telescoping Tilt Kits	<b>12</b>
<b>P14 Extrusions and Attachment</b>		P6 Low-Profile One-Piece Tilt Kits	<b>13</b>
P14 "L" Foot	<b>4</b>	P8 Low-Profile One-Piece Tilt Kits	<b>13</b>
<b>LD and MD Extrusions</b>		<b>Module Clamps</b>	
LD/MD Mounting Bracket	<b>5</b>	RAD™ Hardware	<b>14</b>
<b>P6 and P8 Mounting Attachments</b>		Carriage Bolt Hardware	<b>15</b>
"L" Feet	<b>6</b>	Universal End Clamps	<b>15</b>
Tilted "L" Feet	<b>6</b>	Pre-Assembled End Clamp with RAD Bolt Hardware	<b>16</b>
Easy Feet™	<b>7</b>	Pre-Assembled Mid Clamp with RAD Bolt Hardware	<b>16</b>
Roof Rod Mount	<b>7</b>	Pre-Assembled Mid Clamp with RAD Bolt Hardware and WEEB DPR	<b>17</b>
Power Post™ Stanchions	<b>8</b>	<b>Power Rail™ Accessories</b>	
Easy Power Post™ Stanchions	<b>8</b>	Power Post Flashing	<b>18</b>
Offset Power Post™ Stanchions	<b>9</b>	Flat Roof Flashing	<b>18</b>
Super Post Stanchions	<b>9</b>	Grounding Hardware	<b>19</b>
Corrugated Roof Mounts	<b>10</b>	Turn Bolts	<b>19</b>
Easy Tile Hook	<b>10</b>	Wire Management Clip	<b>19</b>
Power Rail™ Splice Plates	<b>11</b>	<b>Rail Span and Cantilever Distances</b>	<b>20</b>
Power Rail™ PV Flash	<b>11</b>	P6, P8 and P14 Rail	<b>20</b>
		LD Rail and MD Rail	<b>21</b>

# Power Rail™ Module Mounting System



## Top-clamping PV module mounting system engineered to reduce installation costs and provide maximum strength for parallel-to-roof or tilt up mounting applications.

The Power Rail top-clamping mounting system is designed with the professional PV solar installer in mind. The top-clamping rails utilize a single tool with a revolutionary patented RAD™ Fastener for faster bolt placement. The unique shape of the RAD provides an anti-rotation feature, locking

the bolt in the proper orientation when installed. The high strength rigid rails also include an integral wiring channel for securing cables and providing a professional finish. The system includes a wide selection of mounting options designed for secure and water tight attachments to any roof style.

### Mounting Rail Options

- P6-Rail** Engineered to save cost on shorter span applications
- P8-Rail** Engineered for longer span and heavier snow conditions
- P14-Rail** Engineered for commercial applications with greater distances between supports

\* Reference Rail Span and Cantilever Charts on page 20.

### Features

#### High Strength Reliable Design

- Engineered rail profiles for maximum strength-to-weight ratio
- Structural Marine Grade Aluminum rail construction
- High Strength stainless steel module clamps and hardware

#### Reduced Installation Time and Costs

- Single Tool Assembly – all 5/16" hardware
- RAD Fastener for quick bolt placements anywhere along rail
- Under flange clamping option
- Integral Wiring Channel for securing cables

- Standard lengths up to 27 feet eliminate costly rail splices
- Snap-In WEEB Integral module grounding option

#### Flexible Mounting Options

- Height adjustable "L" mounting feet
- Tilt Feet up to 10 degrees
- Solid Aluminum Power Post™ stanchions
- Easy Feet™ attachment anywhere on metal or composite roof decking
- PV Flashing hardware
- Telescoping and One-Piece Tilt Kits up to 65 degrees

# Power Rail™ Extrusions

Power Rail is an engineered profile extrusion made from Series 6000 structural aluminum. Standard finish is mill-finish aluminum.

## P6

Power Rail P6 – Extrusion

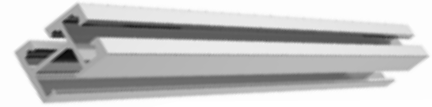

### Standard Lengths

Part #	P6-84	P6-126	P6-162	P6-204	P6-240	P6-282	P6-324
Length	84"	126"	162"	204"	240"	282"	324"
Weight Per Unit (lbs.)	5	7.5	9.5	12	14	16.5	19

### Pricing per Quantities (Higher Volume Discount Available)

1-19	44.00	65.00	83.00	103.00	120.00	139.00	158.00
20-39	42.00	63.00	80.00	99.00	116.00	134.00	152.00
40-59	41.00	60.00	77.00	96.00	111.00	129.00	146.00
60-79	40.00	59.00	74.00	92.00	107.00	124.00	140.00
80-99	38.00	56.00	72.00	88.00	103.00	119.00	135.00
100+	36.00	54.00	68.00	85.00	98.00	114.00	129.00

## P8

Power Rail P8 – Extrusion

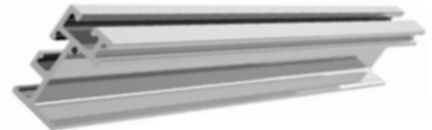

### Standard Lengths

Part #	P8-84	P8-126	P8-162	P8-204	P8-240	P8-282	P8-324
Length	84"	126"	162"	204"	240"	282"	324"
Weight Per Unit (lbs.)	7	10.5	13.5	17	20	23.5	27

### Pricing per Quantities (Higher Volume Discount Available)

1-19	68.00	100.00	128.00	159.00	184.00	214.00	243.00
20-39	65.00	97.00	123.00	153.00	178.00	206.00	234.00
40-59	63.00	93.00	119.00	147.00	171.00	198.00	225.00
60-79	61.00	90.00	114.00	142.00	164.00	191.00	216.00
80-99	58.00	86.00	110.00	136.00	158.00	183.00	207.00
100+	56.00	83.00	105.00	130.00	151.00	175.00	198.00

# Power Rail™ Extrusion

Power Rail is an engineered profile extrusion made from Series 6000 structural aluminum. Standard finish is mill-finish aluminum.

## P14

Power Rail P14 – Extrusion



### Standard Lengths

Part #	P14-84	P14-126	P14-162	P14-204	P14-240	P14-282	P14-324
Length	84"	126"	162"	204"	240"	282"	324"
Weight Per Unit (lbs.)	15.5	23.5	29	38	44.5	52	60
Pricing per Quantities (Higher Volume Discount Available)							
1-19	136.00	200.00	256.00	318.00	368.00	428.00	486.00
20-39	130.00	194.00	246.00	306.00	356.00	412.00	468.00
40-59	126.00	186.00	238.00	294.00	342.00	396.00	450.00
60-79	122.00	180.00	228.00	284.00	328.00	382.00	432.00
80-99	116.00	172.00	220.00	272.00	316.00	366.00	414.00
100+	112.00	166.00	210.00	260.00	302.00	350.00	396.00

## P14 "L" Foot

Part #	Description	Quantity	Weight Per Unit (lbs.)	Price
P14-LF	Power Rail P14 L-Mounting Foot	1-49	0.50	14.25
		50-99		13.75
		100+		13.00

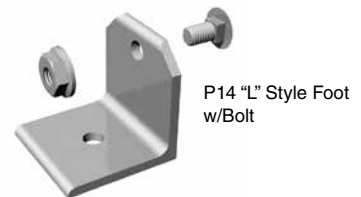

P14 "L" Style Foot w/Bolt

Super Post™ Stanchions may be used with the P14 Rail – refer to page 9.

# Power Rail™ Extrusions

Power Rail is an engineered profile extrusion made from Series 6000 structural aluminum. Standard finish is mill-finish aluminum.



## LD/MD

Power Rail LD and MD – Extrusions

### Standard Lengths\*

Part #	LD-240	LD-282	LD-324	MD-240	MD-282	MD-324
Length	240"	282"	324"	240"	282"	324"
Weight Per Unit (lbs.)	33.4	39.3	45.1	43.8	51.5	59.1
Pricing per Quantities (Higher Volume Discount Available)						
1-19	350.00	407.00	462.00	423.00	492.00	559.00
20-39	338.00	391.00	445.00	409.00	474.00	538.00
40-59	325.00	376.00	430.00	393.00	455.00	518.00
60-79	312.00	363.00	410.00	377.00	439.00	497.00
80-99	300.00	348.00	393.00	363.00	421.00	476.00
100+	287.00	333.00	376.00	347.00	403.00	455.00

\*Longer rail lengths offered – Contact DPW Solar.

## LD/MD Mounting Base Bracket

Part #	Description	Quantity	Weight Per Unit (lbs.)	Price
MBB	Universal Mounting Base Bracket	1-49	0.40	8.11
		50-99		7.83
		100+		7.40



Mounting Base Bracket with 5/16" Hardware

## "L" Feet

"L" Feet are fabricated from high strength 3/16" aluminum and include a vertical slot for adjusting to irregular surfaces.

Part #	Description	Quantity	Weight Per Unit (lbs.)	Price
LF2	2.5" Tall L-Mounting Foot	1-49	0.20	7.00
		50-99		6.50
		100+		6.00
LF3	3.5" Tall L-Mounting Foot	1-49	0.24	9.00
		50-99		8.50
		100+		7.00
LF5	5" Tall L-Mounting Foot	1-49	0.40	10.00
		50-99		9.25
		100+		8.50
LF6	6" Tall L-Mounting Foot	1-49	0.45	12.00
		50-99		11.00
		100+		9.75
PPB	Power Post Bracket	1-49	.09	6.50
		50-99		6.00
		100+		5.50

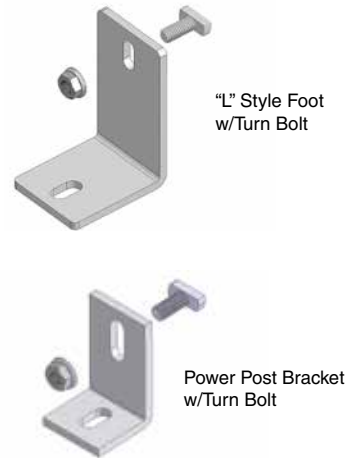

## Tilted "L" Feet

Part #	Description	Quantity	Weight Per Unit (lbs.)	Price
FF5	5° Front Foot	1-49	0.25	8.00
		50-99		7.50
		100+		7.00
BF5	5° Back Foot	1-49	0.50	12.00
		50-99		11.50
		100+		11.00
FF10	10° Front Foot	1-49	0.25	8.00
		50-99		7.50
		100+		7.00
BF10	10° Back Foot	1-49	0.75	16.00
		50-99		15.50
		100+		15.00





# Easy Feet™

Easy Feet mount directly to metal and composite shingles or other roofing materials and do not require attachment to a roof structural member. Sealing butyl mastic backing and RSS PHEinox™ screws are included.

Part #	Description	Quantity	Weight Per Unit (lbs.)	Price
PEF-1.5	Pivot Easy Mounting Foot w/1.5" Screws	1-49	0.76	21.50
		50-99		20.50
		100+		19.00
PEF-2.0	Pivot Easy Mounting Foot w/2.0" Screws	1-49	0.78	22.00
		50-99		21.00
		100+		19.50
PEF-3.0	Pivot Easy Mounting Foot w/3.0" Screws	1-49	0.82	23.00
		50-99		22.00
		100+		20.50

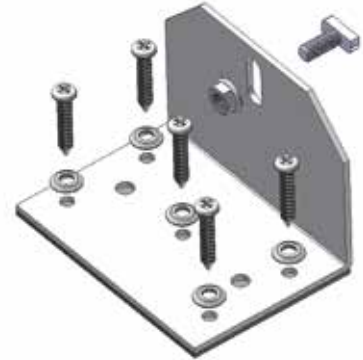

RSS PHEinox™ screws are manufactured by GRK Fasteners.

# Roof Rod Mount

Roof Rod mounts attach directly to the roof deck and are suitable for tile and other roofing materials. Simply, drill a hole through the roofing material. Sealing butyl mastic backing and RSS PHEinox™ screws included.

Part #	Description	Quantity	Weight Per Unit (lbs.)	Price
RRM	Threaded Rod Mount	1-49	1.5	30.00
		50-99		29.00
		100+		27.50



Note: "L" Foot included.

## Power Post™ Stanchions

Power posts offer high strength solid aluminum construction and are used with flashing cones.

Part #	Description	Diameter	Quantity	Weight Per Unit (lbs.)	Price
PP3	3" Power Post	1.31"	1-49	0.55	20.50
			50-99		19.50
			100+		18.00
PP4	4" Power Post	1.31"	1-49	0.67	21.00
			50-99		20.00
			100+		18.50
PP5	5" Power Post	1.31"	1-49	0.81	21.50
			50-99		20.50
			100+		19.00
PP6	6" Power Post	1.31"	1-49	0.94	22.00
			50-99		21.00
			100+		19.50
PP7	7" Power Post	1.31"	1-49	1.1	22.50
			50-99		21.50
			100+		20.00

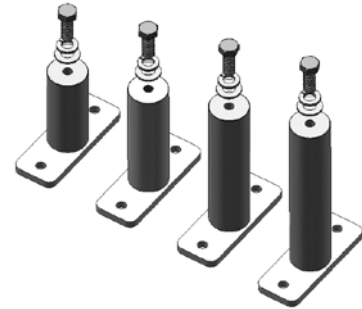

## Easy Power Post™ Stanchions

Part #	Description	Diameter	Quantity	Weight Per Unit (lbs.)	Price
EP3	3" Easy Post	1.31"	1-49	0.82	25.00
			50-99		24.00
			100+		22.50
EP4	4" Easy Post	1.31"	1-49	0.94	25.50
			50-99		24.50
			100+		23.00
EP5	5" Easy Post	1.31"	1-49	1.08	26.00
			50-99		25.00
			100+		23.50
EP6	6" Easy Post	1.31"	1-49	1.21	26.50
			50-99		25.50
			100+		24.00
EP7	7" Easy Post	1.31"	1-49	1.37	27.00
			50-99		26.00
			100+		24.50

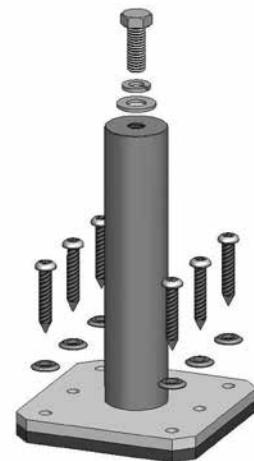

# Offset Power Post™ Stanchions

Offset Power Posts center the flashing cone and avoid potential gaps with the Power Post base.

Part #	Description	Diameter	Quantity	Weight Per Unit (lbs.)	Price
OP3	3" Offset Mounting Post	1.31"	1-49	0.55	20.50
			50-99		19.50
			100+		18.00
OP4	4" Offset Mounting Post	1.31"	1-49	0.67	21.00
			50-99		20.00
			100+		18.50
OP5	5" Offset Mounting Post	1.31"	1-49	0.81	21.50
			50-99		20.50
			100+		19.00
OP6	6" Offset Mounting Post	1.31"	1-49	0.94	22.00
			50-99		21.00
			100+		19.50
OP7	7" Offset Mounting Post	1.31"	1-49	1.1	22.50
			50-99		21.50
			100+		20.00

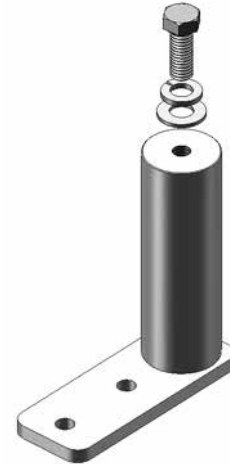

# Super Post™ Stanchions\*

Super posts offer high strength solid aluminum construction for larger arrays and higher roof clearance.

Part #	Description	Diameter	Quantity	Weight Per Unit (lbs.)	Price
SP7	7" Super Mounting Post	1.75"	1-49	2.4	40.50
			50-99		37.50
			100+		34.50
SP8	8" Super Mounting Post	1.75"	1-49	2.6	42.00
			50-99		39.00
			100+		36.00
SP9	9" Super Mounting Post	1.75"	1-49	2.9	43.50
			50-99		40.50
			100+		37.50
SP10	10" Super Mounting Post	1.75"	1-49	3.2	45.00
			50-99		42.00
			100+		39.00

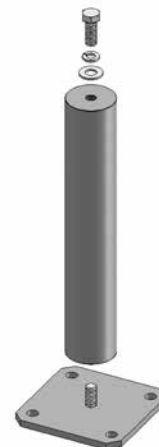

\*May also be used with the P14 Rail.

# Corrugated Roof Mounts

The CMB provides a mounting bridge over the peak of a metal corrugated roof keeping the penetration above the water diverting valleys. Includes Butyl Mastic, L-Foot not included.

Part #	Description	Quantity	Price
CMB	Mounting Bridge to Span Peaks of Corrugated Metal Roofs	1-49	13.50
		50-99	12.50
		100+	11.00

Note: Not all corrugated metal roofs are the same. Please contact DPW Solar to design mounting bridges that are specific to your application. Pricing subject to change. "L" Foot not included.

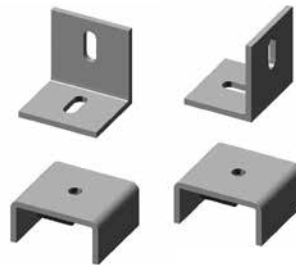

Includes Butyl Mastic, "L" Foot Ordered Separately

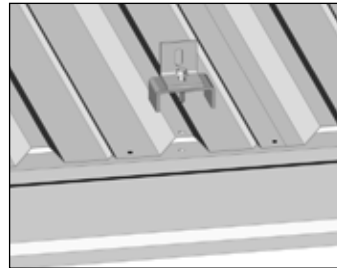

# Easy Tile Hook

The all stainless steel Easy Tile Hook attaches underneath concrete/clay tiles and sweeps out from underneath, allowing for a PV module installation without the need to penetrate tiles. Includes Butyl Mastic and RSS PHEinox™ screws.

Part #	Description	Quantity	Price
ETH	Easy Tile Hook	1-49	60.00
		50-99	57.50
		100+	55.00

RSS PHEinox™ screws are manufactured by GRK Fasteners.



# Power Rail™ Splice Plates

The Power Rail Splice Plates are made from High Strength Aluminum. Includes hardware.

## Splice Plates

Part #	Description	Quantity	Weight Per Unit (lbs.)	Price
P6-SPK	Splice Plate for P6 Two Hole	1-9	0.20	7.00
		10+		6.50
P6-4HSPK	Splice Plate for P6 Four Hole	1-9	0.40	14.00
		10+	0.40	13.00
P8-SPK	Splice Plate for P8	1-9	0.55	8.00
		10+		7.50
P14-SPK	Splice Plate for P14	1-9	1.00	21.00
		10+		20.00
LD-SPK	Splice Plate for LD	1-9	0.37	16.00
		10+		15.00
MD-SPK	Splice Plate for MD	1-9	0.40	18.50
		10+		17.50

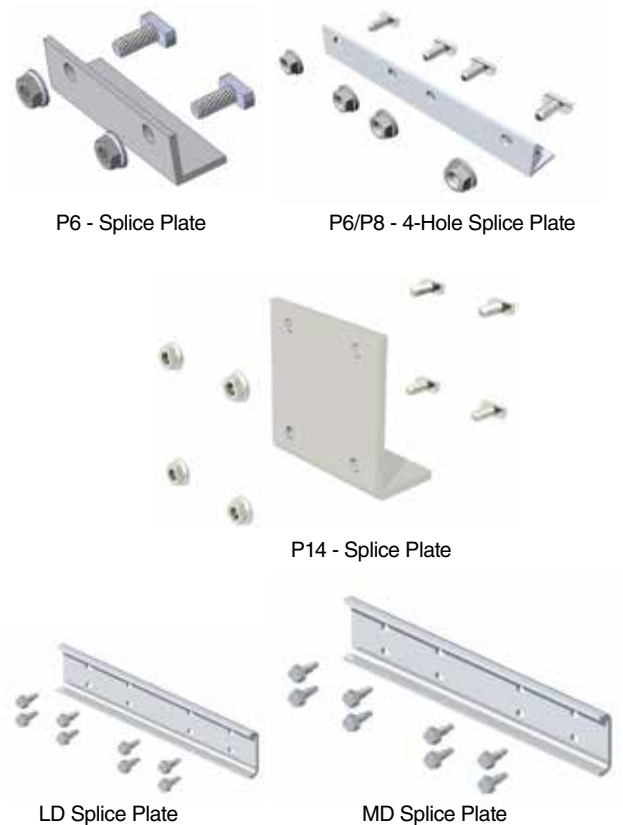

# Power Rail™ PV Flash

Power Rail PV Flash includes one universal slotted compression block, and one 8" x 12" flashing in matte, black color.

Part #	Attachment Hardware	Qty.	Shipping Weight Per Unit (lbs.)	Non-Discountable Price
PFU*	5/16" x 5" hangerbolt	10-49	0.80	14.00
		50-99		13.00
		100+		11.50
PVU*	Stainless Steel Base Plate and 3" Fasteners	10-49	1.00	16.00
		50-99		15.00
		100+		13.50

\*MUST order in quantities of 10.

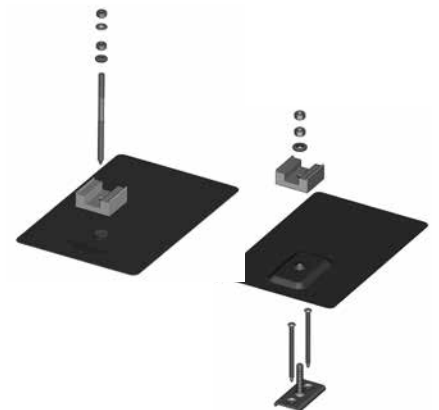

# Telescoping Tilt Kits

## P6 Low-Profile Telescoping Tilt Kits

Part #	Description	Quantity	Weight Per Unit (lbs.)	Price
P6-TL35	Telescoping legs that range from 20°–35°	1-49	9.0	135.00
		50-99		130.00
		100+		125.00
P6-TL45	Telescoping legs that range from 24°–45°	1-49	11.0	140.00
		50-99		135.00
		100+		130.00
P6-TL55	Telescoping legs that range from 28°–55°	1-49	13.0	145.00
		50-99		140.00
		100+		135.00
P6-TL65	Telescoping legs that range from 30°–65°	1-49	15.0	150.00
		50-99		145.00
		100+		140.00



P6 Low-Profile Telescoping Tilt Kit  
Includes Strong Back, Adjustable Leg, Mounting Feet, Rail Brackets and Hardware.

Module Mounting Rail not included

## P8 Low-Profile Telescoping Tilt Kits

Part #	Description	Quantity	Weight Per Unit (lbs.)	Price
P8-TL35	Telescoping legs that range from 20°–35°	1-49	10.0	155.00
		50-99		150.00
		100+		145.00
P8-TL45	Telescoping legs that range from 24°–45°	1-49	12.0	160.00
		50-99		155.00
		100+		150.00
P8-TL55	Telescoping legs that range from 28°–55°	1-49	14.0	165.00
		50-99		160.00
		100+		155.00
P8-TL65	Telescoping legs that range from 30°–65°	1-49	16.0	170.00
		50-99		165.00
		100+		160.00



P8 Low-Profile Telescoping Tilt Kit  
Includes Strong Back, Adjustable Leg, Mounting Feet, Rail Brackets and Hardware.

Module Mounting Rail not included

Note: Telescoping Tilt Kits include 3.5" "L" feet, Strongback, Telescoping leg, and Rail-to-Rail brackets.

# One-Piece Tilt Kits

## P6 Low-Profile One-Piece Tilt Kits

Part #	Description	Quantity	Weight Per Unit (lbs.)	Price
P6-OP15	One-Piece legs for a 15° tilt	1-49	6.5	85.00
		50-99		81.50
		100+		78.00
P6-OP25	One-Piece legs for a 25° tilt	1-49	7.0	90.00
		50-99		86.50
		100+		83.00
P6-OP35	One-Piece legs for a 35° tilt	1-49	7.5	95.00
		50-99		91.50
		100+		88.00
P6-OP45	One-Piece legs for a 45° tilt	1-49	8.0	100.00
		50-99		96.50
		100+		93.00
P6-OP55	One-Piece legs for a 55° tilt	1-49	8.5	105.00
		50-99		101.50
		100+		98.00
P6-OP65	One-Piece legs for a 65° tilt	1-49	9.0	110.00
		50-99		106.50
		100+		103.00



P6 Low-Profile One-Piece Tilt Kit  
Includes Strong Back, Fixed Leg, Mounting Feet, Rail Brackets and Hardware.

Module Mounting Rail not included

## P8 Low-Profile One-Piece Tilt Kits

Part #	Description	Quantity	Weight Per Unit (lbs.)	Price
P8-OP15	One-Piece legs for a 15° tilt	1-49	7.5	105.00
		50-99		101.50
		100+		98.00
P8-OP25	One-Piece legs for a 25° tilt	1-49	8.0	110.00
		50-99		106.50
		100+		103.00
P8-OP35	One-Piece legs for a 35° tilt	1-49	8.5	115.00
		50-99		111.50
		100+		108.00
P8-OP45	One-Piece legs for a 45° tilt	1-49	9.0	120.00
		50-99		116.50
		100+		113.00
P8-OP55	One-Piece legs for a 55° tilt	1-49	9.5	125.00
		50-99		121.50
		100+		118.00
P8-OP65	One-Piece legs for a 65° tilt	1-49	10.0	130.00
		50-99		126.50
		100+		123.00



P8 Low-Profile One-Piece Tilt Kit  
Includes Strong Back, Adjustable Leg, Mounting Feet, Rail Brackets and Hardware.

Module Mounting Rail not included

# Module Clamps with RAD™ Hardware

Module Clamps are Type 304 stainless steel for higher yield strength and durability. The low profile design and slim 3/8" gap between modules provide a professional appearance and higher module density.

## RAD End Clamp with RAD Bolt Hardware

Part #	Description	Quantity	Weight Per Unit (lbs.)	Price
EC- <input type="text"/> -RAD	Module End Clamp w/RAD Hardware	1-19	0.15	5.25
		20-39		5.05
		40-59		4.85
		60-79		4.65
		80-99		4.45
		100+		4.25



End Clamp w/RAD Bolt

Note: Replace  with module depth from the Solar Module Specification Sheet.  
 Example: EC-46-RAD end clamp for Sharp NU-U240F1 modules

Add "B" suffix to part number for black powder coat.  
 Example: EC-46-RAD-B. (Add 25% to price)

## RAD Mid Clamp with RAD Bolt Hardware

Part #	Description	Quantity	Weight Per Unit (lbs.)	Price
MC-28-33-RAD	Module Mid Clamp for 28-33 mm Thick Frame	1-49	0.08	4.50
		50-99		3.75
		100+		3.25
MC-34-39-RAD	Module Mid Clamp for 34-39 mm Thick Frame	1-49	0.08	4.50
		50-99		3.75
		100+		3.25
MC-40-46-RAD	Module Mid Clamp for 40-46 mm Thick Frame	1-49	0.08	4.50
		50-99		3.75
		100+		3.25
MC-47-52-RAD	Module Mid Clamp for 47-52 mm Thick Frame	1-49	0.08	4.50
		50-99		3.75
		100+		3.25
MC-53-59-RAD	Module Mid Clamp for 53-59 mm Thick Frame	1-49	0.08	4.50
		50-99		3.75
		100+		3.25



Mid Clamp w/RAD Bolt

RAD™ Fastener is now patented.



# Module Clamps with Carriage Bolts

## End Clamp with Carriage Bolt Hardware

Part #	Description	Quantity	Weight Per Unit (lbs.)	Price
EC- <input type="text"/> -CAR	Module End Clamp w/Carriage Bolt Hardware	1-19	0.15	5.25
		20-39		5.05
		40-59		4.85
		60-79		4.65
		80-99		4.45
		100+		4.25

Note: Replace  with module depth from the Solar Module Specification Sheet.  
 Example: EC-46-CAR end clamp for Sharp NU-U240F1 modules

Add "B" suffix to part number for black powder coat.  
 Example: EC-46-RAD-B. (Add 25% to price)

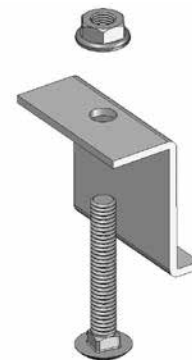

End Clamp w/Carriage Bolt

## Mid Clamp with Carriage Bolt Hardware

Part #	Description	Quantity	Weight Per Unit (lbs.)	Price
MC-28-33-CAR	Module Mid Clamp for 28-33 mm Thick Frame	1-49	0.08	4.50
		50-99		3.75
		100+		3.25
MC-34-39-CAR	Module Mid Clamp for 34-39 mm Thick Frame	1-49	0.08	4.50
		50-99		3.75
		100+		3.25
MC-40-46-CAR	Module Mid Clamp for 40-46 mm Thick Frame	1-49	0.08	4.50
		50-99		3.75
		100+		3.25
MC-47-52-CAR	Module Mid Clamp for 47-52 mm Thick Frame	1-49	0.08	4.50
		50-99		3.75
		100+		3.25
MC-53-59-CAR	Module Mid Clamp for 53-59 mm Thick Frame	1-49	0.08	4.50
		50-99		3.75
		100+		3.25



Mid Clamp w/Carriage Bolt

## Universal End Clamp

Part #	Description	Quantity	Weight Per Unit (lbs.)	Price
P6-ECU	Universal End Clamp w/Set Bolt for P6	1-49	0.15	9.00
		50-99		8.50
		100+		8.00
P8-ECU	Universal End Clamp w/Set Bolt for P8	1-49	0.25	10.00
		50-99		9.50
		100+		9.00

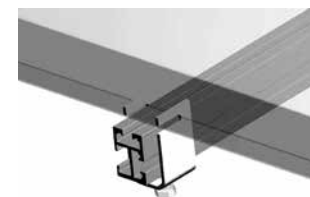

**NEW**

# Pre-Assembled Module Clamps with RAD™ Hardware

Module Clamps are Type 304 stainless steel for higher yield strength and durability. Pre-assembled module clamps feature no loose parts and a foam insert that keeps free standing clamps in place for a quicker module installation.

## Pre-Assembled End Clamp with RAD Bolt Hardware

Part #	Description	Quantity	Weight Per Unit (lbs.)	Price
PA- EC- <input type="text"/> -RAD	Pre-Assembled Module End Clamp w/RAD Hardware	1-19	0.15	6.30
		20-39		6.05
		40-59		5.85
		60-79		5.60
		80-99		5.35
		100+		5.10



Pre-Assembled End Clamp w/RAD Bolt

Note: Replace  with module depth from the Solar Module Specification Sheet.  
 Example: EC-46-RAD end clamp for Sharp NU-U240F1 modules

Add "B" suffix to part number for black powder coat.  
 Example: EC-46-RAD-B. (Add 25% to price)

## Pre-Assembled Mid Clamp with RAD Bolt Hardware

Part #	Description	Quantity	Weight Per Unit (lbs.)	Price
PA-MC-28-33-RAD	Pre-Assembled Module Mid Clamp for 28-33 mm Thick Frame	1-49	0.08	5.40
		50-99		4.50
		100+		3.90
PA-MC-34-39-RAD	Module Mid Clamp for 34-39 mm Thick Frame	1-49		5.40
		50-99		4.50
		100+		3.90
PA-MC-40-46-RAD	Module Mid Clamp for 40-46 mm Thick Frame	1-49		5.40
		50-99		4.50
		100+		3.90
PA-MC-47-52-RAD	Module Mid Clamp for 47-52 mm Thick Frame	1-49	5.40	
		50-99	4.50	
		100+	3.90	
PA-MC-53-59-RAD	Module Mid Clamp for 53-59 mm Thick Frame	1-49	5.40	
		50-99	4.50	
		100+	3.90	



Pre-Assembled Mid Clamp w/RAD Bolt

Note: Pre-assembled Mid Clamps provide for a 1/2" gap between modules.

**NEW**

# Pre-Assembled Module Clamps with RAD™ Hardware

## Pre-Assembled Mid Clamp with RAD Bolt Hardware and WEEB-DPR

Part #	Description	Quantity	Weight Per Unit (lbs.)	Price
PAW-MC-28-33-RAD	Pre-Assembled Module Mid Clamp for 28-33 mm Thick Frame	1-49	0.08	8.75
		50-99		7.85
		100+		7.25
PAW-MC-34-39-RAD	Module Mid Clamp for 34-39 mm Thick Frame	1-49		8.75
		50-99		7.85
		100+		7.25
PAW-MC-40-46-RAD	Module Mid Clamp for 40-46 mm Thick Frame	1-49		8.75
		50-99		7.85
		100+		7.25
PAW-MC-47-52-RAD	Module Mid Clamp for 47-52 mm Thick Frame	1-49		8.75
		50-99		7.85
		100+		7.25
PAW-MC-53-59-RAD	Module Mid Clamp for 53-59 mm Thick Frame	1-49		8.75
		50-99		7.85
		100+		7.25



Pre-Assembled Mid Clamp w/RAD Bolt and WEEB-DPR

Note: Pre-assembled Mid Clamps provide for a 1/2" gap between modules.

# Power Post Flashing

Part #	Attachment Hardware	Qty.	Weight Per Unit (lbs.)	Non-Discountable Price
OF*	Oatey Flashing with Rubber Boot for 1.31" posts	12-47	0.66	5.15
		48-95		4.40
		96+		3.90
SMF*	Aluminum One Piece Flashing	12-47	1.15	10.40
		48-95		8.90
		96+		7.85
RFC*	Rubber Flashing Collar	12-47	0.05	2.00
		48-95		1.75
		96+		1.55



**NOTE:** Oatey No-Calk® NC-1 Solar flashing are galvanized with a UV Rubber Boot that fits onto the Power Post. Oatey flashing may be used on roofs with 0-45 degree angles.

\*MUST order in quantities of 12

No-Calk® is a registered trademark of Oatey Co.

# Flat Roof Flashing

Part #	Description	Quantity	Weight Per Unit (lbs.)	Non-Discountable Price
LPK4*	4" Lockin' Pocket	6-47	1.7	15.50
		48-95		14.50
		96+		13.50
LPK6**	6" Lockin' Pocket	4-47	2.6	23.00
		48-95		21.50
		96+		20.50
HFUS	Hurricane Force Universal Sealer	1	-	27.75
BPAG	Battery Powered Applicator Gun	1	-	690.00

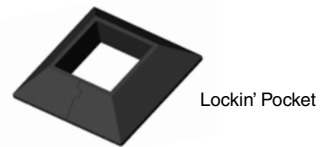

**NOTE:** Lockin' Pockets and Hurricane Force Sealer are backed by a third party warranty on all flat roof penetrations.

\*MUST order in quantities of 6

\*\*MUST order in quantities of 4

# Grounding Hardware

Part #	Description	Quantity	Weight Per Unit (lbs.)	Non-Discountable Price
WEEB-DPF*	Module Grounding Clip	10-99	.003	1.50
		100-999		1.10
		1000+		.90
WEEB-11.5*	Splice Plate Grounding Clip	10-99	.003	1.50
		100-999		1.10
		1000+		.90
WEEBL-8.0-KIT*	Rail Grounding Lug	10-99	0.19	5.65
		100+		4.65
WEEB-8.0-RBJ-KIT*	Rail Bonding Jumper	10-99	0.11	7.80
		100+		6.45
ACC-PV*	ACME PV Cable Clip	10-99	0.006	.52
		100-999		.41
		1000+		.33
ACC*	ACME – 2 Cable Clip	10-99	0.006	.52
		100-999		.41
		1000+		.33

**NOTE:** Cable Clips snugly hold 1 or 2 designated cables.  
 \*MUST order in quantities of 10



# Turn Bolts

Part #	Description	Quantity	Weight Per Unit (lbs.)	Price
TB	5/16" x 3/4" Stainless Steel Turn Bolt w/ Flange Nut	100+	0.05	1.65



# Wire Management Clip

Part #	Description	Quantity	Weight Per Unit (lbs.)	Price
P8-WC	Wire Management Clip	1-49	0.05	2.50
		50-99		2.25
		100+		2.00



# Rail Span and Cantilever Distances

## P6 Rail Span and Cantilever Distances (inches)

	SPAN/C'VER	SNOW LOAD (PSF)										
		0	10	20	30	40	50	60	70	80	90	100
WIND SPEED (MPH)*	90	72/36	60/32	54/26	48/24	43/21	40/20	36/18	33/16	31/15	29/14	28/14
	100	60/32	58/28	48/24	46/23	42/21	38/19	36/18	33/16	31/15	29/14	28/14
	110	58/28	54/26	48/24	44/22	40/20	37/18	35/17	33/16	31/15	29/14	28/14
	120	54/26	54/26	46/23	42/21	39/19	36/18	34/17	32/16	31/15	29/14	28/14
	130	48/24	48/24	44/22	40/20	37/18	35/17	33/16	32/16	30/15	29/14	28/14

\* Exposure C Category Only  
Please refer to design guidelines and ASCE requirements for more information.

## P8 Rail Span and Cantilever Distances (inches)

	SPAN/C'VER	SNOW LOAD (PSF)										
		0	10	20	30	40	50	60	70	80	90	100
WIND SPEED (MPH)*	90	96/48	92/46	80/40	72/36	66/33	62/31	58/29	52/26	50/25	46/23	44/22
	100	88/44	86/43	76/38	68/34	64/32	60/30	56/28	52/26	50/25	46/23	44/22
	110	80/40	80/40	72/36	66/33	62/31	58/29	54/27	52/26	50/25	46/23	44/22
	120	74/37	74/37	68/34	64/32	60/30	56/28	52/26	50/25	48/24	46/23	44/22
	130	68/34	68/34	66/33	60/30	56/28	54/27	52/26	48/24	46/23	44/22	44/22
	140	64/32	64/32	62/31	58/29	54/27	52/26	50/25	48/24	46/23	44/22	42/21
	150	60/30	60/30	60/30	56/28	52/26	50/25	48/24	46/23	44/22	42/21	42/21

\* Exposure C Category Only  
Please refer to design guidelines and ASCE requirements for more information.

## P14 Rail – Span/Cantilever Distances (inches)

	SPAN/C'VER	SNOW LOAD (PSF)										
		0	10	20	30	40	50	60	70	80	90	100
WIND SPEED (MPH)*	90	168/79	160/75	141/66	128/60	118/55	110/52	103/48	96/45	90/42	85/40	81/38
	100	153/72	150/71	134/63	123/58	113/53	106/50	100/47	95/45	90/42	85/40	81/38
	110	140/66	140/66	127/60	117/55	109/51	103/48	97/46	92/43	88/41	85/40	81/38
	120	129/61	129/61	121/57	112/53	105/49	99/47	94/44	90/42	86/40	83/39	80/38
	130	120/56	120/56	115/54	107/50	101/47	96/45	91/43	87/41	84/39	81/38	78/37
	140	112/53	112/53	109/51	103/48	97/46	93/44	88/41	85/40	82/39	79/37	76/36
	150	105/49	105/49	104/49	99/47	94/44	89/42	86/40	82/39	79/37	77/36	74/35

\* Exposure C Category Only  
Please refer to design guidelines and ASCE requirements for more information.

# Rail Span and Cantilever Distances

## LD RAIL – Span/Cantilever Specifications

	SPAN/C'VER	SNOW LOAD (PSF)										
		0	10	20	30	40	50	60	70	80	90	100
WIND SPEED* (MPH)	90	168/77	157/72	137/65	122/60	111/55	101/51	93/46	86/43	81/40	76/38	72/36
	100	158/72	151/69	131/63	118/59	108/54	100/50	93/46	86/43	81/40	76/38	72/36
	110	148/68	142/67	125/61	113/57	104/52	97/49	91/46	86/43	81/40	76/38	72/36
	120	136/65	134/64	120/59	109/55	101/51	95/47	89/45	85/42	81/40	76/38	72/36
	130	126/61	126/61	115/57	105/53	98/49	92/46	87/43	83/41	79/39	76/38	72/36
	140	118/59	118/59	110/55	101/51	95/47	89/45	85/42	81/40	77/39	74/37	71/36
	150	110/55	110/55	105/52	98/49	92/46	87/43	82/41	79/39	76/38	73/36	70/35

\* Exposure C Category Only  
Please refer to design guidelines and ASCE requirements for more information.

## MD RAIL – Span/Cantilever Specifications

	SPAN/C'VER	SNOW LOAD (PSF)										
		0	10	20	30	40	50	60	70	80	90	100
WIND SPEED* (MPH)	90	216/92	202/87	177/78	158/72	143/68	131/64	120/60	111/56	104/52	98/49	94/47
	100	203/87	195/83	170/76	152/71	139/67	129/63	120/60	111/56	104/52	98/49	94/47
	110	191/82	184/80	162/74	147/69	135/65	126/62	118/59	111/56	104/52	98/49	94/47
	120	176/78	174/77	155/71	141/67	131/64	122/61	115/58	109/55	104/52	98/49	94/47
	130	163/74	163/74	148/69	136/66	127/62	119/59	112/56	107/53	102/51	98/49	94/47
	140	152/71	152/71	142/67	131/64	123/61	116/58	110/55	104/52	100/50	96/48	93/46
	150	143/68	143/68	136/66	126/62	119/59	112/56	107/53	102/51	98/49	94/47	91/45

\* Exposure C Category Only  
Please refer to design guidelines and ASCE requirements for more information.



**DPW | SOLAR**



**PREFORMED** LINE PRODUCTS

Direct Power & Water Corporation  
4000-B Vassar Drive NE  
Albuquerque, New Mexico 87107 USA

Telephone: 505.889.3585  
Toll Free: (800) 260.3792  
Fax: 505.889.3548  
Web site: [www.DPWSolar.com](http://www.DPWSolar.com)  
Email: [info@power-fab.com](mailto:info@power-fab.com)

Preformed Line Products  
(Canada) Limited  
1711 Bishop St. E  
Cambridge, ON N1T 1N5

Telephone: 519-740-6666  
Fax: 519-740-7917  
Web site: [www.preformed.on.ca](http://www.preformed.on.ca)  
Email: [sales@preformed.on.ca](mailto:sales@preformed.on.ca)