

Rigid/Intermediate Grade Conduit Fittings

Conduit Bushed (Chase) Nipples Offset Conduit Nipples

CONDUIT BUSHED (CHASE) NIPPLES – MALLEABLE IRON & ZINC DIE CAST

Non-insulated and Insulated Threaded NPSM for Rigid Conduit and IMC

UL File No. E-19189†

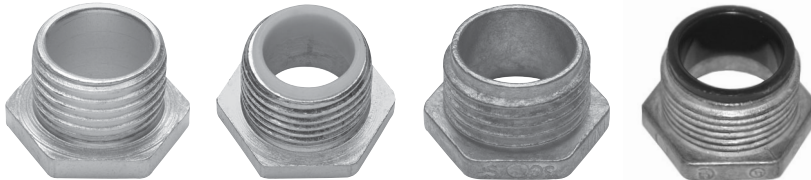

Applications:

- Used through knockout to connect box to conduit coupling
- Used with a locknut to connect two boxes side by side or back to back
- Used with a locknut to connect fixture housing to continuous runs

Rigid Fittings

Cat. # Non-insulated Malleable Iron	Cat. # Insulated Malleable Iron	Cat. # Non-insulated Zinc Die Cast	Cat. # Insulated Zinc Die Cast	Size	Unit Qty.	Wt. Lbs. Per 100 Non-insulated Malleable Iron	Wt. Lbs. Per 100 Insulated Malleable Iron	Wt. Lbs. Per 100 Non-insulated Zinc Die Cast
50*		50D	1050DC	1/2"	50	3	3	4
51	1051	51D	1051DC	3/4"	25	8	4	5
52	1052	52D	1052DC	1"	10	13	11	10
53	1053	53D	1053DC	1 1/4"	10	19	19	11
54	1054	54D	1054DC	1 1/2"	10	30	30	20
55	1055	55D	1055DC	2"	10	37	37	30
56	1056	56D	1056DC	2 1/2"	5	68	72	40
57	1057	57D	1057DC	3"	5	92	96	49
58	1058	58D	1058DC	3 1/2"	1	130	113	68
59	1059	59D	1059DC	4"	1	200	187	70
60†	1060			5"	1	350	350	
61†	1061			6"	1	425	450	

*Steel.

†Not UL Listed.

‡cUL Listed for malleable iron versions.

OFFSET CONDUIT NIPPLES – MALLEABLE IRON & ZINC DIE CAST

Features:

- Threaded NPSM for rigid conduit and IMC
- Standard finish on malleable iron: zinc plated
- Used to offset the axis of raceways 3/4 of an inch

UL File No. E-19189

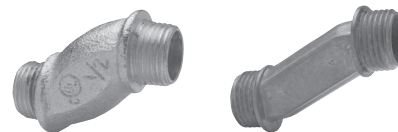

Cat. # Malleable Iron	Cat. # Zinc Die Cast	Size	Unit Qty.	Wt. Lbs. Per 100
300	300DC	1/2"	25	24
301	301DC	3/4"	25	34
302	302DC	1"	10	49
303	303DC	1 1/4"	10	54
	304DC	1 1/2"	5	40
	305DC	2"	2	60