





# UL 98 Fused Rotary Disconnect Switches—30 to 800A

## Specifications

					
	RDF30CC-3	RDF30J-3 / RDF60J-3-COMP	RDF60J-3	RDF200J-3	RDF600J-3
<b>Part Number</b>					
<b>2-Pole</b>	—	—	RDF30J-2	RDF60J-2-COMP	RDF60J-2
<b>3-Pole</b>	RDF30CC-3	RDF30J-3-COMP	RDF30J-3	RDF60J-3-COMP	RDF60J-3
<b>3-Pole + Neutral</b>	RDF30CC-3N	RDF30J-3N-COMP	—	—	—
<b>4-Pole</b>	—	—	RDF30J-4	RDF60J-4-COMP	RDF60J-4
UL Standard	UL 489	UL 489	UL 98	UL 98	UL 98
Fuse Class	CC	J	J	J	J
Max Fuse/Ampacity	30	30	30	60	60
Switch Type	Compact	Compact	Standard	Standard	Standard
Handle Operation	Front	Front	Front/Side Flange	Front/Side Flange	Front/Side Flange
<b>UL Electrical Ratings</b>					
Max AC Volts	600Vac	600Vac	600Vac	600Vac	600Vac
Max DC Volts*	—	—	250Vdc	250Vdc	250Vdc
Std AC Horsepower Ratings					
1-Phase, 240Vac	—	—	3	10	10
3-Phase, 240Vac	3	3	3	7.5	15
3-Phase, 480Vac	5.0	5.0	5.0	15	25
3-Phase, 600Vac	7.5	7.5	7.5	15	30
Max AC Horsepower Ratings					
3-Phase, 240Vac	7.5	7.5	7.5	15	30
3-Phase, 480Vac	15	15	15	30	60
3-Phase, 600Vac	20	20	20	50	75
DC Horsepower Ratings					
125Vdc	—	—	3	5	7.5
250Vdc	—	—	5	10	20
<b>Electrical Characteristics</b>					
SCCR	100kA	100kA	200kA	100kA	200kA
Terminal Lugs/Kits	Integral	Integral	Integral	Integral	Integral
Mounting Torque - Lb-In (N·m)	—	—	—	—	160 (18)
Wire Type	75°C Cu	75°C Cu	75°C Cu	75°C Cu	75°C Cu/Al
Wire Range & Torque - Lb-In (N·m)					
Solid	#14-10 27 (3.1)	#14-10 27 (3.1)	#14-10 31 (3.5)	#14-10 31 (3.5)	#12-10 35.4 (4)
Stranded	#14-10 27 (3.1)	#14-10 27 (3.1)	#14-6 31 (3.5)	#14-6 31 (3.5)	#12-1 35.4 (4)
<b>Mechanical Characteristics</b>					
Endurances/Cycles	10,000	10,000	10,000	10,000	10,000
<b>Physical Characteristics</b>					
Dimensions					
See drawings on product pages					
Weight - Lbs (KG)					
2-Pole	—	—	3.0 (1.3)	3.1 (1.4)	4.0 (1.8)
3-Pole	1.3 (0.6)	1.4 (0.6)	3.8 (1.7)	4.1 (1.8)	5.3 (2.4)
3-Pole + Neutral	1.4 (0.6)	1.5 (0.7)	—	—	—
4-Pole	—	—	4.7 (2.1)	4.8 (2.2)	X.X (2.9)
<b>Environmental</b>					
Operating Temp. Range	-20°C to 70°C	-20°C to 70°C	-20°C to 70°C	-20°C to 70°C	-20°C to 70°C
Flammability Rating	UL 94-V0	UL 94-V0	UL 94-V0	UL 94-V0	UL 94-V0
<b>Accessories</b>					
Lug Kit	Integral	Integral	Integral	Integral	Integral
Handles					
Direct	•	•	•	•	•
Front Selector	•	•	—	—	—
Front Pistol	•	•	•	•	•
Side Pistol	—	—	•	•	•
Flange					
Cable	—	—	•	•	•
Shaft	—	—	•	•	•
NFPA Through Door Handle	•	•	•	•	•
Shafts c/s - mm	5x5	5x5	10x10	10x10	10x10
Terminal Shrouds	Not Required	Not Required	Not Required	Not Required	Not Required
Auxiliary Contacts					
(1) NO	•	•	•	•	•
(1) NC	•	•	•	•	•
AC Ratings					
Volts	600	600	600	600	600
Amps	10	10	10	10	10

Disconnect  
Switches

• Available, see product page for details and part numbers.

— Not available.

\* General purpose only, not photovoltaic rated.

# UL 98 Fused Rotary Disconnect Switches—600 & 800A

## Standard Class J & Class L

For a Complete Assembly, Please Select:

Select for Standard Applications		<b>Switch</b>							
		<b>Amp Rating</b>	<b>Fuse Class</b>	<b>Number of Poles</b>	<b>SCCR</b>	<b>Max Horsepower Rating, 3-Phase</b>			<b>Part Number</b>
						<b>220/240Vac</b>	<b>440/480Vac</b>	<b>600Vac</b>	
		600	J	2	200kA	-	-	-	RDF600J-2
		600	J	3	200kA	200	400	500	RDF600J-3
		600	J	4	200kA	200	400	500	RDF600J-4
		800	L	2	200kA	-	-	-	RDF800L-2
		800	L	3	200kA	200	500	500	RDF800L-3
		800	L	4	200kA	200	500	500	RDF800L-4
		<b>Terminal Lug Kit</b>							
<b>Switch Amp Rating</b>	<b>Number of Poles</b>	<b>Lugs Per Kit</b>	<b>Wire Range</b>			<b>Wire Type</b>	<b>Part Number</b>		
600-800	2	2	(2) #2-600MCM			75°C Cu/Al	LUG5-2		
600-800	3	3	(2) #2-600MCM			75°C Cu/Al	LUG5-3		
600-800	4	4	(2) #2-600MCM			75°C Cu/Al	LUG5-4		
+									
Accessories		<b>Direct Mount Handle - mounts directly to switch, no shaft required</b>							
		<b>For Switch Part Number</b>		<b>Color</b>	<b>Test Function</b>	<b>Padlockable</b>		<b>Part Number</b>	
		All Switches		Black	Y	Y		DIR-08	
		OR							
		<b>External Front Operated Pistol Handles - shaft required</b>							
		<b>NEMA Type</b>		<b>Color</b>	<b>Test Function</b>	<b>Padlockable</b>	<b>Defeatable</b>	<b>Part Number</b>	
		1, 3R, 4, 4X, 12		Black	N	Y	Y	H4X-07B	
		1, 3R, 4, 4X, 12		Red/Yellow	N	Y	Y	H4X-07R	
		<b>Metallic Hasp (Heavy Duty) External Front Operated Pistol Handles - shaft required</b>							
		<b>NEMA Type</b>		<b>Color</b>	<b>Test Function</b>	<b>Padlockable</b>	<b>Defeatable</b>	<b>Part Number</b>	
1, 3R, 4, 4X, 12		Black	N	Y	Y	H4X-07BHD			
1, 3R, 4, 4X, 12		Red/Yellow	N	Y	Y	H4X-07RHD			
<b>Shafts for Pistol Handles</b>									
<b>Length in (mm)</b>	<b>Mounting Depth (X) in (mm)</b>					<b>Part Number</b>			
7.9 (200)	10.63~11.97 (270~304)					SH7-200			
12.6 (320)	10.63~16.69 (270~424)					SH7-320			
15.7 (400)	10.63~19.84 (270~504)					SH7-400			
OR									
Accessories		<b>NFPA Through the Door Handle Kit - to be used with front pistol handle</b>							
		<b>For Switch Part Number</b>		<b>Color</b>	<b>Test Function</b>	<b>Padlockable</b>	<b>Defeatable</b>	<b>Part Number</b>	
		All Switches		Red	N	Y	N	H79-4	
		and ...							
		<b>Auxiliary Contacts</b>							
		<b>Contact Type</b>	<b>Number of Contacts</b>	<b>Continuous Amp Rating</b>	<b>Voltage Rating</b>	<b>Max Number of Aux Contacts per Switch</b>		<b>Part Number</b>	
		NO	1	10A	600Vac	8		BAC05	
		NC	1	10A	600Vac	8		BAC06	
		and ...							
		Accessories		<b>Terminal Shrouds - includes terminal shroud for lineside or loadside</b>					
<b>Switch Amp Rating</b>	<b>Number of Poles</b>						<b>Part Number</b>		
600-800	2						TSH10-2TB		
600-800	3						TSH10-3TB		
600-800	4				TSH10-4TB				

# UL 98 Fused Rotary Disconnect Switches—600 & 800A

## Standard Class J & Class L

### Dimensions – in (mm)

- RDF600J-3 • RDF800L-3

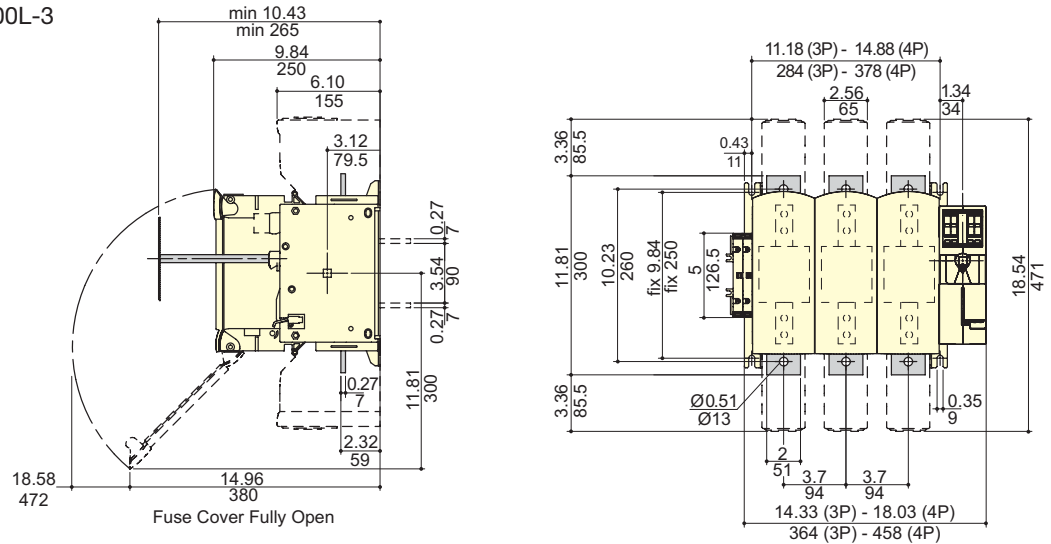

### Direct Mount Handle

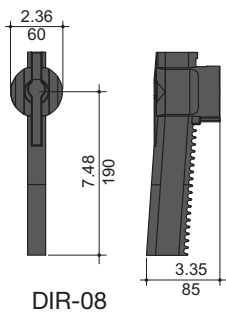

### External Front Pistol Handle

#### Handle Type

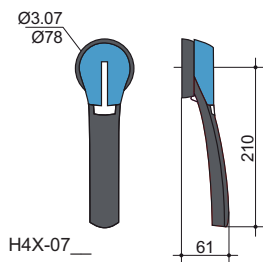

#### Direction of Front Operation

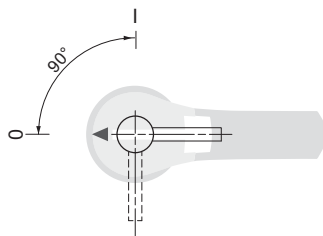

#### Door Drilling Layout

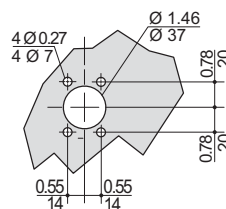

### Terminal Lugs

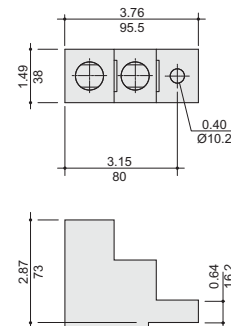

600 to 800A

LUG5-\_\_

Disconnect Switches

# UL 98 Enclosed Fused Disconnects—30 to 800A

## 3-Pole UL 98 600Vac

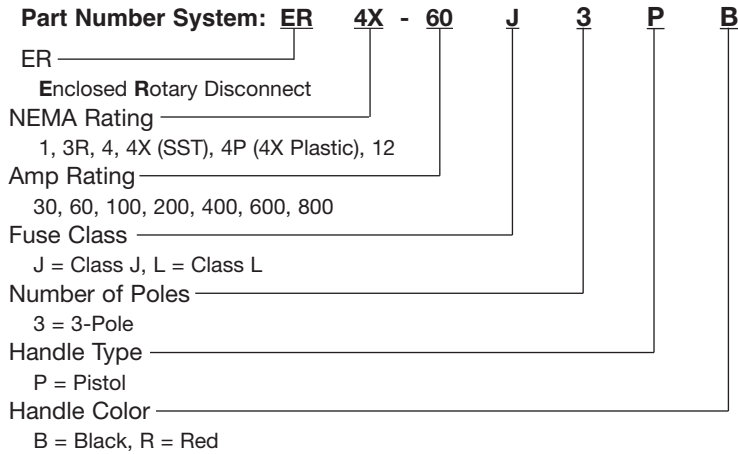

**Part Numbers** - All part numbers provided with integral or installed lugs and a black selector handle. Order red/yellow handle by changing the suffix “B” to “R.”

UL General Purpose Amp Rating	Fuse Type	NEMA Enclosure Type & Part Number					
		1	3R	4	4X Plastic <sup>(1)</sup>	4X Stainless	12
30	J	ER1-30J3PB	ER3R-30J3PB	ER4-30J3PB	ER4P-30J3PB	ER4X-30J3PB	ER12-30J3PB
60	J	ER1-60J3PB	ER3R-60J3PB	ER4-60J3PB	ER4P-60J3PB	ER4X-60J3PB	ER12-60J3PB
100	J	ER1-100J3PB	ER3R-100J3PB	ER4-100J3PB	ER4P-100J3PB	ER4X-100J3PB	ER12-100J3PB
200	J	ER1-200J3PB	ER3R-200J3PB	ER4-200J3PB	ER4P-200J3PB	ER4X-200J3PB	ER12-200J3PB
400	J	ER1-400J3PB	ER3R-400J3PB	ER4-400J3PB	ER4P-400J3PB	ER4X-400J3PB	ER12-400J3PB
600	J	ER1-600J3PB	ER3R-600J3PB	ER4-600J3PB	ER4P-600J3PB	ER4X-600J3PB	ER12-600J3PB
800	L	ER1-800L3PB	ER3R-800L3PB	ER4-800L3PB	ER4P-800L3PB	ER4X-800L3PB	ER12-800L3PB

(1) Enclosures ≤100A are polycarbonate, flammability rating UL 94-5VA-V0, ≥200A are fiberglass, flammability rating UL 94-5V.

**Switch Ratings** - for wire types, ranges and tightening torques, see table on page 387

Switch Amp Rating	Disconnect Switch	Fuse Type	No. of Poles	Voltage		SCCR @ Vac	Max Hp Rating @ 600Vac
				Vac	Vdc		
30	RDF30J-3	J	3	600	250	200kA	20
60	RDF60J-3	J					50
100	RDF100J-3	J					75
200	RDF200J-3	J					150
400	RDF400J-3	J					350
600	RDF600J-3	J		600	500		
800	RDF800L-3	L					