



Non-Metallic Push-In Connectors

For NM and flexible cord.



NM840



NM841

CATALOG NUMBER	UPC/DCI/NAED MFG #018997	TRADE SIZE	KO SIZE	UNIT PKG	STD PKG	DIM A	DIM B	DIM C
NM840	54840	3/8	1/2	100	1000	1.031	.375	.965
NM841	54841	1/2	1/2	50	500	1.340	.475	1.125
NM842	54842	3/4	3/4	25	250	1.510	.475	1.200
NM843	54843	1	1	25	250	1.637	.475	1.500
NM844	50175	1-1/4	1-1/4	10	100	2.085	.475	2.012

Refer to pages C-13 and C-14 for complete cable ranges.



E28474 LR49636

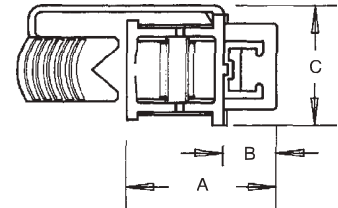

Installation Instructions

1. Disconnect electrical power. Push the connector into knockout.
2. Install required cables or cords.
3. Place wedge in connector slot and lock tight with a pair of pliers. Tightened wedge provides strong, positive grip.

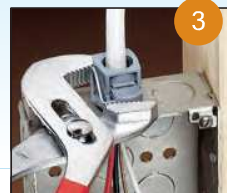

Non-Metallic Cable Connectors

For non-metallic sheathed cable. One piece construction. Listed for 1 or 2 cables. Holds cables securely and handles a wide range of cable sizes.



CATALOG NUMBER	UPC/DCI/NAED MFG #018997	TRADE SIZE	KO SIZE	UNIT PKG	STD PKG	DIM A	DIM B	DIM C
NM74	54510	3/8	1/2	100	1000	1.289	1.029	.875
NM75	54513	3/4	3/4	25	250	1.289	1.271	1.117

Refer to pages C-12 and C-13 for complete cable ranges.



E28474 LR49636

