



Arlington

Pipe Hangers *New!*

One-piece.
Non-metallic. UV rated.



NM1000



NM2000



NM2080

CATALOG	UPC/DCI/NAE	RIGID	EMT	LT	FLEX	ENT	COPPER	COPPER	STD	DIM	DIM	DIM	
NUMBER	MFG #	018997	SIZE*	SIZE	SIZE	SIZE	SIZE	TUBING	PIPE	PKG	A	B	C
NM1000	54615	-	-	-	-	-	-	-	-	100	1.563	.777	1.563
NM1900	54514	-	-	-	5/16	-	1/2	-	-	100	.844	.668	1.270
NM2000	54515	-	-	1/2	3/8	-	-	3/8	-	100	.922	.795	1.412
NM2005	54525	1/2	1/2	-	1/2	1/2	-	1/2	-	100	1.077	.795	1.588
NM2010	54516	-	-	3/4	-	-	3/4	-	-	100	1.178	.800	1.667
NM2015	54526	3/4	3/4	-	3/4	3/4	-	3/4	-	100	1.277	.800	1.826
NM2020	54517	-	-	1	-	-	1	-	-	100	1.377	.790	1.983
NM2025	54518	1	1	-	1	1	-	1	-	100	1.582	.830	2.180
NM2030	54528	-	-	1-1/4	-	-	1-1/4	-	-	100	1.700	.820	2.346
NM2040	54519	1-1/4	1-1/4	1-1/2	-	-	1-1/2	1-1/4	-	100	1.830	.830	2.523
NM2045	54544	1-1/2	1-1/2	-	1-1/2	-	-	1-1/2	-	100	2.212	.860	2.846
NM2150	54547	-	-	-	-	-	2	-	-	50	2.640	.910	3.100
NM2050	54520	2	2	2	2	-	-	2	-	50	3.020	.910	3.470
NM2060	54521	2-1/2	2-1/2	2-1/2	2-1/2	-	-	-	-	50	3.460	1.115	5.095
NM2070	54522	3	3	3	3	-	-	-	-	25	4.224	1.362	6.153
NM2080	54523	3-1/2	3-1/2	3-1/2	3-1/2	-	-	-	-	25	4.720	1.548	7.000
NM2090	54524	4	4	4	4	-	-	-	-	10	5.365	1.743	7.850



E161207 LR49636

* Rigid sizes also same for IMC and PVC.
For additional information on QuickLATCH plumbing applications, call or visit our website.

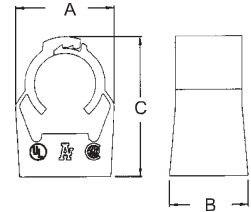

Features and Benefits

- Saves 25 seconds per installation...over 20¢ at \$30.00 per hour labor rate
- Costs the same as a steel pipe hanger with bolt and nut
- Conduit snaps into place, locking automatically
- Accommodates thinwall, rigid conduit, PVC conduit, or copper
- Mounts horizontally or vertically
- UV rated for outdoor application
- Corrosion resistant
- Listed for use in environmental air handling spaces per 2011 NEC code requirement 300-22(c)
- 2-1/2" to 4" hangers feature tabs with openings for the optional securing of a cable tie

Installation Instructions

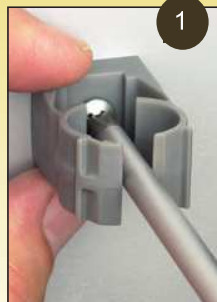

To Remove

Use a screwdriver to lift tab.

1. Mount to wall, strut, stud, or threaded rod up to 1/4-20
2. Press pipe down firmly into QuickLATCH to lock it in place
3. That's it!

Scan For Video



Rigid • IMC Fittings