

Combination Threaded Rigid and Set-Screw EMT

90° pulling elbows with cover and gasket. Zinc die-cast.



CATALOG NUMBER	UPC/DCI/NAED MFG #018997	Trade Size	UNIT PKG	STD PKG	DIM A	DIM B
HL5000	83105	1/2	10	100	2.150	2.150
HL7500	83175	3/4	5	50	2.300	2.300
HL100	50171	1	5	25	3.040	3.040
HL125	50173	1-1/4	2	10	3.900	3.900

See hub illustration below.

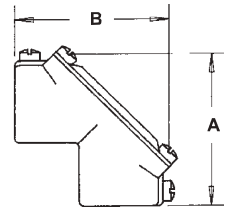

Combination Threaded Rigid and Set-Screw EMT To Box

90° pulling elbows with cover and gasket. Zinc die-cast.



CATALOG NUMBER	UPC/DCI/NAED MFG #018997	Trade Size	UNIT PKG	STD PKG	DIM A	DIM B
9100	91005	1/2	5	50	2.030	1.945
9110	91100	3/4	5	50	2.260	2.140
9120	50165	1	5	25	2.610	2.610
9130	50167	1-1/4	2	10	3.037	3.037

See hub illustration below.

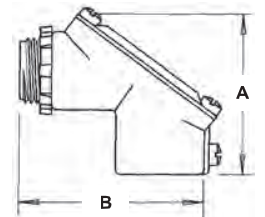

Hub Illustration

For Combination Threaded and Set-Screw Pull Elbows

Arlington's combination hubs are threaded for rigid and include set-screws for EMT. The set-screws may be used for rigid, but are not necessary. They are listed rain tight with rigid and concrete tight when taped for EMT. These products can also be used for EMT to rigid.

