

## Duplex Connector

Zinc die-cast. Single screw for Flex • AC • MCI • MCI-A • NM cable.



CATALOG NUMBER	UPC/DCI/NAE MFG #018997	TRADE SIZE	KO SIZE	UNIT PKG	STD PKG	DIM A	DIM B	DIM C	DIM D	CABLE RANGE
846	00846	3/8	1/2	25	250	1.542	.437	.888	1.672	.150-.612

Refer to chart on page E-22 for a list of cable types.  
Refer to chart on page E-25 for MCI-A cable ranges.  
Concrete tight when taped.

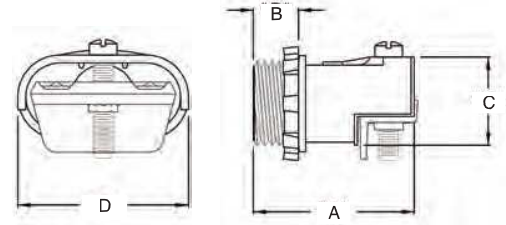

## Duplex SNAP-TITE® Connectors

Zinc die-cast. Single screw for Flex • AC • MCI • MCI-A • NM cable.



CATALOG NUMBER	UPC/DCI/NAE MFG #018997	TRADE SIZE	KO SIZE	UNIT PKG	STD PKG	DIM A	DIM B	DIM C	DIM D	CABLE RANGE
846ST‡	80050	3/8	1/2	25	250	1.635	.510	.888	1.654	.150-.612
846AST*	80052	3/8	1/2	25	250	1.728	.603	.888	1.654	.150-.612

\*Provided with insulated throat.

‡Also for MCI-A cable.

Refer to page E-27 for cable ranges.

Refer to chart on page E-24 for a list of cable types.

SNAP-TITE® products have been tested and listed by UL in accordance with UL's ground fault requirements. For additional information see page 6.

Concrete tight when taped.

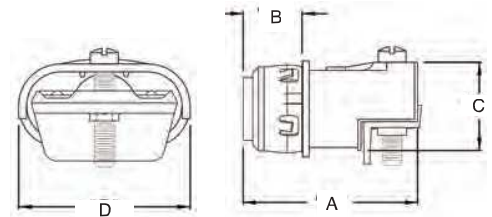

## Duplex Connector

Twin screw with steel strap.  
Zinc die-cast.  
For Flex • NM • AC • MCI steel and aluminum jacketed cables.



CATALOG NUMBER	UPC/DCI/NAE MFG #018997	TRADE SIZE	KO SIZE	UNIT PKG	STD PKG	DIM A	DIM B	DIM C	DIM D	CABLE RANGE
846SS	80054	3/8	1/2	25	250	1.562	.437	.888	2.200	.210-.612

Refer to chart on page E-22 for a list of cable types.

Concrete tight when taped.

