



## Cable Connectors

AC • MCI • NM • SE.

Zinc die-cast.



840



8400



8401

CATALOG NUMBER	UPC/DCI/NAED MFG #018997	KO SIZE	UNIT PKG	STD PKG	DIM A	DIM B	DIM C	CABLE RANGE	END STOP DIAMETER
840‡	00840	1/2	100	1000	.350	.825	1.085	.225-.612	.400 x .580
8400‡	08400	1/2	100	1000	.350	.825	1.085	.225-.612	.400
8401	08401	1/2	100	1000	.500	.825	1.085	.225-.612	.375
8402	08402	3/4	50	500	.533	1.093	1.386	.525-.780	.620
8403*	08403	1	25	250	.428	1.072	1.500	.780-.980	.840
8404*	08404	1-1/4	10	100	.490	1.144	1.872	1.050-1.345	1.030
8405*	08405	1-1/2	10	50	.625	1.357	2.120	1.410-1.633	1.390
8407*	08407	2	10	50	.652	1.434	2.594	1.640-2.040	1.750
8408*	72166	2-1/2	-	10	.968	1.965	3.235	1.950-2.480	1.924
8409*	72168	3	-	5	1.125	2.180	3.890	2.420-3.070	2.390
8410*	72170	3-1/2	-	5	1.125	2.284	4.392	2.860-3.600	2.830

\*Listed for MC only. UL# E123751.

‡Also for MCI-A cable. Refer to page E-25 for cable ranges.

Refer to chart on page E-23 for a list of cable types.

Refer to E-9 for new MC cable connectors with our largest cable ranges.

Concrete tight when taped.



E123751 LR49636



840



8400



8401



8402-8410

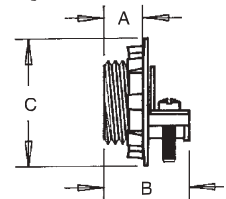

## SNAP-TITE® Connectors

With spring steel clip.

Zinc die-cast.

For NM • SE • MCI • MCI-A •

Flex • AC steel and aluminum jacketed cables.



840ST



8400ST

CATALOG NUMBER	UPC/DCI/NAED MFG #018997	TRADE SIZE	KO SIZE	UNIT PKG	STD PKG	DIM A	DIM B	DIM C	CABLE RANGE	END STOP DIAMETER
840ST	80070	3/8	1/2	100	1000	.510	.985	.912	.225-.612	.400 X .580
8400ST	80074	3/8	1/2	100	1000	.510	.985	.912	.225-.612	.375

Refer to chart on page E-23 for a list of cable types.

Refer to chart on page E-25 for MCI-A cable ranges.

Concrete tight when taped.

SNAP-TITE® products have been tested and listed by UL in accordance with UL's ground fault requirements. For additional information see page 6.



E18304 LR49636

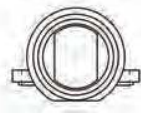

840ST



8400ST

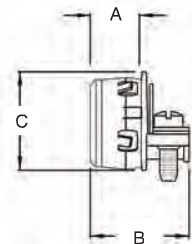

Flex • AC • MC