

Low Profile IN-AND-OUT™ COVERS for New or Existing Construction

Low profile when not in use and a deeper, weatherproof-in-use cover when cord is plugged in. Non-metallic cover and base. Comes in clear or textured/paintable white. UV rated plastic for long outdoor life.



60VC

Features and Benefits

- Low profile when not in use – weatherproof-while-in-use
- IN position provides a sealed box to keep bugs out
- Extends quickly and easily into the OUT position to accommodate a plug
- Fits over all boxes or openings in new or existing projects
- The 61 Series has an installed, oversized base for large openings or a 3.5" round outlet box
- Installed gaskets
- Install option: Cover is removable for easier device installation
- Vertical and horizontal styles

Note: Meets 2011 NEC Section 406-9; for the protection of exterior outlets which require the use of a weatherproof while-in-use cover for all outdoor 15 or 20 AMP receptacles.

CATALOG NUMBER	UPC/MFG #	DCI/NAED ORIENTATION	UNIT	STD	DIM A	DIM B	DIM C	DIM D	DIM E
60VC	00682	Vertical/Clear	1	4	6.2743.7521.6703.005	-	-	-	-
60VW	00680	Vertical/White	1	4	6.2743.7521.6703.005	-	-	-	-
61VC	00683	Vertical/Clear	1	4	6.2743.7521.6703.005	5.561	4.250	-	-
61VW	00681	Vertical/White	1	4	6.2743.7521.6703.005	5.561	4.250	-	-
60HC	00686	Horizontal/Clear	1	4	4.1925.8361.6703.005	-	-	-	-
60HW	00684	Horizontal/white	1	4	4.1925.8361.6703.005	-	-	-	-
61HC	00687	Horizontal/Clear	1	4	4.1925.8361.6703.005	4.250	5.561	-	-
61HW	00685	Horizontal/white	1	4	4.1925.8361.6703.005	4.250	5.561	-	-



E170558 LR49636

WEATHERPROOF-IN-USE

IN AND OUT COVER includes...

Low profile cover, (1) standard duplex and (1) standard GFCI face plate, installation screws, and installed gaskets.

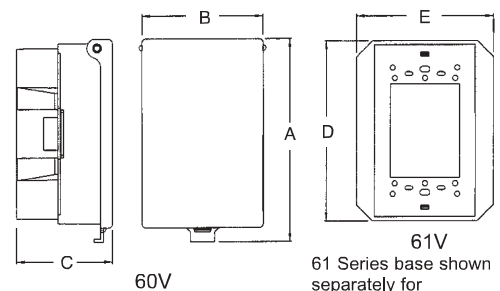

61V
61 Series base shown separately for dimensional purposes only.

Installation Instructions

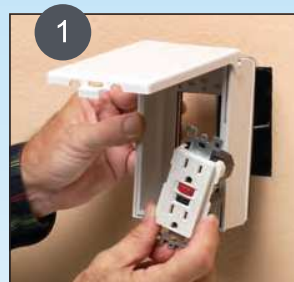

1 Feed device through opening (cover is removable for easier access).



2 Install wiring device per manufacturer's instructions, Local and National Electrical Codes using the pre-drilled holes in base.

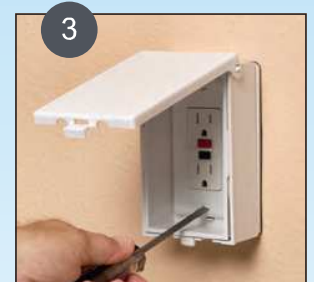

3 Install plate and the installation is done!



IN for **GOOD LOOKS** and to stay bug free... (60VW shown)



OUT to **PLUG IN** for weatherproof-in-use! (61HW shown)



To close: Bow out sides of extended cover and push in.