

Low Profile IN-AND-OUT™ COVERS for New or Existing Construction

Low profile when not in use and a deeper, weatherproof-in-use cover when cord is plugged in. Non-metallic cover and base. Comes in clear or textured/paintable white. UV rated plastic for long outdoor life.



60VC

Features and Benefits

- Low profile when not in use – weatherproof-while-in-use
- IN position provides a sealed box to keep bugs out
- Extends quickly and easily into the OUT position to accommodate a plug
- Fits over all boxes or openings in new or existing projects
- The 61 Series has an installed, oversized base for large openings or a 3.5" round outlet box
- Installed gaskets
- Install option: Cover is removable for easier device installation
- Vertical and horizontal styles

Note: Meets 2011 NEC Section 406-9; for the protection of exterior outlets which require the use of a weatherproof while-in-use cover for all outdoor 15 or 20 AMP receptacles.

| CATALOG NUMBER | UPC #018997 | DCI/NAED COVER | ORIENTATION | UNIT | STD | DIM A | DIM B | DIM C | DIM D | DIM E |
|----------------|-------------|------------------|-------------|------|-----|--------|-------|--------|-------|-------|
| 60VC | 00682 | Vertical/Clear | | 1 | 4 | 6.2743 | 7.521 | 1.6703 | 0.005 | - |
| 60VW | 00680 | Vertical/White | | 1 | 4 | 6.2743 | 7.521 | 1.6703 | 0.005 | - |
| 61VC | 00683 | Vertical/Clear | | 1 | 4 | 6.2743 | 7.521 | 1.6703 | 0.005 | 5.561 |
| 61VW | 00681 | Vertical/White | | 1 | 4 | 6.2743 | 7.521 | 1.6703 | 0.005 | 5.561 |
| 60HC | 00686 | Horizontal/Clear | | 1 | 4 | 4.1925 | 8.361 | 1.6703 | 0.005 | - |
| 60HW | 00684 | Horizontal/white | | 1 | 4 | 4.1925 | 8.361 | 1.6703 | 0.005 | - |
| 61HC | 00687 | Horizontal/Clear | | 1 | 4 | 4.1925 | 8.361 | 1.6703 | 0.005 | 4.250 |
| 61HW | 00685 | Horizontal/white | | 1 | 4 | 4.1925 | 8.361 | 1.6703 | 0.005 | 4.250 |



WEATHERPROOF-IN-USE

IN AND OUT COVER includes...

Low profile cover, (1) standard duplex and (1) standard GFCI face plate, installation screws, and installed gaskets.

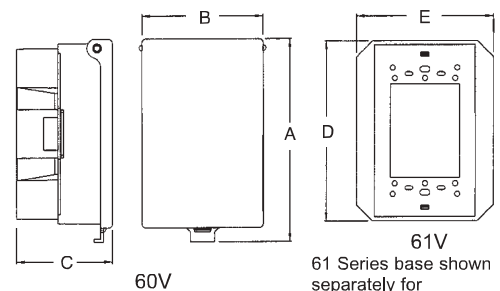

Installation Instructions

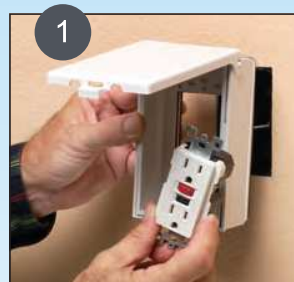

1 Feed device through opening (cover is removable for easier access).



2 Install wiring device per manufacturer's instructions, Local and National Electrical Codes using the pre-drilled holes in base.



3 Install plate and the installation is done!



IN for **GOOD LOOKS** and to stay bug free... (60VW shown)



OUT to **PLUG IN** for weatherproof-in-use! (61HW shown)



To close: Bow out sides of extended cover and push in.