



Conduit Nipples

Zinc die-cast.



CATALOG NUMBER	UPC/DCI/NAED MFG #018997	TRADE SIZE	UNIT PKG	STD PKG	DIM A	DIM B	DIM C
501	00501	1/2	100	1000	.585	.425	1.050
502	00502	3/4	50	500	.614	.514	1.310
503	00503	1	25	100	.654	.518	1.616
504	00504	1-1/4	10	100	.810	.578	1.978
505	00505	1-1/2	10	100	.835	.613	2.410
506	00506	2	10	50	.888	.676	2.945
507	00507	2-1/2	10	30	1.200	.876	3.555
508	00508	3	10	10	1.375	1.008	4.390
509	00509	3-1/2	10	10	1.375	1.008	4.925
510	00510	4	5	5	1.375	1.011	5.420
511†	00511	5	1	1	1.700	1.232	5.812
512†	00512	6	1	1	1.500	1.500	7.000

† Malleable.



E60812 LR49636

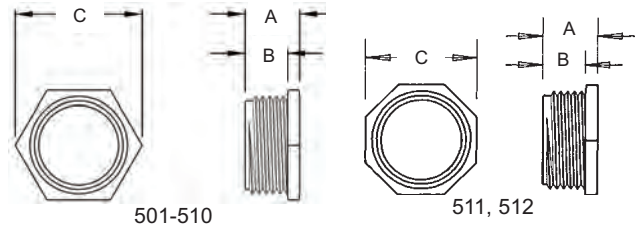

Conduit Nipples

Non-metallic.



CATALOG NUMBER	UPC/DCI/NAED MFG #018997	TRADE SIZE	UNIT PKG	STD PKG	DIM A	DIM B	DIM C
NM501	54501	1/2	100	1000	.754	.654	1.047
NM501EL	54584	1/2	100	1000	1.884	1.784	.946
NM502	54502	3/4	50	500	.779	.534	1.300
NM503	54503	1	25	100	.900	.575	1.592
NM504	54504	1-1/4	10	100	.900	.575	2.415
NM505	54505	1-1/2	10	100	.912	.662	2.623
NM506	54506	2	10	50	.975	.570	3.096



E60812 LR49636

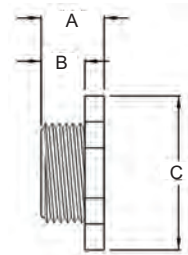

Rigid • IMC Fittings