



## Steel Sealing Locknut

With PVC molded seal.



| CATALOG NUMBER | UPC/DCI/NAED MFG #018997 | TRADE SIZE | STD PKG | DIM A | DIM B |
|----------------|--------------------------|------------|---------|-------|-------|
| SL50           | 13500                    | 1/2        | 50      | 1.125 | .230  |
| SL75           | 13750                    | 3/4        | 50      | 1.375 | .240  |
| SL100          | 13100                    | 1          | 25      | 1.715 | .260  |
| SL125          | 13125                    | 1-1/4      | 25      | 2.065 | .300  |
| SL150          | 13150                    | 1-1/2      | 25      | 2.375 | .300  |
| SL200          | 13200                    | 2          | 25      | 2.885 | .350  |
| SL250          | 13250                    | 2-1/2      | 10      | 3.450 | .350  |
| SL300          | 13300                    | 3          | 10      | 4.125 | .350  |
| SL350          | 13350                    | 3-1/2      | 10      | 4.675 | .375  |
| SL400          | 13400                    | 4          | 10      | 5.225 | .375  |
| SL500          | 13501                    | 5          | 10      | 6.487 | .550  |
| SL600          | 13600                    | 6          | 10      | 7.830 | .550  |



E60812 LR49636

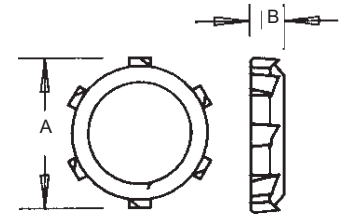

## Die-Cast Locknuts

Cast thread. Zinc die-cast.



| CATALOG NUMBER | UPC/DCI/NAED MFG #018997 | TRADE SIZE | UNIT PKG | STD PKG | DIM A | DIM B |
|----------------|--------------------------|------------|----------|---------|-------|-------|
| DLN1           | 43510                    | 1/2        | 200      | 2000    | 1.100 | .160  |
| DLN2           | 43520                    | 3/4        | 100      | 1000    | 1.387 | .160  |
| DLN3           | 43530                    | 1          | 100      | 500     | 1.685 | .190  |
| DLN4           | 43540                    | 1-1/4      | 50       | 250     | 2.115 | .190  |
| DLN5           | 43450                    | 1-1/2      | 50       | 250     | 2.370 | .190  |
| DLN6           | 43560                    | 2          | 25       | 250     | 2.885 | .190  |
| DLN7           | 43570                    | 2-1/2      | 60       | 60      | 3.450 | .250  |
| DLN8           | 43580                    | 3          | 50       | 50      | 4.190 | .250  |
| DLN9           | 43590                    | 3-1/2      | 50       | 50      | 4.700 | .250  |
| DLN10          | 43511                    | 4          | 30       | 30      | 5.300 | .250  |



E60812 LR49636

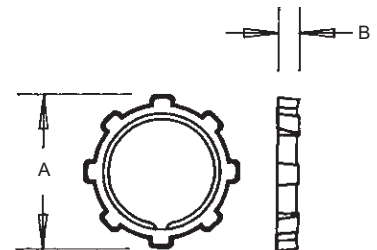

Rigid • IMC Fittings