



## Reducing Washers

Plated steel.



**Note:** A bonding jumper is recommended when using reducing washers to provide a reliable grounding/bonding path.

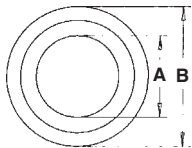

CATALOG NUMBER	UPC/DCI/NAED MFG #01 8997	SIZE	UNIT PKG	STD PKG	DIM A	DIM B	DIM C
RW1	95100	3/4 x 1/2	250	1000	.870	1.420	.035
RW2	95200	1 x 1/2	100	400	.870	1.710	.035
RW3	95300	1 x 3/4	100	400	1.060	1.710	.035
RW4	95400	1-1/4 x 1/2	200	200	.870	2.080	.035
RW5	95500	1-1/4 x 3/4	200	200	1.060	2.080	.035
RW6	95600	1-1/4 x 1	200	200	1.380	2.080	.035
RW7	95700	1-1/2 x 1/2	100	100	.870	2.635	.035
RW8	95800	1-1/2 x 3/4	100	100	1.060	2.635	.035
RW9	95900	1-1/2 x 1	100	100	1.335	2.635	.035
RW10	95101	1-1/2 x 1-1/4	100	100	1.690	2.635	.035
RW11	95110	2 x 1/2	50	50	.870	3.265	.035
RW12	95120	2 x 3/4	50	50	1.060	3.265	.035
RW13	95130	2 x 1	50	50	1.335	3.265	.035
RW14	95140	2 x 1-1/4	50	50	1.690	3.265	.035
RW15	95150	2 x 1-1/2	50	50	1.935	3.265	.035
RW16	95160	2-1/2 x 1/2	50	50	.870	3.265	.035
RW17	95170	2-1/2 x 3/4	50	50	1.060	3.265	.035
RW18	95180	2-1/2 x 1	50	50	1.370	3.265	.035
RW19	95190	2-1/2 x 1-1/4	50	50	1.750	3.265	.035
RW20	95201	2-1/2 x 1-1/2	50	50	1.935	3.265	.035
RW21	95210	2-1/2 x 2	50	50	2.425	3.265	.035
RW22	95220	3 x 1/2	25	25	.870	4.490	.040
RW23	95230	3 x 3/4	25	25	1.060	4.490	.040
RW24	95240	3 x 1	25	25	1.360	4.490	.045
RW25	95250	3 x 1-1/4	25	25	1.750	4.490	.040
RW26	95260	3 x 1-1/2	25	25	1.935	4.490	.040
RW27	95270	3 x 2	25	25	2.425	4.490	.040
RW28	95280	3 x 2-1/2	25	25	2.940	4.490	.040
RW29	95290	3-1/2 x 1/2	10	10	.870	5.000	.060
RW30	95301	3-1/2 x 3/4	10	10	1.060	5.000	.060
RW31	95310	3-1/2 x 1	10	10	1.360	5.000	.060
RW32	95320	3-1/2 x 1-1/4	10	10	1.750	5.000	.060
RW33	95330	3-1/2 x 1-1/2	10	10	1.935	5.000	.060
RW34	95340	3-1/2 x 2	10	10	2.425	5.000	.060
RW35	95350	3-1/2 x 2-1/2	10	10	2.920	5.000	.060
RW36	95360	3-1/2 x 3	10	10	3.560	5.000	.060
RW37	95370	4 x 1/2	10	10	.870	5.500	.065
RW38	95380	4 x 3/4	10	10	1.060	5.500	.065
RW39	95390	4 x 1	10	10	1.360	5.500	.065
RW40	95401	4 x 1-1/4	10	10	1.715	5.500	.065
RW41	95410	4 x 1-1/2	10	10	1.970	5.500	.065
RW42	95420	4 x 2	10	10	2.435	5.500	.065
RW43	95430	4 x 2-1/2	10	10	2.920	5.500	.065
RW44	95440	4 x 3	10	10	3.560	5.500	.065
RW45	95450	4 x 3-1/2	10	10	4.050	5.500	.065