



Full Product Options Shown on Reverse Side

GB SERIES INDUSTRIAL SPECIFICATION GRADE Set Screw, Threaded and Threadless Insulated Grounding Bushings With and Without Optional Ground Lug

Furnished with 3 Pre-Drilled Holes and Set Screws,
Unique Design Allows Ease of Installation and Orientation of Set Screw & Ground Lugs

Solid Steel with Hex Nut Design Permits Industrial Grade Torque without Damage to Pipe

Solid Machined Steel Option of Zinc Plated or Galvanized Plated

Superior Life & Performance Over Zinc Die Cast Products

Furnished with UL Component Temperature Rated 150°C Insulated Throat

Available with Option of Aluminum (Standard) Ground Lug or Copper Ground Lug



SPEC-grade

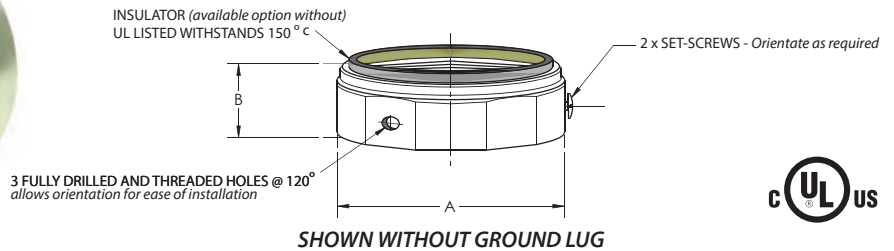
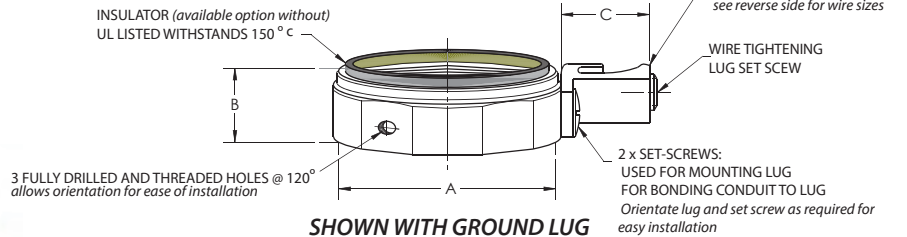
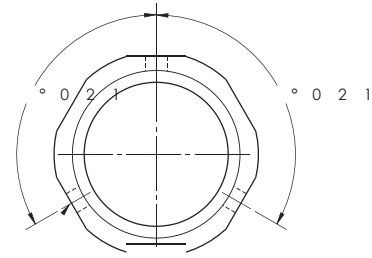

Galvanized Plating Available

Mechanically Galvanized Plating Equivalent To ASTM A-153

Hot-Dip Performance Criteria in Harsh Environments such as Below Grade Work

Superior Plated Product, Will Not Flake Off When Installed

GB Product Series WITH Grounding Lugs					GB Product Series WITHOUT Grounding Lug			
Product Series	TRADE SIZE	A Outside Diameter "	B Overall Length "	C Length of Lug "	Product Series	TRADE SIZE	A Outside Diameter "	B Overall Length "
GB 50BGL	1/2"	1.06	.63	.75	GB 50B	1/2"	1.06	.63
GB 75BGL	3/4"	1.22	.63	.75	GB 75B	3/4"	1.22	.63
GB 100BGL	1"	1.50	.75	.75	GB100B	1"	1.50	.75
GB 125BGL	1-1/4"	1.88	.78	.75	GB125B	1-1/4"	1.88	.78
GB 150BGL	1-1/2"	2.16	.78	.75	GB150B	1-1/2"	2.16	.78
GB 200BGL	2"	2.16	.78	.75	GB 200B	2"	2.16	.78
GB 250BGL**	2-1/2"	3.21	1.05	1.10	GB 250B**	2-1/2"	3.21	1.05
GB 300BGL**	3"	3.96	1.08	1.10	GB 300B**	3"	3.96	1.08
GB 350BGL**	3-1/2"	4.47	1.08	1.10	GB 350B**	3-1/2"	4.47	1.08
GB 400BGL**	4"	5.15	1.18	1.70	GB 400B**	4"	5.15	1.18

Full Product Series with Available Options Shown on Reverse Side

** 2 1/2" and larger are malleable iron construction