

FEATURES & SPECIFICATIONS

INTENDED USE — The MS8 is ideal for low to medium mounting heights where energy efficiency and a shielded or an open optical system is required for high light levels and excellent color. The enhanced performance of the MS8 provides improved vertical and horizontal illumination in aisle or warehouse applications. The MS8 is ideal for retail, warehouse, manufacturing or any application where a high lumen package in a compact fixture design is required.

Certain chemicals that may exist in end-user locations release airborne contaminants that can impact the integrity and safety of key fixture components. Please refer to the environmental compatibility chart located in the Product Selection Guide and/or the company website to ensure that these chemical interactions are considered when selecting fixtures. For additional information please consult an authorized factory representative. Certain airborne contaminants can diminish integrity of acrylic. [Click here for Acrylic Environmental Compatibility table for suitable uses.](#)

CONSTRUCTION — Clean and unassuming appearance with shielding provides a decorative approach that provides a powerful lighting package with high light levels.

Channel and louvers are formed from cold-rolled, 20-gauge steel. Fixture is asbestos-free. Compact sockets feature rotating collars and enclosed contacts. End caps include knockouts for through wiring and fixture attachment in row mounting applications.

Designed for simple installation and servicing, louver assembly hinges remain attached and hinge down to provide easy access into the optical system. Convenient access plate is located on the back of the channel for easy access to the wiring compartment.

Finish: High-gloss, baked white enamel finish. Five-stage iron-phosphate pretreatment ensures superior paint adhesion and rust resistance.

OPTICS — Available to meet individual lighting application requirements with variety of optical systems and lamp configurations. The Narrow Distribution (ND) includes a Miro4™ parabolic reflector system to provide high vertical and good horizontal illumination. Ideal for aisle or rack lighting. The Wide Distribution (WD) is ideal for general area lighting at higher mounting heights or where widespread distribution is preferred. Both distributions are available with white straight blade louver for additional shielding and brightness control. Optional uplight component softens ceiling appearance and reduces the "cavern effect".

ELECTRICAL — Thermally protected, resetting, Class P, HPF, non-PCB, UL listed and CSA certified. A+ sound rated electronic ballast. AWN, TFN or THHN wire used throughout, rated for required temperatures.

INSTALLATION — A variety of mounting arrangements are available including tong hangers, aircraft cables and stems. Suitable for mounting in continuous row or individual mounting. End caps include knockouts for through wiring and fixture attachment in row mounting applications.

LISTINGS — UL listed. CSA optional; (consult factory). UL listed 25°C ambient temperatures.

WARRANTY — 1-year limited warranty. Complete warranty terms located at

www.acuitybrands.com/CustomerResources/Terms_and_conditions.aspx

Actual performance may differ as a result of end-user environment and application.

Note: Specifications subject to change without notice.

Catalog Number
Notes
Type

MS8

T8 Direct Louver
4' or 8' Lengths
2, 3, or 4 Lamps



Specifications

Length:	48 (121.9)
	96 (243.8)
Width:	9-3/4 (24.8)
Depth:	4-1/4 (10.8)
Weight:	27.8 lbs (12.6 kg)

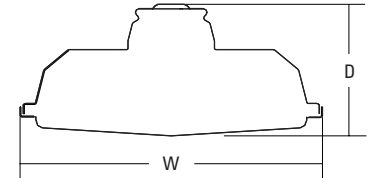

All dimensions are inches (centimeters) unless otherwise indicated.

ORDERING INFORMATION

Lead times will vary depending on options selected. Consult with your sales representative.

Example: MS8 3 32 SBL WD MVOLT 1/3 GEB10IS

Series	Number of lamps	32	Lamp type	Configuration	Distribution	Voltage	Ballast	Options
MS8 10% uplight	2	32	32W T8 (48")	(blank) No louver	ND Narrow	120	GEB10IS T8 instant start electronic ballast, <10% THD	1/3 One 3-lamp ballast
MS8ST Solid top	3			SBL White straight blade louver assembly	WD Wide	277		1/4 One 4-lamp ballast
For tandem double-length unit, add prefix T. Example: TMS8	4'					347		GLR Internal fast-blow fuse ³
	Not included					MVOLT ²	GEB10PS T8 program rapid start electronic ballast, <10% THD	MSI Occupancy sensor pre-wired ³
								CSA Listed and labeled to comply to Canadian standards
								NOM Listed and labeled to comply with Mexican standards
								BDP Ballast disconnect ⁴
								EL55 Emergency battery pack, nominal 390 - 700 lumens ⁵
								EL65 Emergency battery pack, nominal 725 - 1325 lumens ⁵

Accessories: Order as separate catalog number.

MSHBAC_	Adjustable aircraft cable system (specify 36, 72 or 120 inches) ⁶
MSHBACF_	Adjustable aircraft cable system with power feed (specify length as 36, 72 or 120 inches) (three-wire cable) ⁶
MSHBAC2F_	Adjustable aircraft cable system with power feed (four-wire cable) (specify length as 36, 72 or 120 inches) ⁶
SQ_	Swivel-stem hanger (specify lengths in 2" increments)
HC36	Chain hangers (1 pair, 36" long).
THMS5HB	Tong hangers.
WGMS8Z	4' wire guard, zinc coated

Notes

- 1 Not available with MS8ST.
- 2 MVOLT 120-277 only.
- 3 Specify voltage.
- 4 Meets codes that require in fixture disconnect.
- 5 Specify voltage, 120 or 277 only.
- 6 One cable per package.

MS8 T8 Direct Louver

MOUNTING DATA

For unit or row installation, surface or stem mounting.

Unit installation — Minimum of two hangers required.

Row installation — One hanger per channel plus one per row required.

Hanging devices illustrated below.

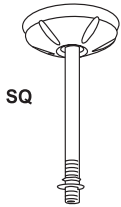
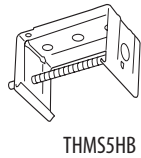

DIMENSIONS

All dimensions are inches (centimeters).

3-Lamp

A = 7/8 (2.2) KO

B = 3/4 (1.9) KO

C = 2-3/8 (6.0)

D = 1-1/4 (3.2)

E = 2-3/8 (6.0)

F = 1-3/8 (3.5)

4-Lamp

A = 7/8 (2.2) KO

B = 3/4 (1.9) KO

C = 2-3/8 (6.0)

D = 1-1/4 (3.2)

E = 2-3/8 (6.0)

F = 1-3/8 (3.5)

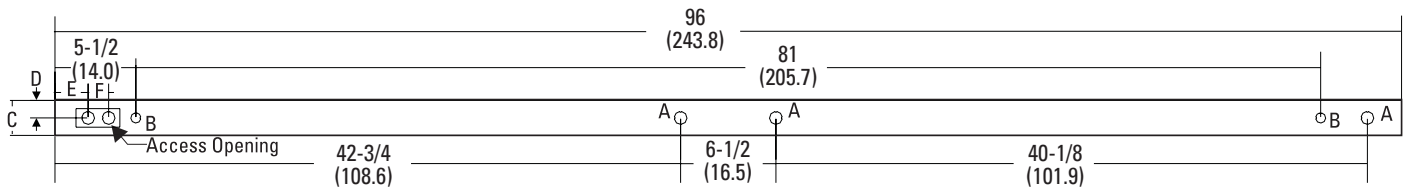
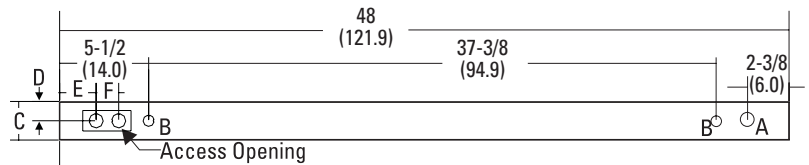
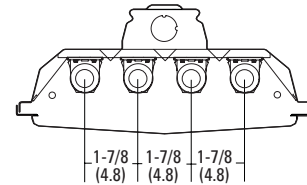
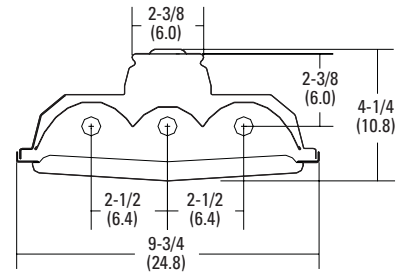

PHOTOMETRICS

See www.lithonia.com.