

Catalog Number
Notes
Type

FEATURES & SPECIFICATIONS

INTENDED USE — Intended for low to medium mounting heights in demanding applications including hose-down and food processing areas requiring ease of cleanability, compliance to FDA/USDA requirements and NSF splash-zone certification. Applications include meat/poultry/food/beverage processing, cosmetics, pharmaceuticals and other non-hazardous environments including carwash applications. **Certain airborne contaminants can diminish integrity of acrylic.** [Click here for Acrylic Environmental Compatibility table for suitable uses.](#)

CONSTRUCTION — Totally enclosed fixture features a tubular acrylic, high-impact lens surrounding an aluminum channel. Stainless steel end caps feature silicone o-ring closed cell gaskets.

Finish: Aluminum channel is finished with a high-gloss, baked white polymeric powder. Finish meets FDA CFR 21 175.300 for resinous and polymeric coatings.

OPTICS — High-impact, clear DR® acrylic lens; .125" nominal thickness.

ELECTRICAL — Thermally protected, resetting, Class P, HPF, A+ sound rated electronic ballast. AWM TFM or THHN wire used throughout, rated for required temperatures.

INSTALLATION — Includes stainless steel aircraft cable (7" leads) and s-hooks for suspended mounting. Supplied with a 5' power cord.

LISTINGS — 120V, 277V and MVOLT are UL Listed and CUL Listed for wet locations, maximum 40°C ambient temperature (standard). 347V is UL Listed to Canadian safety standards (see Options). IP65 rated for protection against the ingress of water and contaminants. NSF International certified splash-zone and meets FDA/USDA guidelines (standard).

WARRANTY — 1-year limited warranty. Complete warranty terms located at www.acuitybrands.com/CustomerResources/Terms_and_conditions.aspx

Note: Actual performance may differ as a result of end-user environment and application.

Specifications subject to change without notice.

TOUGH TASK
SEALED • GASKETED LIGHTING

High-Pressure, Hose-Down Fluorescent Luminaire



EFT

4' and 8' Length
2 Lamps

Specifications

	EFT 4'	EFT 8'
Length:	50 (127.0)	98 (248.9)
Width:	7-1/4 (18.4)	7-1/4 (18.4)
Depth:	6-1/2 (16.5)	6-1/2 (16.5)

All dimensions are inches (centimeters) unless otherwise indicated.

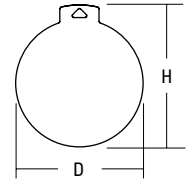

ORDERING INFORMATION

Lead times will vary depending on options selected. Consult with your sales representative.

Example: EFT 2 32 MVOLT GEB10IS

Series	Number of Lamps	Wattage	Voltage	Ballast	Options
EFT	2	32	120	GEB10IS	Shipped installed in fixture
TEFT ¹	Not included.	96T8HO 86W T8 380mA (96")	277	T8 instant-start electronic ballast, <10% THD	EL14DW Emergency lighting wet location, 1400 lumens
		54T5HO 54W T5 (46")	347	GEB10PS90 T5HO rapid-start electronic ballast, <10% THD	GLR Internal fast-blow fusing ²
		28T5 28W T5 (46")	MVOLT	GEB10PS Electronic ballast, <10% THD, programmed start	CS88 Brad Harrison 16/3 cord and plug set, 5'
			HVOLT		CSA Listed and labeled to comply with Canadian Standards (347 only)

Notes

- Not available with 96T8HO.
- Must specify voltage.

EFT Enclosed High-Pressure, Hose-Down

DIMENSIONS

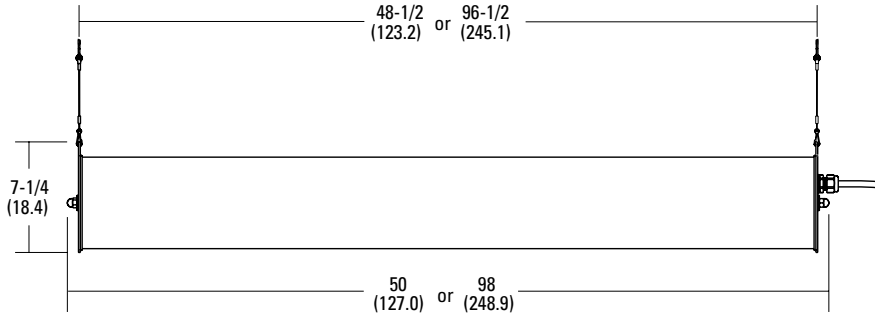

PHOTOMETRICS

See www.lithonia.com.