

S4-J



Four pole, two level, logic wiring
Integrated clip and marking label

10 A 250 V

**Socket for MRC, 14-Pin Plug-In Relay Types
C4-A40, C4-X20, C4-T31, C4-R30**

- DIN rail or panel mountable
- Removable label
- EN/DIN and sequential numbering

According to EN 60947

Wiring Diagram

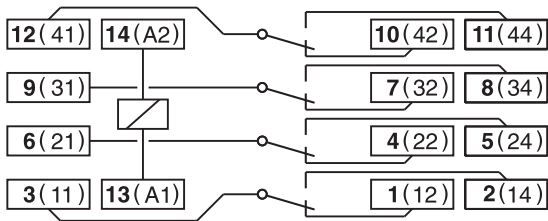

Dimensions - mm

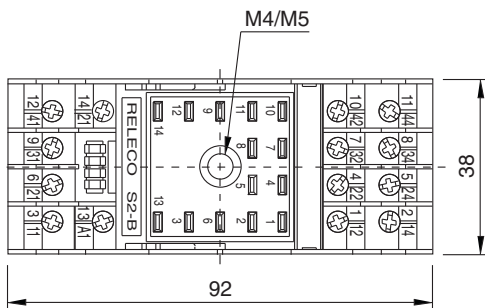
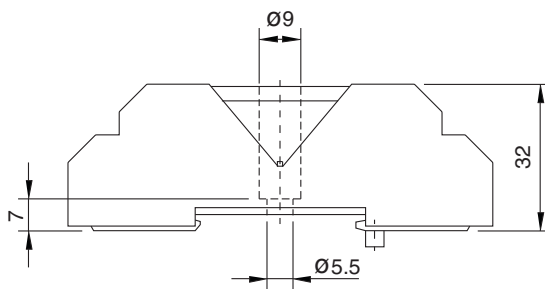

Specifications

Nominal Load: 10 A/250 V

Insulation:

Dielectric strength, 1 minute	
Between contacts and coil	2.5 KV
Between all terminals and rail DIN	2.5 KV
Between adjacent poles	2.5 KV

Wire In-Lets Capacity:

Solid wire	4 mm ² or 2 x 2.25 mm ²
Multi-core	24-14 AWG
Ferrule tip terminals	4 mm ²
Max. screw torque	1.2 Nm
Screw dimensions	M3, Pozi
Integrated hold-down clip	
Removable marking label	

