

Splice Plates - Ladder Cable Tray

Enduro offers a full line of fiberglass splice plates designed to provide a structural transition between straight sections and fittings. Enduro splice plates and hardware are sold separately and are not provided as standard with straight sections or fittings due to the many hardware options. All plates have $\frac{7}{16}$ " pre-drilled bolt holes.

NEMA FG-1

Please refer to NEMA FG-1 regarding proper tray installation as it pertains to support and splice plate locations for straight sections and fittings. Refer to page 11 for recommended support locations. **NEMA**

Ladder Cable Tray Splice Plate Part Numbers

TYPE - (H)(Δ) - (D)

Example: **ESP - 6C - 180**

Type

ESP = Straight
EEP = Expansion
EVS = Vertical
EHS = Horizontal

Side Rail Height

3 = 3" (75mm)*
4 = 4" (100mm)*
6 = 6" (150mm)*
8 = 8" (200mm)*
10 = 10" (250mm)*

Material

C = Polyester
V = Vinyl Ester
SS = Stainless Steel
S = Halogen-Free

Degree

180 = Straight, Expansion
90 = 90°
45 = 45°
30 = 30°
22.5 = 22.5°
HA = Horiz. Adjustable**
VA = Vert. Adjustable**

* (mm) value is nominal. ** For Horiz. and Vert. Adjustable part number use "ESP" for Type, example: ESP-6C-HA. Expansion plates have 1" slotted holes allowing 5/8" total contraction and expansion. Refer to thermal contraction table on page 6 for maximum spacing between expansion joints. Side rail height of 3" and 4" requires 4 bolt sets per plate. Side rail height of 6" and 8" requires 8 bolt sets per plate. Side rail height of 10" requires 12 bolt sets per plate. For 6" and 8" channel heavy duty splice plates, see page 24.

Splice Plate and Hardware Options

Tray Resin	Splice Plate Material				Hardware Material Sets			
	Polyester	Vinyl Ester	Halogen-Free Polyester	316 Stainless Steel	316 Stainless Steel	Monel	Silicon Bronze	Isoplast
Polyester	Standard	Optional		Optional	Standard	Optional	Optional	Optional
Vinyl Ester		Standard		Optional	Standard	Optional	Optional	Optional
Halogen-Free Polyester		Optional	Optional	Standard	Standard	Optional	Optional	Optional
Halogen-Free Vinyl Ester				Standard	Standard	Optional	Optional	Optional
Halogen-Free Low Smoke Plus				Standard	Standard	Optional	Optional	Optional
Conductive				Standard	Standard	Optional	Optional	Optional

Hardware

Type	Set Includes	Size	For Use With Tray Types	Part No.
316 Stainless Steel Bolt Set	Bolt, nut	$\frac{3}{8}$ "-16 x 1"	For S.S. splice plates (except 10" Channel)	505166SS
316 Stainless Steel Bolt Set	Bolt, nut	$\frac{3}{8}$ "-16 x 1 $\frac{1}{4}$ "	All tray types (except 10" Channel)	505167SS*
316 Stainless Steel Bolt Set	Bolt, nut, 2 washers	$\frac{3}{8}$ "-16 x 1 $\frac{1}{2}$ "	For use with VA splice place	505168SS
Monel Bolt Set	Bolt, nut	$\frac{3}{8}$ "-16 x 1 $\frac{1}{4}$ "	All tray types (except 10" Channel)	606167M
FRP/GRP Studs & Nuts	Stud and 2 nuts	$\frac{3}{8}$ "-16 x 2"	ELL3, ELL4, ETL6, EHZ6	707166F
FRP/GRP Studs & Nuts	Stud and 2 nuts	$\frac{3}{8}$ "-16 x 2 $\frac{1}{2}$ "	EHL6, EHL8, EHV6	707167F
Silicon Bronze Bolt Set	Bolt, nut	$\frac{3}{8}$ "-16 x 1 $\frac{1}{4}$ "	All tray types (except 10" Channel)	808167SB

* Standard hardware set; NOTE: For monel and silicon bronze, please contact us for lead times. Also available in additional sizes. For 10" channel, please contact us for hardware; It is recommended that expansion splice plates and 1 $\frac{1}{2}$ " long assembly fasteners be used when connecting mitered fittings to molded fittings or straight lengths.

Fastener Torque

Inch: GRD. 2 UNC		Metric: Class 5.8	
Size	Ft-Lbs	Size	N-m
1/4 - 20	4-6	M8 x 1.25	14-16
3/8 - 16	17-23	M10 x 1.5	26-33
1/2 - 13	42-56	M12 x 1.78	45-58

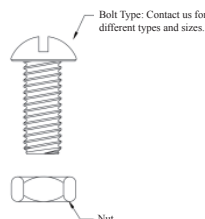

Ladder Cable Tray - Splice Plates

Typical Dimensions for FRP/GRP Splice Plates

Typical Dimensions Inches (mm)			
Channel Depth Inches (mm)	A	B	C
3 (76)	1 3/4 (44)	1 (25)	-0-
4 (102)	2 (51)	1 (25)	-0-
6 (152)	4 3/8 (117)	1 (25)	2 5/8 (67)
8 (203)	6 (152)	1 1/16 (43)	2 5/8 (67)

Typical Dimensions for Stainless Splice Plates

Typical Dimensions Inches (mm)			
Channel Depth Inches (mm)	A	B	C
3 (76)	1 1/4 (32)	5/8 (16)	-0-
4 (102)	1 1/4 (32)	5/8 (16)	-0-
6 (152)	4 1/8 (105)	3/4 (19)	2 5/8 (67)
8 (203)	4 1/8 (105)	3/4 (19)	2 5/8 (67)

Straight Section

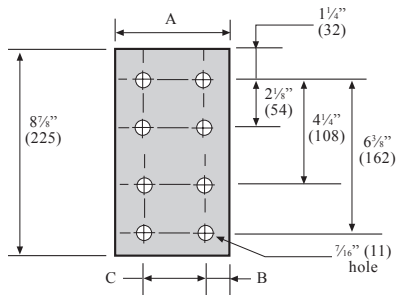

Expansion

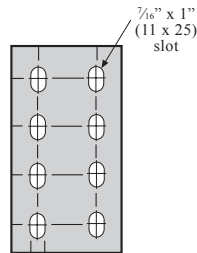

90° Vertical

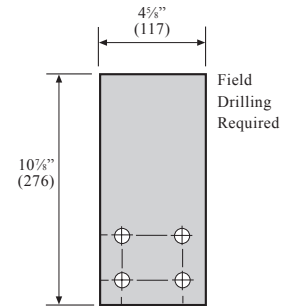

45° Vertical

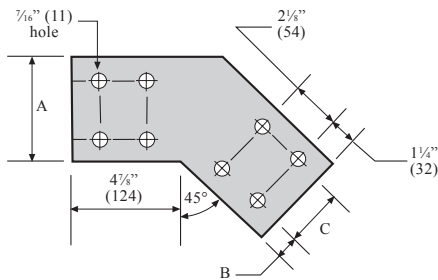

30° Vertical

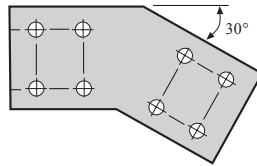

22.5° Vertical

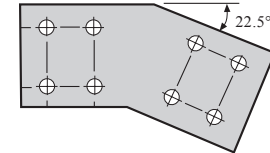

Adjustable Vertical

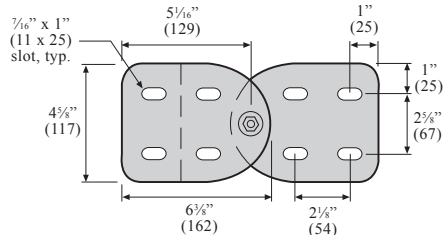

For adjustable vertical plate hardware, use catalog number 505168SS. For travel dimensions, contact us.

90° Horizontal

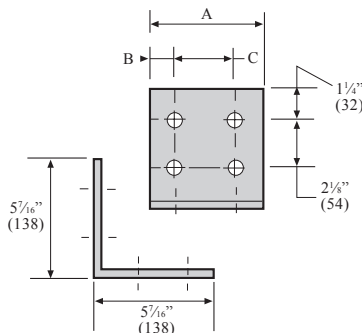

45° Horizontal

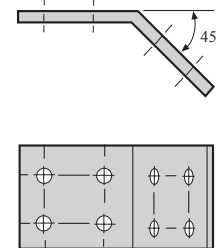

Splice Plates - Ladder Cable Tray

30° Horizontal

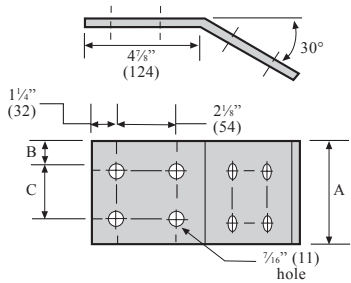

22.5° Horizontal

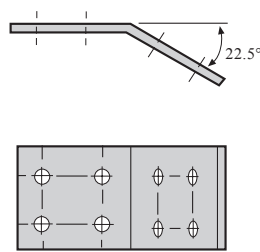

Adjustable Horizontal

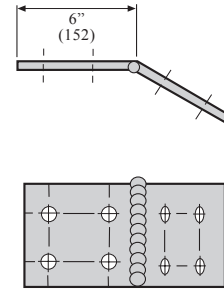

Heavy Duty Splice Plates

Part No. Key*

ESP-(H) HP-180 Splice Plate

Part No. Key*

EEP-(H) HP-180 Splice Plate

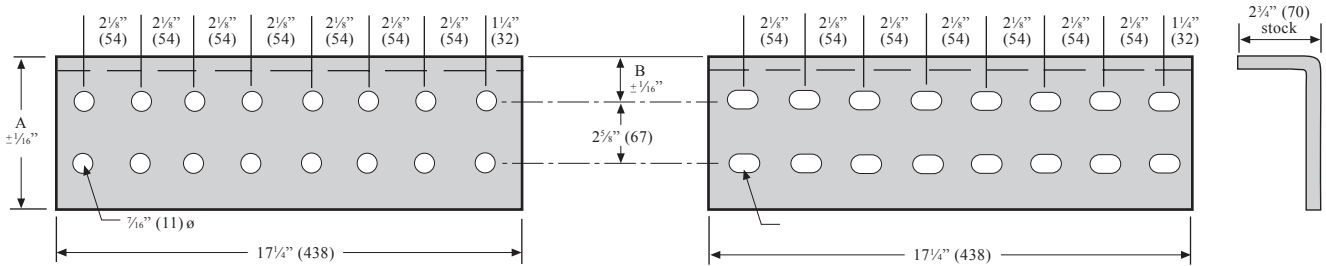

Side Rail Height Inches (mm)	A Inches (mm)	B Inches (mm)
4 (102)	3 (76)	1 3/8 (35)
6 (152)	5 (127)	1 3/8 (35)
8 (204)	6 3/8 (162)	2 1/16 (52)

10" Channel Splice Plates

Part No.

ESP-10C-180 Splice Plate

Part No.

EEP-10C-180 Splice Plate

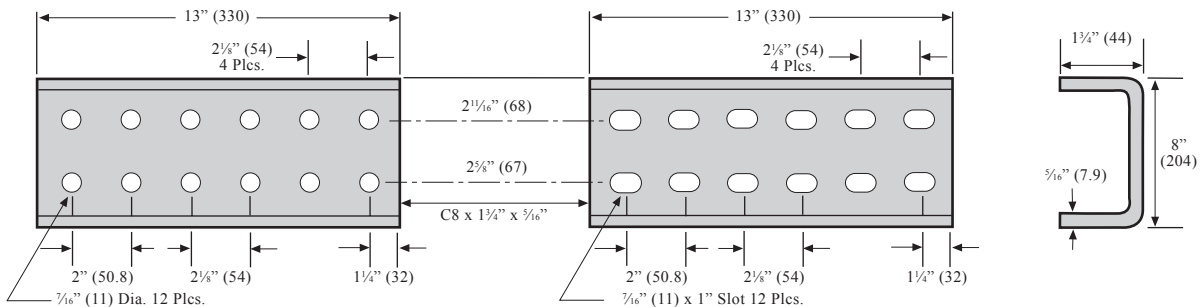

* In Part No. Key, parentheses () = insert corresponding option code; H = Side Rail Height - 4, 6, 8 (inches)